

SURVEY & REMONUMENTATION COMMISSION
 APR 11 1995

LAND CORNER RECORDATION CERTIFICATE
 Filing Requirement of Act 74, Mich. P.A. 1970

Approved by Menominee County
 Land Survey Remonumentation
 Four Corners Under Act 345 of

PA. of 1994 No. DEC 12 1994
Mr. David RLS
 ACTING Commissioner

For corners in MENOMINEE (County) Located In: Corner Code #

1. Public Land Survey	T <u>32N</u> R <u>27W</u>	H-10
	T _____ R _____	_____
	T _____ R _____	_____
	T _____ R _____	_____
2. Property Controlling in Section	S _____ T _____ R _____	_____
	S _____ T _____ R _____	_____
3. Miscellaneous Property in Sec.	S _____ T _____ R _____	_____
	S _____ T _____ R _____	_____

4. Lot No. _____, Recorded Plat _____

5. Private Claims _____

RECEIVED FOR RECORD
 94 DEC 27 AM 10:48
 PAGE # 188 BK 4
 BARBARA MORRISON
 REGISTER OF DEEDS
 MENOMINEE MI 49858
 Register of Deeds Stamp # File Number

A	B	C	D	E	F	G	H	I	J	K	L	M
2	6	5	4	3	2	1						
3												
4	7	8	9	10	11	12						
5												
6	18	17	16	15	14	13						
7												
8	19	20	21	22	23	24						
9												
10	30	29	28	27	26	25						
11												
12	31	32	33	34	35	36						
13												

I, William Lenca in a field survey on May 20, 1994, do hereby certify that under requirements of P.A. 74, Michigan P.A. of 1970, the corner points mentioned in lines 1 and 2 above were in conformance with regulations and rules therefore as required in the current manual of survey instructions of the United States Department of the Interior, Bureau of Land Management or by a decree of a Court of Law and/or that the corner points mentioned in lines 3, 4 and 5 above were in conformance with the rules of the Michigan Board of Land Surveyors or by a Decree of a Court of Law; established, re-established, monumented, re-monumented, recovered, found as expressed below:

NOTE: Not more than 4 corners, all in the same town and range, may be recorded on this certificate.

- A. Description of original monument and accessories and/or subsequent restoration:
- 1883: Plat of Survey by Orson Burlingame, surveyor, shows a subdivision of Section 27, T32N - R27W. No description is given for the corner monument.
 - 1975: L.C.R.C. No. 102 by George B. Wilson, RLS No. 17607, states that he dug up pavement with backhoe & found remains of old wood stake about 2.5' below pavement. Fits well with measurements of Orson Burlingame taken Oct-Nov 1883. Wilson set a 2" dia. Alum. Pipe/cap. TIES: c/l Hydrant - SE - 44.56'; NE Cor House - SW - 93.93'; NE Cor House - SW - 58.15'.
 - 1977: Certified Survey No. 100 by George B. Wilson, RLS No. 17607, shows a subdivision of Sections 27 and 34, T32N-R27W. No description for the corner monument is given.

B. Description of corner evidence found and/or method applied in restoring or reestablishing corner:

In a 1977 retracement survey of Orson Burlingame's 1883 survey, Wilson states that he found the remains of an old wood stake and set a 2" diameter aluminum pipe/cap in its location. We found a railroad spike at a location which matched Wilson's corner position based on measurements shown in Certified Survey No. 100. We dug down and found a 2" dia. aluminum pipe/3-1/4" aluminum cap approximately 2' below the surface. Wilson's measurements to Corners 1/2 mile North and South of this location match within a tenth of a foot with Burlingame's 1883 measurements. Wilson's measurement to the corner 1/2 mile East is 2.7 feet short of Burlingame's distance. Wilson's distance to the corner 1/2 mile West is 4.6 feet short of Burlingame's distance. We feel that the old wood stake was placed in the 1883 survey by Orson Burlingame, and is accepted as the center quarter of Section 27.

C. Description of monument for corner and accessories established to perpetuate locating the position of the corner:

Set 5/8" x 24" iron rod/3-1/4" dia. Alum. cap stamped for corner in Mon. Box over existing 2" dia. alum. pipe:

Set 5/8" x 24" Iron Rod/2" dia. cap marked WITNESS MARKER	S88°E	32.92 feet
c/l top of hydrant	S37°E	44.56 feet
NE Corner of House Foundation	S76°W	58.19 feet
SE Corner of House Foundation	N39°W	141.70 feet
Survey Sign Post	S88°E	33.2 feet

NOTE: All bearings are magnetic bearings. All distances are measured with steel tape. Distances to trees are to nail in side of tree.

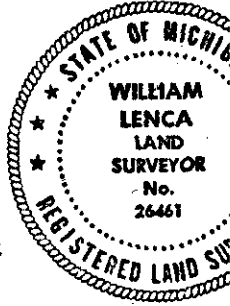

Signed by William Lenca Date Dec. 15, 1994
 Surveyor's Michigan License No. 26461