

**SURVEY & DOCUMENTATION**  
**APR 11 1995**  
**COMMISSION**

Approved by Menominee County  
 Land Survey Re-Commissioning  
 Four Corners Under Act 245 of  
 P.A. of 1990 on DEC 16 1994  
M. Davis RLS  
Acting

**LAND CORNER RECORDATION CERTIFICATE**  
 Filing Requirement of Act 74, Mich. P.A. 1970

For corners in MENOMINEE (County) Located In: \_\_\_\_\_ Corner Code # \_\_\_\_\_

1. Public Land Survey	T <u>32N</u> R <u>27W</u>	<u>H-11</u>
	T _____ R _____	_____
	T _____ R _____	_____
	T _____ R _____	_____
2. Property Controlling in Section	S _____ T _____ R _____	_____
	S _____ T _____ R _____	_____
3. Miscellaneous Property in Sec.	S _____ T _____ R _____	_____
	S _____ T _____ R _____	_____

RECEIVED FOR RECORD  
 94 DEC 27 AM 10:48  
 PAGE # 186-188 BK 4  
 BARBARA MORRISON  
 REGISTER OF DEEDS  
 MENOMINEE MI 54853  
 Register of Deeds Stamp & File Number

4. Lot No. \_\_\_\_\_, Recorded Plat \_\_\_\_\_  
 5. Private Claims \_\_\_\_\_

A	B	C	D	E	F	G	H	I	J	K	L	A
2	6	5	4	3	2	1						
3												
4	7	8	9	10	11	12						
5												
6	18	17	16	15	14	13						
7												
8	19	20	21	22	23	24						
9												
10	30	29	28	27	26	25						
11												
12	31	32	33	34	35	36						
13												

William Lenca May. 17 94  
 I, \_\_\_\_\_, in a field survey on \_\_\_\_\_, 19 \_\_\_\_\_, do hereby certify that under requirements of P.A. 74, Michigan P.A. of 1970, the corner points mentioned in lines 1 and 2 above were in conformance with regulations and rules therefore as required in the current manual of survey instructions of the United States Department of the Interior, Bureau of Land Management or by a decree of a Court of Law and/or that the corner points mentioned in lines 3, 4 and 5 above were in conformance with the rules of the Michigan Board of Land Surveyors or by a Decree of a Court of Law; established, re-established, monumented, re-monumented, recovered, found as expressed below:

**NOTE: Not more than 4 corners, all in the same town and range, may be recorded on this certificate.**

- A. Description of original monument and accessories and/or subsequent restoration:  
 1847 - Original Survey by James H. Mullett - B.T.'s - Tamarack, 8", N41°W, 14 lks; Tamarack, 12", N36°E, 14 lks. All original evidence for this corner has been destroyed by City Utilities and Street improvements.  
 1883 - 1884 - Plat of Surveys by Orson Burlingame, Surveyor, shows a section subdivision of Sections 27 and 34, T32N-R27W. The corner monument is not described and no witnesses are given, however the distance shown 1/2 mile West is 2712 feet, and 1/2 mile East is 2712 feet.  
 1975 - L.C.R.C No. 104 by George B. Wilson, RLS No. 17607 - See back.

B. Description of corner evidence found and/or method applied in restoring or reestablishing corner:  
 We found a 1/2" diameter Iron Pin with plastic cap marked RLS 17607 in location indicated by L.C.R.C. No. 104 shown on back. The measured distance from this corner position 1/2 mile West is 2711.88 feet, compared to Orson Burlingame's measurement of 2712 feet. The measured distance from this corner position 1/2 mile East is 2739.88 feet compared to Orson Burlingame's measurement of 2740 feet. Wilson states that he found a wood stake at the C1/4 corner of Section 27, believed to be Burlingame's corner. The measured distance from the corner position to this wood stake is 2667.09 feet compared to Burlingame's distance of 2667 feet. Since Burlingame stated that he had the original position, we accepted Wilson's 1/2" dia. iron pin as a careful and faithful perpetuation of the position of the original corner.

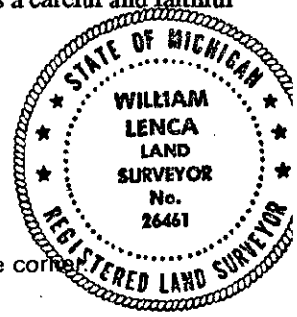

C. Description of monument for corner and accessories established to perpetuate locating the position of the corner:  
 Set 3-1/4" dia. Alum. stamped for corner on existing 1/2" dia. Iron in Monument Box.

SW Corner House Foundation	N60°E	115.35 feet
4" square concrete plat monument	S37°E	35.05 feet
NE Corner of House Foundation	S54°W	84.20 feet
5/8" x 24" Iron Rod/2" Alum. cap stamped "WITNESS MARKER"	N32°W	85.87 feet
Center of Manhole Cover	West	8.26 feet
Survey Sign Post	N02°E	50.0 feet

NOTE: All bearings are magnetic bearings. All distances are measured with steel tape. Distances to trees are to nail in side of tree.

Signed by William Lenca Date Nov. 18, 1994  
 Surveyor's Michigan License No. 26461