

SURVEY & REMONUMENTATION

OCT 26 1993

COMMISSION

LAND CORNER RECORDATION CERTIFICATE
Filing Requirement of Act 74, Mich. P.A. 1970

Approved by Menominee County
Land Survey Remonumentation
Peer Group Under Act 345 Of
P.A. of 1990 On OCT 6 1993
McDANIEL RLS
Chairman (ACTING)

For corners in

<u>MENOMINEE</u> (County)	Located In:	Corner Code #:
1. Public Land Survey	T <u>32N</u> R <u>27W</u>	<u>I-2</u>
	T _____ R _____	_____
	T _____ R _____	_____
	T _____ R _____	_____
2. Property Controlling in Section	S _____ T _____ R _____	_____
	S _____ T _____ R _____	_____
3. Miscellaneous Property in Sec.	S _____ T _____ R _____	_____
	S _____ T _____ R _____	_____

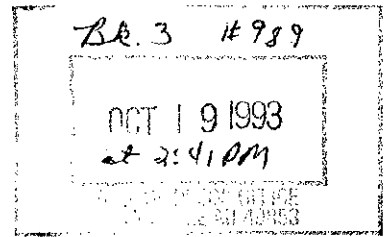

4. Lot No. _____, Recorded Plat _____
5. Private Claims _____

	A	B	C	D	E	F	G	H	I	J	K	L	M
2	6	5	4	3	2	1							
3													
4	7	8	9	10	11	12							
5													
6	18	17	16	15	14	13							
7													
8	19	20	21	22	23	24							
9													
10	30	29	28	27	26	25							
11													
12	31	32	33	34	35	36							
13													

I, William Lenca, in a field survey on August, 19 93, do hereby certify that under requirements of P.A. 74, Michigan P.A. of 1970, the corner points mentioned in lines 1 and 2 above were in conformance with regulations and rules therefore as required in the current manual of survey instructions of the United States Department of the Interior, Bureau of Land Management or by a decree of a Court of Law and/or that the corner points mentioned in lines 3, 4 and 5 above were in conformance with the rules of the Michigan Board of Land Surveyors or by a Decree of a Court of Law; established, re-established, monumented, re-monumented, recovered, found as expressed below:

NOTE: Not more than 4 corners, all in the same town and range, may be recorded on this certificate.

A. Description of original monument and accessories and/or subsequent restoration:

ORIGINAL B.T.'s:

- Beech, 8", N58°E, 5 lks
- Hemlock, 16", N33°W, 24 lks

Original Survey by James H. Mullett in 1848 - All original evidence for this corner has been destroyed by county road improvements.

B. Description of corner evidence found and/or method applied in restoring or reestablishing corner:

In a 1981 survey, George Wilson, RLS No. 17607, found a 1" diameter Iron Pipe used by Robert Olsen, RLS 751, and replaced it with a monument as described in part C. This corner appears to have been placed by single proportionate measurement, and is accepted as the best available evidence of the position of the original corner. This corner was previously recorded in book 2 on page 329 of Corner Records of Menominee County.

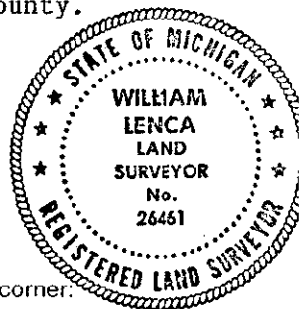

C. Description of monument for corner and accessories established to perpetuate locating the position of the corner:

Found $3\frac{1}{4}$ " dia. cap/3/4" dia. Aluminum Rod stamped for corner location:

7" dia. Jack Pine	- N62°E	55.26 feet
7" dia. Jack Pine	- S62°E	49.13 feet
NE Corner of Township Hall	- N83°W	90.98 feet
SE Corner of Township Hall	- S63°W	102.80 feet
5/8" x 24" Iron Rod/2" dia. Alum "WITNESS MARKER"	- N19°W	82.46 feet

NOTE: All bearings are magnetic bearings; distances measured with steel tape.

Signed by William Lenca Date Sept. 7, 1993
Surveyor's Michigan License No. 26461