

SURVEY & REMONUMENTATION

OCT 26 1993

COMMISSION

For corners in

MENOMINEE
(County)

Located In:

Corner Code #

- | | | |
|------------------------------------|---------------------------|------------|
| 1. Public Land Survey | T <u>32N</u> R <u>27W</u> | <u>I-3</u> |
| | T _____ R _____ | _____ |
| | T _____ R _____ | _____ |
| | T _____ R _____ | _____ |
| 2. Property Controlling in Section | S _____ T _____ R _____ | _____ |
| | S _____ T _____ R _____ | _____ |
| 3. Miscellaneous Property in Sec. | S _____ T _____ R _____ | _____ |
| | S _____ T _____ R _____ | _____ |

Approved by Menominee County
Land Survey Remonumentation
Peer Group Under Act 345 Of
P.A. Of 1990 On OCT 6 1993
McDermis RLS
Chairman (ACTING)

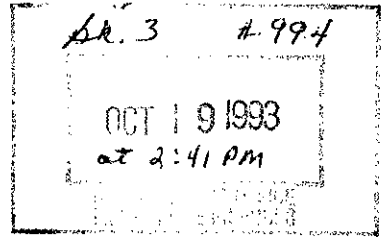

Register of Deeds Stamp & File Number

4. Lot No. _____, Recorded Plat _____
5. Private Claims _____

	A	B	C	D	E	F	G	H	I	J	K	L	M
2	6	5	4	3	2	1							
3									●				
4	7	8	9	10	11	12							
5													
6	18	17	16	15	14	13							
7													
8	19	20	21	22	23	24							
9													
10	30	29	28	27	26	25							
11													
12	31	32	33	34	35	36							
13													

I, William Lenca, in a field survey on August, 19 93, do hereby certify that under requirements of P.A. 74, Michigan P.A. of 1970, the corner points mentioned in lines 1 and 2 above were in conformance with regulations and rules therefore as required in the current manual of survey instructions of the United States Department of the Interior, Bureau of Land Management or by a decree of a Court of Law and/or that the corner points mentioned in lines 3, 4 and 5 above were in conformance with the rules of the Michigan Board of Land Surveyors or by a Decree of a Court of Law; established, re-established, monumented, re-monumented, recovered, found as expressed below:

NOTE: Not more than 4 corners, all in the same town and range, may be recorded on this certificate.

A. Description of original monument and accessories and/or subsequent restoration:

ORIGINAL B.T.'s:

- Tamarack, 10", N52°W, 11 lks
- Tamarack, 10", S25°E, 11 lks

Original Survey by James H. Mullett in 1848. All original evidence for this corner has been destroyed by Highway construction.

B. Description of corner evidence found and/or method applied in restoring or reestablishing corner:

A 1" square Deep-1 Magnet was set in the centerline of U.S. Highway 41 and Twin Creek Road in a 1976 survey by George B. Wilson, RLS No. 17607. This corner was subsequently perpetuated by Brian Taavola, RLS 21583, in a 1991 Highway re-construction project, and is accepted as the best available evidence of the position of the original corner.

Corner was recorded in Book 3 of Land Corner Records on page 915.

C. Description of monument for corner and accessories established to perpetuate locating the position of the corner:

1/2" dia. Copper Clad steel rod/Ident. cap in Monument Box:

- | | | |
|----------------------------|-------|-------------|
| 15" dia. Tamarack | N65°E | 126.70 feet |
| NW Corner House Foundation | S51°E | 179.76 feet |
| 4" dia. Tamarack | S64°W | 110.15 feet |
| 11" dia. Tamarack | N28°W | 157.23 feet |
| Steel Fence Post | West | 50.0 feet |

NOTE: All bearings are magnetic bearings; all distances are measured with steel tape; distances to trees are to nails in center of tree.

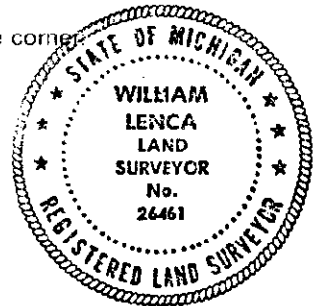

Signed by William Lenca Date Sept. 21, 1993

Surveyor's Michigan License No. 26461