

1993

LAND CORNER RECORDATION CERTIFICATE
Filing Requirement of Act 74, Mich. P.A. 1970

Approved by Menominee County
Land Survey Remonumentation
Peer Group Under Act 345 Of

P.A. of 1990 On 12/28 199 93

For corners in
MENOMINEE
(County)

Located In: _____ Corner Code # _____

1. Public Land Survey T 32N R 27W I-7
T R
T R
T R

2. Property Controlling in Section S T R
S T R

3. Miscellaneous S T R

Property in Sec. S T R

4. Lot No. _____, Recorded Plat _____

5. Private Claims _____

Mc Davis
Chairman

REGISTERED FOR RECORD
93 DEC 29 PM 3:52
PAGE # 11 1324
BARBARA MORRISON
REGISTER OF DEEDS
MENOMINEE MI 49808

Register of Deeds Stamp & File Number

I, WILLIAM LENCA, in a field survey on September 17 19 93, do hereby certify that under requirements of P.A. 74, Michigan P.A. of 1970, the corner points mentioned in lines 1 and 2 above were in conformance with regulations and rules therefore as required in the current manual of survey instructions of the United States Department of the Interior, Bureau of Land Management or by a decree of a Court of Law and/or that the corner points mentioned in lines 3, 4 and 5 above were in conformance with the rules of the Michigan Board of Land Surveyors or by a Decree of a Court of Law; established, re-established, monumented, re-monumented, recovered, found as expressed below:

NOTE: Not more than 4 corners, all in the same town and range, may be recorded on this certificate.

A. Description of original monument and accessories and/or subsequent restoration:
ORIGINAL B.T.'s: Cedar, 8", S69°E, 33 lks
Cedar, 6", N45°W, 16 lks

	A	B	C	D	E	F	G	H	I	J	K	L	M
1													
2	6	5	4	3	2	1							
3													
4	7	8	9	10	11	12							
5													
6	18	17	16	15	14	13							
7													
8	19	20	21	22	23	24							
9													
10	30	29	28	27	26	25							
11													
12	31	32	33	34	35	36							
13													

Original Survey by James H. Mullett in 1848. All original evidence for this corner has been destroyed county road improvements.

PERPETUATION: An old Chicago & Northwestern Railroad Survey Map dated 1877 shows this corner as being 930 feet East of the centerline of the Railroad Track Main Line. Georger B. Wilson, RLS No. 17607, re-established this corner in December of 1979 from the above railroad map in December of 1979, as recorded in LCRC No. 206, Book 1.

B. Description of corner evidence found and/or method applied in restoring or reestablishing corner:

Found a 1/2 inch diameter iron rod in a cast iron monument box set by George B. Wilson from an 1877 Railroad Survey mentioned above. For several years the centerline of U.S. Highway 41 (15 feet East of this position) was assumed to be the corner, however, occupation lines to the East and West of here did not fit properly. These occupations do fit with the position established from the old railroad survey. Since the Railroad Survey was made approximately 30 years after the original survey, we believe this position to be a careful and faithful perpetuation of the position of the original corner.

C. Description of monument for corner and accessories established to perpetuate locating the position of the corner:

Set 5/8" x 24" Iron Rod/3 1/4" dia. Alum. cap stamped for corner in Existing Monument Box:

Chisled Crosses in Concrete Culvert Headwalls as follows:
N50°E 72.75 feet
S32°E 92.88 feet
S45°W 36.98 feet
N36°W 38.80 feet

NOTE: All bearings are magnetic bearings; All distances are measured with steel tape
All distances to trees are to nails in side of tree.

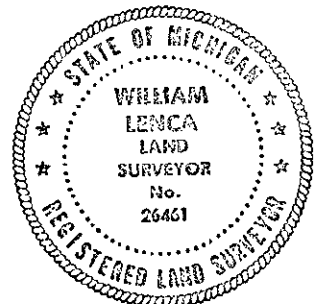

Signed by William Lenca Date December 20, 1993
Surveyor's Michigan License No. 26461