

**SURVEY &
REMONUMENTATION**

OCT 26 1993

LAND CORNER RECORDATION CERTIFICATE
Filing Requirement of Act 74, Mich. P.A. 1970

Approved by Menominee County
Land Survey Remonumentation
Peer Group Under Act 345 Of
P.A. of 1990 On OCT 6, 1993
Mr. Anzani RLS
Chairman (ACTING)

COMMISSION
For corners in

MENOMINEE
(County)

Located In:

Corner Code 44

- | | | |
|------------------------------------|---------------------------|------------|
| 1. Public Land Survey | T <u>32N</u> R <u>27W</u> | <u>M-2</u> |
| | T _____ R _____ | _____ |
| | T _____ R _____ | _____ |
| | T _____ R _____ | _____ |
| 2. Property Controlling in Section | S _____ T _____ R _____ | _____ |
| | S _____ T _____ R _____ | _____ |
| 3. Miscellaneous Property in Sec. | S _____ T _____ R _____ | _____ |
| | S _____ T _____ R _____ | _____ |

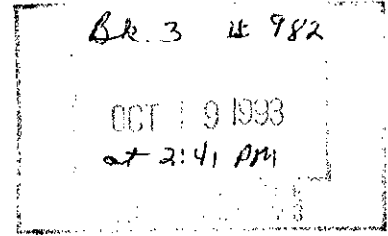

Register of Deeds Stamp & File Number

4. Lot No. _____, Recorded Plat _____
5. Private Claims _____

	A	B	C	D	E	F	G	H	I	J	K	L	M
2	6	5	4	3	2	1							
3													
4	7	8	9	10	11	12							
5													
6	18	17	16	15	14	13							
7													
8	19	20	21	22	23	24							
9													
10	30	29	28	27	26	25							
11													
12	31	32	33	34	35	36							
13													

I, William Lenca, in a field survey on August, 1993, do hereby certify that under requirements of P.A. 74, Michigan P.A. of 1970, the corner points mentioned in lines 1 and 2 above were in conformance with regulations and rules therefore as required in the current manual of survey instructions of the United States Department of the Interior, Bureau of Land Management or by a decree of a Court of Law and/or that the corner points mentioned in lines 3, 4 and 5 above were in conformance with the rules of the Michigan Board of Land Surveyors or by a Decree of a Court of Law; established, re-established, monumented, re-monumented, recovered, found as expressed below:

NOTE: Not more than 4 corners, all in the same town and range, may be recorded on this certificate.

A. Description of original monument and accessories and/or subsequent restoration:

ORIGINAL B.T.'s:

- Cedar, 12", S20°W, 40 lks
- Hemlock, 16", S44°W, 24 lks

Original Survey by James H. Mullett in 1848. All original evidence for this corner has been destroyed by county road improvements.

B. Description of corner evidence found and/or method applied in restoring or reestablishing corner:

Found 1/2" dia. Iron Pin set by George B. Wilson, RLS 17607, in a 1981 survey. The corner falls in the centerline of Range Line Road (North-South) and in line with an old fence line running West from this location. This corner has been used for control in several surveys, and is accepted as the best available evidence of the position of the original corner.

C. Description of monument for corner and accessories established to perpetuate locating the position of the corner:

Set 5/8" x 24" Iron Rod/3/4" dia. Aluminum cap stamped for corner:

- | | | |
|-------------------|-------|------------|
| 5" dia. Maple | N35°E | 95.24 feet |
| 5" dia. White Ash | S54°E | 39.28 feet |
| 3" dia. Maple | S57°W | 45.01 feet |
| 4" dia. White Ash | N43°W | 44.00 feet |
| Steel Fence Post | N89°W | 31.9 feet |

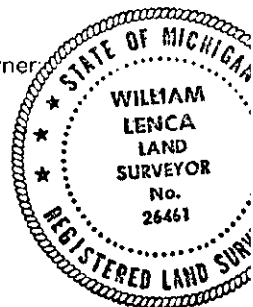

NOTE: All bearings are magnetic bearings; all distances are measured with steel tape; distances to trees are to nails in center of tree.

Signed by William Lenca Date Sept. 20, 1993
Surveyor's Michigan License No. 26461