

FEB 11 1998

SECTION

LAND CORNER RECORDATION CERTIFICATE
Filing Requirement of Act 74, Mich. P.A. 1970

Approved by Menominee County
Land Survey Remonumentation
Peer Group Under Act 245 CM
P.A. Of 1990 On 10/31 1992
William Lenca
Chairman

For corners in

MENOMINEE
(County)

Located in:

Corner Code #

1. Public Land Survey

T2N R 28W

J-1 ✓

T R

T33 R 28

J-13

T R

2. Property Controlling
in Section

S T R

S T R

3. Miscellaneous
Property in Sec.

S T R

S T R

REGISTER OF DEEDS
MENOMINEE COUNTY
CORNER RECORDATION
SECTION 334 BK 5
APR 21 PM 3:10

Register of Deeds Stamp & File Number

4. Lot No. _____, Recorded Plat _____

5. Private Claims _____

SAME AS CORNER J-13, T33N-R28W

I, William Lenca, in a field survey on Mar. 04, 19 97 do hereby state that under requirements of P.A. 74, Michigan P.A. of 1970, the corner points mentioned in lines 1 and 2 above were in conformance with regulations and rules therefore as required in the current manual of survey instructions of the United States Department of the Interior, Bureau of Land Management or by a decree of a Court of Law and for that the corner points mentioned in lines 3, 4 and 5 above were in conformance with the rules of the Michigan Board of Land Surveyors or by a Decree of a Court of Law, established, re-established, monumented, recovered, found as expressed below:

NOTE: Not more than 2 corners, all in the same town and range, may be recorded on this certificate.

A	B	C	D	E	F	G	H	I	J	K	L
1											
2	6		5		4		3		2		1
3											
4	7		8		9		10		11		12
5											
6	10		17		16		15		14		13
7											
8	19		20		21		22		23		24
9											
10	30		29		28		27		26		25
11											
12	31		32		33		34		35		36
13											

A. Description of original monument and accessories and/or subsequent restoration:

- 1847: Original Survey by John Mullett - B.T.'s - Maple, 12" - N42°E - 24 lks.; Maple, 10" - N30°W - 22 lks. All original evidence for this corner has been destroyed by farming activities.
- 1981: CERTIFIED SURVEY No. 210 recorded by George B. Wilson, RLS No. 17607, shows a subdivision of Section 35, T33N-R28W and shows this corner at a single proportional location.

B. Description of corner evidence found and/or method applied in restoring or reestablishing corner:

We retraced the North Line of Section 2, as shown in Certified Survey No. 210, and found that the measurement between the NE Corner and the channel iron near the shore of the Menominee River matched with Wilson's recorded distance of 4871.36 feet. We computed the location of corner J-1 as being on line between the above mentioned corners and at a distance of 2658.72 feet as shown in Certified Survey No. 210. We traversed into this position and found that it fell on an ancient E - W fence with some very old fence remnants running north. We accepted this location as the best available evidence of the position of the original corner.

C. Description of monument for corner and accessories established to perpetuate locating the position of the corner:

Set 3/4" x 60" alum. rod/3-1/4 Alum. cap stamped for corner location:

7" dia. White Ash	N24°E	22.14 feet	Scr. NBT
5" dia. White Ash	N73°E	35.42 feet	Scr. NBT
8" dia. White Ash	S06°W	6.11 feet	Scr. NBT
13" dia. White Pine	N74°W	60.39 feet	Scr. NBT
Metal Survey Sign Post	South	1.0 feet	

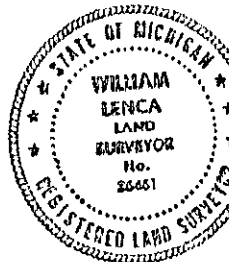

NOTE: All bearings are magnetic bearings. All distances are measured with steel tape. Distances to trees are to nail in side of tree.

Signed by William Lenca
Surveyor's Michigan License No. 26461

Date Apr. 08, 1997

534