

**SURVEY & REMONUMENTATION**

JUN 23 1994

COMMISSION

**LAND CORNER RECORDATION CERTIFICATE**  
Filing Requirement of Act 74, Mich. P.A. 1970

Approved by Menominee County  
Land Survey Remonumentation  
Peer Group Under Act 345 Of  
P.A. Of 1990 on 5/18 1994  
*Mc Dow*  
Chairman

For corners in  
**MENOMINEE**

(County)

Located in:

Corner Code #

1. Public Land Survey	T	<u>32N</u>	R	<u>28W</u>	<u>J-3</u>
	T		R		
	T		R		
	T		R		
2. Property Controlling in Section	S		T		
	S		T		
3. Miscellaneous Property in Sec.	S		T		
	S		T		

RECEIVED FOR RECORD  
94 MAY 20 PM 3:31  
PAGE # 58 BK. 4  
BARBARA MORRISON  
REGISTER OF DEEDS  
MENOMINEE, MI 49858  
Register of Deeds Stamp & File Number

4. Lot No. \_\_\_\_\_, Recorded Plat \_\_\_\_\_  
5. Private Claims \_\_\_\_\_

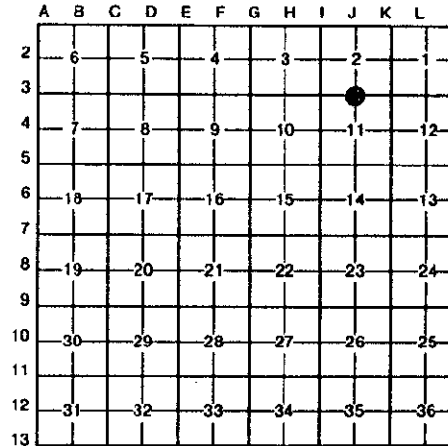

I, William Lenca, in a field survey on Feb. 22, 1994, do hereby certify that under requirements of P.A. 74, Michigan P.A. of 1970, the corner points mentioned in lines 1 and 2 above were in conformance with regulations and rules therefore as required in the current manual of survey instructions of the United States Department of the Interior, Bureau of Land Management or by a decree of a Court of Law and/or that the corner points mentioned in lines 3, 4 and 5 above were in conformance with the rules of the Michigan Board of Land Surveyors or by a Decree of a Court of Law; established, re-established, monumented, re-monumented, recovered, found as expressed below:

**NOTE: Not more than 4 corners, all in the same town and range, may be recorded on this certificate.**

A. Description of original monument and accessories and/or subsequent restoration:

ORIGINAL B.T.'s: Maple 12", N74°W, 03 lks  
Hemlock, 10", S31°E, 08 lks

Original Survey by James H. Mullett in 1848. All original evidence for this corner has been destroyed by farming activities

PERPETUATION: 5/12/1975 - LCRC No. 95 recorded by George B. Wilson. Certificate contains testimony of Mr. Emil Dvorchek, a resident since 1914, as to an old fence built in 1908. Wilson states he set a 2" dia. alum. pipe with alum. cap stamped. NBT's - 5" Maple - 325 deg azim - 43.2'; 6" W. Pine - 36 deg azim - 46.7'; 8" W. Pine - 205 deg azim - 50.5'.

B. Description of corner evidence found and/or method applied in restoring or reestablishing corner:

Found 2" dia. Aluminum Pipe with 3-1/4" dia. Aluminum cap as described in LCRC No. 95. This corner falls at the corner of old fences running south and west from this location (as indicated in LCRC No. 95) and is accepted as the best available evidence of the position of the original corner.

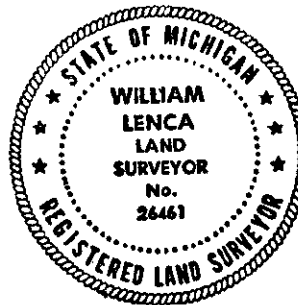

C. Description of monument for corner and accessories established to perpetuate locating the position of the corner:

Accepted existing 2" dia. Alum. Pipe / 3-1/4" dia. Alum. cap stamped for corner:

16" dia. White Pine	Scr. NBT	N30°E	46.76 feet
9" dia. Maple	" "	S55°E	69.77 feet
16" dia. Norway Pine	" "	S22°W	50.71 feet
6" dia. Jack Pine	" "	N68°W	29.00 feet
Metal Survey Sign Post		S05°W	2.0 feet

NOTE: All bearings are magnetic bearings. All distances are measured with steel tape. Distances to trees are to nail in side of tree.

Signed by William Lenca Date April 16, 1994

Surveyor's Michigan License No. 26461