

SURVEY & REMONUMENTATION

FEB 11 1998

Approved by Menominee County
Land Survey Remonumentation
Peer Group Under Act 345 OF

P.A. Of 1990 On 10/31, 1992

William RLS
Chairman

LAND CORNER RECORDATION CERTIFICATE Filing Requirement of Act 74, Mich. P.A. 1970

SECTION

For corners in

MENOMINEE (County)	Located In:	Corner Code #
1. Public Land Survey	T32N R 28W	K-6
	T R	
	T R	
	T R	
2. Property Controlling in Section	S T R	
	S T R	
3. Miscellaneous Property in Sec.	S T R	
	S T R	

97 NOV 21 PM 3:19
REGISTERED LAND SURVEYOR
WILLIAM RLS
CHAIRMAN

Register of Deeds Stamp & File Number

4. Lot No. _____, Recorded Plat _____
5. Private Claims _____

I, William Lenca, in a field survey on Mar. 26, 19 97 do hereby state that under requirements of P.A. 74, Michigan P.A. of 1970, the corner points mentioned in lines 1 and 2 above were in conformance with regulations and rules therefore as required in the current manual of survey instructions of the United States Department of the Interior, Bureau of Land Management or by a decree of a Court of Law and /or that the corner points mentioned in lines 3, 4 and 5 above were in conformance with the rules of the Michigan Board of Land Surveyors or by a Decree of a Court of Law; established, re-established, monumented, recovered, found as expressed below:

NOTE: Not more than 2 corners, all in the same town and range, may be recorded on this certificate.

A	B	C	D	E	F	G	H	I	J	K	L	M
1												
2	6	5	4	3	2	1						
3												
4	7	8	9	10	11	12						
5												
6	18	17	16	15	14	13						
7												
8	19	20	21	22	23	24						
9												
10	30	29	28	27	26	25						
11												
12	31	32	33	34	35	36						
13												

A. Description of original monument and accessories and/or subsequent restoration:

- 1848: Original Survey by James H. Mullett - B.T.'s - Hemlock, 8" - S26°W - 10 lks.; Maple, 8" - S88°E - 12 lks. No evidence of the original corner or its accessories were recovered.
1960: Plat of Survey by Robert Olsen, RLS No. 10700, shows this corner as it relates to other corners in Section 13, T32N-R28W. The corner is described as " Conc. Mon. - replaces old rotted wood stake. No B.T.'s are given.
1970: Plat of "OAK PARK" by George B. Wilson, RLS No. 17607, shows a tie to this corner.
1982: CERTIFIED SURVEY No. 295, recorded by George B. Wilson, RLS No. 17607, shows this corner as it relates to other corners in Section 13, T32N-R28W. The corner is described in the legend as 4" square conc. mon, 36" long rod in center.

B. Description of corner evidence found and/or method applied in restoring or reestablishing corner:

We recovered a 4 inch square concrete monument in a location that matched closely with the record distance North to the NW Corner of Section 13, T32N-R28W as shown in Certified Survey No. 295, and with the distance South to the Meander Corner on the Menominee River, as shown in the plat of "OAK PARK". Robert Olsen's record distances also match this position. This corner has been accepted by local surveyors for over 35 years, and is accepted as the best available evidence of the position of the original corner.

C. Description of monument for corner and accessories established to perpetuate locating the position of the corner:

Accepted existing 4" square concrete monument - set 3-1/4" dia. Alum cap stamped for corner location on to

5" dia. Maple	N45°E	18.24 feet	Scr. NBT
6" dia. Oak	S14°E	7.78 feet	Scr. NBT
6" dia. Maple	S82°W	19.53 feet	Scr. NBT
10" dia. Beech	N12°W	35.24 feet	Scr. NBT
Metal Survey Sign Post	N85°W	1.0 feet	

NOTE: All bearings are magnetic bearings. All distances are measured with steel tape. Distances to trees are to nail in side of tree.

Signed by William Lenca
Surveyor's Michigan License No. 26461

Date Apr. 10, 1997

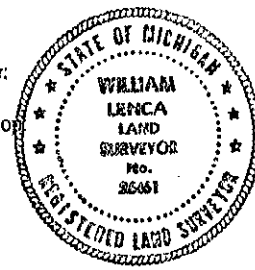

536