

FEB 11 1998

Approved by Menominee County
Land Survey Remonumentation
Peer Group Under Act 345 Of
P.A. Of 1990 On 10/1st 1992
McDunn RLS
Chairman

SECTION

LAND CORNER RECORDATION CERTIFICATE
Filing Requirement of Act 74, Mich. P.A. 1970

For corners in MENOMINEE (County)	Located In:	Corner Code #
1. Public Land Survey	T <u>32N</u> R <u>28W</u>	<u>L-3</u>
	T ___ R ___	___
	T ___ R ___	___
	T ___ R ___	___
2. Property Controlling In Section	S ___ T ___ R ___	___
	S ___ T ___ R ___	___
3. Miscellaneous Property in Sec.	S ___ T ___ R ___	___
	S ___ T ___ R ___	___

97 MAR 21 PM 3:19
539 BKS
Register of Deeds Stamp & File Number

4. Lot No. _____, Recorded Plat _____
5. Private Claims _____

I, William Lenca, in a field survey on Mar. 06, 1997 do hereby state that under requirements of P.A. 74, Michigan P.A. of 1970, the corner points mentioned in lines 1 and 2 above were in conformance with regulations and rules therefore as required in the current manual of survey instructions of the United States Department of the Interior, Bureau of Land Management or by a decree of a Court of Law and /or that the corner points mentioned in lines 3, 4 and 5 above were in conformance with the rules of the Michigan Board of Land Surveyors or by a Decree of a Court of Law; established, re-established, monumented, recovered, found as expressed below.

NOTE: Not more than 2 corners, all in the same town and range, may be recorded on this certificate.

	A	B	C	D	E	F	G	H	I	J	K	L	M
1													
2	6		5		4		3		2		1		
3													
4	7		8		9		10		11		12		
5													
6	10		17		16		15		14		13		
7													
8	19		20		21		22		23		24		
9													
10	30		29		28		27		26		25		
11													
12	31		32		33		34		35		36		
13													

- A. Description of original monument and accessories and/or subsequent restoration:
- 1848: Original Survey by James H. Mullett - B.T.'s - Hemlock, 8" - N29°W - 9 lks.; Hemlock, 5" - S52°W - 10 lks. No evidence of the original corner or its accessories were found.
 - 1993: L.C.R.C. No. 954 recorded by William Lenca, RLS No. 26461, indicates a 1-1/2" x 30" alum. pipe/2-1/2" alum. cap was set by single proportion - B.T.'s: 8" Maple - N15°E - 29.75'; 7" Maple - N88°E - 28.38'; 10" Maple - S03°W - 35.83'; 6" Cherry - West - 17.23'; Carsonite - S38°W - 1.3'.
 - 1993: CERTIFIED SURVEY No. 796 recorded by William Lenca, RLS No. 26461, shows this corner as it relates to other corners in the area.

B. Description of corner evidence found and/or method applied in restoring or reestablishing corner:
We recovered a 1-1/2" diameter aluminum pipe with a 2-1/2" diameter aluminum cap and the 4 B.T.'s as described in part "A" above. The corner is located at a single proportional location between the NW Corner and the NE Corner of Section 12, T32N-R28W, and is accepted as a careful and faithful reestablishment of the position of the original corner.

C. Description of monument for corner and accessories established to perpetuate locating the position of the corner:

Accepted existing 1-1/2" x 30" alum. pipe/2-1/2" alum. cap stamped for corner:

8" dia. Maple	N15°E	29.75 feet	"X" cut in upper & lower blaze
7" dia. Maple	N88°E	28.38 feet	"X" cut in upper & lower blaze
10" dia. Maple	S03°W	35.83 feet	"X" cut in upper & lower blaze
6" dia. Cherry	S90°W	17.23 feet	"X" cut in upper & lower blaze
Carsonite Marker	S38°W	1.3 feet	

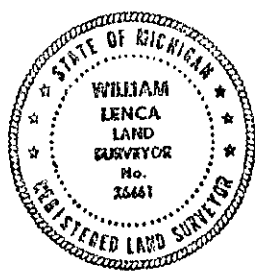

NOTE: All bearings are magnetic bearings. All distances are measured with steel tape. Distances to trees are to nail in side of tree.

Signed by William Lenca Date Apr. 10, 1997
Surveyor's Michigan License No. 26461

539