

LAND CORNER RECORDATION CERTIFICATE
Filing Requirement of Act 74, Mich. P.A. 1970

Mark Davis RLS
Chairman

For corners in

<u>MENOMINEE</u> (County)	Located In:	Corner Code #
1. Public Land Survey	T <u>33N</u> R <u>27W</u>	<u>M05</u>
	T <u>33N</u> R <u>26W</u>	<u>A-5</u> ✓
2. Property Controlling in Section	S <u> </u> T <u> </u> R <u> </u>	<u> </u>
3. Miscellaneous Property in Sec.	S <u> </u> T <u> </u> R <u> </u>	<u> </u>

RECEIVED FOR RECORD
95 DEC 27 PM 3:29
PAGE # 273 BK 4
BARBARA MCGONIGAN
REGISTERED PROFESSIONAL
MENOMINEE, MI 49859
Register of Deeds Stamp & File Number

4. Lot No. , Recorded Plat
5. Private Claims

(SAME AS CORNER A05 T33N-R26W)

I, William Lenca, in a field survey on Aug. 04, 19 95 do hereby state that under requirements of P.A. 74, Michigan P.A. of 1970, the corner points mentioned in lines 1 and 2 above were in conformance with regulations and rules therefore as required in the current manual of survey instructions of the United States Department of the Interior, Bureau of Land Management or by a decree of a Court of Law and /or that the corner points mentioned in lines 3, 4 and 5 above were in conformance with the rules of the Michigan Board of Land Surveyors or by a Decree of a Court of Law; established, re-established, monumented, recovered, found as expressed below:

A	B	C	D	E	F	G	H	I	J	K	L	M
1												
2	6		5		4		3		2		1	
3												
4	7		8		9		10		11		12	
5												
6	18		17		16		15		14		13	
7												
8	19		20		21		22		23		24	
9												
10	30		29		28		27		26		25	
11												
12	31		32		33		34		35		36	
13												

NOTE: Not more than 2 corners, all in the same town and range, may be recorded on this certificate.

A. Description of original monument and accessories and/or subsequent restoration:

- 1848: Original Survey by James H. Mullett - B.T.'s - Hemlock, 10" - N21°E - 10 lks; Hemlock, 10" - S32°E - 21 lks; Hemlock, 20" - S15°W - 14lks; Cedar, 16" - N55°W - 12 lks. All original evidence has been destroyed by county road improvements.
- 1902: Record of Survey by Albert Haas, County Surveyor, shows partial subdivision of Section 12 and shows the location of corner M-5 as it relates to other corners in Section 12. Haas' record states that "corner formerly set". No monument is described and no new ties are given.
- 1984: L.C.R.C. No. 596 by George B. Wilson, RLS No. 17607, states that a Deep-1 Magnet was set using A. Haas Survey and Road centerlines. TIES: Deep-1 - NE - 36.5 feet; Deep-1 - SE - 47.3 feet.

B. Description of corner evidence found and/or method applied in restoring or reestablishing corner:

We recovered a W-1-B Bertsen Monument with a 4 inch diameter cap in the centerline of county roads running North - South and West. This monument is typical of those set by George B. Wilson in the late 1970's and early 1980's, and was apparently set to replace the Deep-1 magnet described in part "A". Our measured distance North to the E1/4 Corner of Section 12 is 2564.44 feet as compared to Albert Haas' recorded distance of 2568.7 feet. Our measured distance West to the S1/4 Corner of Section 12 is 2638.88 feet as compared to Albert Haas' recorded distance of 2645.3 feet. We accepted the position of the W-1-B Bertsen Monument as the best available evidence of the position of the original corner.

C. Description of monument for corner and accessories established to perpetuate locating the position of the corner:
Set 5/8" x 24" Iron Rod/3-1/4" dia. Alum. cap stamped for corner location in Monument Box:

6" dia. Ash	N41°E	86.86 feet	Scr. NBT
10" dia. Ash	S62°E	71.53 feet	Scr. NBT
4" dia. Ash	S46°W	63.51 feet	Scr. NBT
9" dia. Ash	N48°W	79.20 feet	Scr. NBT
Metal Survey Sign Post	S44°E	48.5 feet	

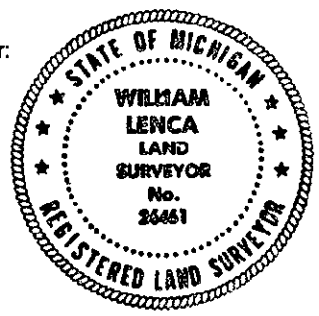

NOTE: All bearings are magnetic bearings. All distances are measured with a steel tape. Distances to trees are to nail in side of tree.

Signed by William Lenca
Surveyor's Michigan License No. 26461

Date Nov. 24, 1995