

SURVEY & REMONUMENTATION

OCT 27 1999

SECTION

LAND CORNER RECORDATION CERTIFICATE
Filing Requirement of Act 74, Mich. P.A. 1970

Approved by Menominee County
Land Survey Remonumentation
Peer Group Under Act 345 Of
P.A. Of 1990 On 10/11 1999
Mr. Davis RLS
Chairman

For corners in

| | | |
|---------------------------------------|--|---------------|
| <u>MENOMINEE</u> (County) | Located In: | Corner Code # |
| 1. Public Land Survey | T <u>33</u> N R <u>26</u> W | <u>1-3</u> |
| | T <u> </u> R <u> </u> | <u> </u> |
| | T <u> </u> R <u> </u> | <u> </u> |
| | T <u> </u> R <u> </u> | <u> </u> |
| 2. Property Controlling in Section | S <u> </u> T <u> </u> R <u> </u> | <u> </u> |
| | S <u> </u> T <u> </u> R <u> </u> | <u> </u> |
| 3. Miscellaneous Property in Sec. | S <u> </u> T <u> </u> R <u> </u> | <u> </u> |
| | S <u> </u> T <u> </u> R <u> </u> | <u> </u> |
| 4. Lot No. _____, Recorded Plat _____ | | |
| 5. Private Claims _____ | | |

RECEIVED FOR RECORD
99 OCT 15 PM 1:40
PAGE # 04 BK 6
BARBARA MORRISON
REGISTER OF DEEDS
MENOMINEE, MI 49858
Register of Deeds Stamp & File Number

I, William Lenca, in a field survey on Mar., 19 99 do hereby state that under requirements of P.A. 74, Michigan P.A. of 1970, the corner points mentioned in lines 1 and 2 above were in conformance with regulations and rules therefore as required in the current manual of survey instructions of the United States Department of the Interior, Bureau of Land Management or by a decree of a Court of Law and /or that the corner points mentioned in lines 3, 4 and 5 above were in conformance with the rules of the Michigan Board of Land Surveyors or by a Decree of a Court of Law; established, re-established, monumented, recovered, found as expressed below:

NOTE: Not more than 2 corners, all in the same town and range, may be recorded on this certificate.

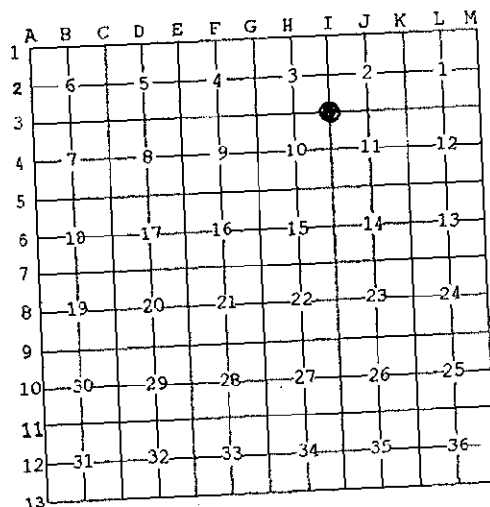

A. Description of original monument and accessories and/or subsequent restoration:

1848: Original Survey by James H. Mullett - B.T.'s - Hemlock, 15" - S43°E - 30 lks.; Fir, 8" - N72°W - 17 lks. All original evidence for this corner has been destroyed by Logging activities.

B. Description of corner evidence found and/or method applied in restoring or reestablishing corner:

We found a 3/4 inch diameter aluminum rod with a 3-1/4 inch diameter aluminum cap in a position matching that shown in George B. Wilson's private records from 1978. Although it is not clear how Wilson established this corner, the position fits with a straight line between the Northwest Corner of Section 10 and the Northeast Corner of Section 11, and is at a single proportional location between the NW Corner of Section 10 and the N1/4 Corner of Section 11. The 1/4 Corner 1/2 mile South is located on Line and midway between this corner and the SW Corner of Section 11. Since this corner has been used by local surveyors for several years, and measurements to other corners in the area fit very well, we accepted this position as the best available evidence of the position of the original corner.

C. Description of monument for corner and accessories established to perpetuate locating the position of the corner:

Accepted existing 3/4" aluminum rod/3-1/4" dia. Alum. cap stamped for corner:

| | | | |
|------------------------|-------|------------|----------|
| 9" dia. Hemlock | N54°E | 7.48 feet | Scr. NBT |
| 12" dia. Hemlock | S20°W | 7.18 feet | Scr. NBT |
| 10" dia. Hemlock | S75°W | 20.80 feet | Scr. NBT |
| 26" dia. White Pine | N20°W | 28.11 feet | Scr. NBT |
| Metal Survey Sign Post | North | 1.0 feet | |

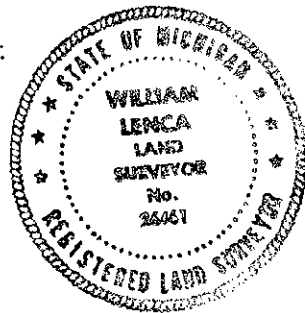

NOTE: All bearings are magnetic bearings. All distances are measured with steel tape. Distances to trees are to nail in side of tree.

Signed by William Lenca
Surveyor's Michigan License No. 26461

Date Sep. 29, 1999