

LAND CORNER RECORDATION CERTIFICATE
Filing Requirement of Act 74, Mich. P.A. 1970

Approved by Menominee County
Land Survey Renomination
Peer Group Under Act 345 Of
P.A. Of 1990 On 12/12, 1996

For corners in
MENOMINEE
(County)

Located In: _____ Corner Code # _____

1. Public Land Survey T33N R 27W _____ A05
T _____ R _____
T _____ R _____
T _____ R _____

2. Property Controlling S _____ T _____ R _____
in Section S _____ T _____ R _____

3. Miscellaneous S _____ T _____ R _____
Property in Sec. S _____ T _____ R _____

Chairman
Mike Danni RLS

96 DEC 20 PM 9:36

AREA 4110 BK 5

REGISTERED LAND SURVEYOR

Register of Deeds Stamp & File Number

4. Lot No. _____, Recorded Plat _____
5. Private Claims _____

SAME AS CORNER M-05 T33N-R28W

A	B	C	D	E	F	G	H	I	J	K	L	M
1												
2	6		5		4		3		2		1	
3												
4	7		8		9		10		11		12	
5												
6	18		17		16		15		14		13	
7												
8	19		20		21		22		23		24	
9												
10	30		29		28		27		26		25	
11												
12	31		32		33		34		35		36	
13												

I, William Lenca, in a field survey on Feb. 08, 1996 do hereby state that under requirements of P.A. 74, Michigan P.A. of 1970, the corner points mentioned in lines 1 and 2 above were in conformance with regulations and rules therefore as required in the current manual of survey instructions of the United States Department of the Interior, Bureau of Land Management or by a decree of a Court of Law and/or that the corner points mentioned in lines 3, 4 and 5 above were in conformance with the rules of the Michigan Board of Land Surveyors or by a Decree of a Court of Law, established, re-established, monumented, recovered, found as expressed below:

NOTE: Not more than 2 corners, all in the same town and range, may be recorded on this certificate.

A. Description of original monument and accessories and/or subsequent restoration:

- 1847: Original Survey (Twp Bdy) by James H. Mullett - B.T.'s - Hemlock, 10" - N14°W - 18 lks; Hemlock, 6" - S71°W - 25 lks. All original evidence for this corner has been destroyed by county road improvements.
- 1848: Original Survey (Sec. Subd) by John Mullett - B.T.'s - Hemlock, 30" - N44°E - 28 lks; Cedar, 5" - S55°E - 39 lks. All original evidence for this corner has been destroyed by county road improvements.
- 1974: L.C.R.C. No. 73, Book 1 recorded by George B. Wilson, RLS No. 17607, states "No evidence found of original corner - Re set by double proportion, and swamp call to the west - Corner monument - 2" x 30" iron pipe filled with concrete/brass cap stamped, anchored at bottom - WITNESSES - 235° azm. - 5" Oak - 1.5'; 274° azm. - 6" Pine - 25.3'; 30° azm - 3" Maple - 8.0'; 116° azm. - 2" Maple - 24.4'; 163° azm. - 6" Pine - 37.4'."

B. Description of corner evidence found and/or method applied in restoring or reestablishing corner:

We found a 2 inch diameter iron pipe with a 2-1/4 inch diameter brass cap at the position indicated by information in L.C.R.C. No. 73. We also found 3 B.T.'s as described in L.C.R.C. No. 73. (See part "A") as follows: 5" Maple - N30°E - 8.0'; 5" Oak (Now 12") - S55°W - 1.5 feet; 6" Pine (Now 10") - N86°W - 25.93 feet. This corner has been accepted and used by local surveyors for at least 22 years, and is accepted as a careful and faithful reestablishment of the position of the original corner.

C. Description of monument for corner and accessories established to perpetuate locating the position of the corner:
Accepted existing 2" dia. Iron Pipe/2-1/4" dia. Brass cap stamped for corner location:

5" dia. Maple (Ex. B.T.)	N21°E	7.99 feet	Scr. NBT
8" dia. Maple	S40°E	22.42 feet	Scr. NBT
12" dia. Oak	S55°W	1.67 feet	Scr. NBT
10" dia. White Pine	N86°W	25.93 feet	Scr. NBT
Carsonite Marker	N51°E	2.5 feet	
2" dia. Iron Pipe	N36°W	28.04 feet	

NOTE: All bearings are magnetic bearings. All distances are measured with steel tape. Distances to trees are to nail in side of tree.

Signed by William Lenca Date Nov. 18, 1996
Surveyor's Michigan License No. 26461

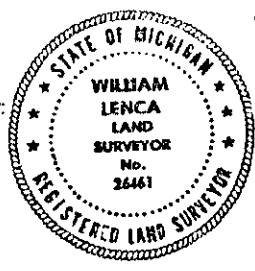

410