

LAND CORNER RECORDATION CERTIFICATE
Filing Requirement of Act 74, Mich. P.A. 1970

Approved by Menominee County
Land Survey Recononumentation
Peer Group Under Act 345 Of

For corners in

MENOMINEE
(County)

Located In:

Corner Code #

- | | | |
|---------------------------------------|---------------------------|------------|
| 1. Public Land Survey | T <u>33N</u> R <u>27W</u> | <u>A06</u> |
| | T _____ R _____ | _____ |
| | T _____ R _____ | _____ |
| | T _____ R _____ | _____ |
| 2. Property Controlling
in Section | S _____ T _____ R _____ | _____ |
| | S _____ T _____ R _____ | _____ |
| 3. Miscellaneous
Property in Sec. | S _____ T _____ R _____ | _____ |
| | S _____ T _____ R _____ | _____ |

P.A. Of 1990 On 12/12 19926

William Lenca RLS
Chairman

STATE OF MICHIGAN
MICHIGAN SURVEYORS
BOOK 411, BK 5
DEC 20 AM 9:36

Register of Deeds Stamp & File Number

4. Lot No. _____, Recorded Plat _____
5. Private Claims _____

SAME AS CORNER M-06 T33N-R28W

I, William Lenca, in a field survey on Jun 27, 1996 do hereby state that under requirements of P.A. 74, Michigan P.A. of 1970, the corner points mentioned in lines 1 and 2 above were in conformance with regulations and rules therefore as required in the current manual of survey instructions of the United States Department of the Interior, Bureau of Land Management or by a decree of a Court of Law and/or that the corner points mentioned in lines 3, 4 and 5 above were in conformance with the rules of the Michigan Board of Land Surveyors or by a Decree of a Court of Law, established, re-established, monumented, recovered, found as expressed below:

NOTE: Not more than 2 corners, all in the same town and range, may be recorded on this certificate.

A	B	C	D	E	F	G	H	I	J	K	L	M
1												
2	6	5	4	3	2	1						
3												
4	7	8	9	10	11	12						
5												
6	18	17	16	15	14	13						
7												
8	19	20	21	22	23	24						
9												
10	30	29	28	27	26	25						
11												
12	31	32	33	34	35	36						
13												

A. Description of original monument and accessories and/or subsequent restoration:

- 1847: Original Survey (Twp Bdy) by James H. Mullett - B.T.'s - Hemlock, 10" - N20°W - 08 lks; Fir, 8" - N63°E - 17 lks. All original evidence for this corner has been destroyed by county road improvements.
- 1988: Certified Survey No. 595, Book 4, recorded by William Lenca, RLS No. 26461, shows this corner as it relates to other corners in Section 13, T33N-R28W. Our field notes from this survey indicate that a 60d nail was found in an old wood post 4.5 feet East of the center of a N-S County Road and in line with an old fence running East. B.T.'s - Power Pole - S87°E - 36.52'; Cedar, 8" - S48°W - 55.47'; W. Ash, 6" - N45°W - 63.85'.

B. Description of corner evidence found and/or method applied in restoring or reestablishing corner:

We found a 5/8 inch diameter iron rod 24 inches long driven into an old wood post along with the 3 witnesses noted in part "A" above. The corner falls 4.5 feet East of the centerline of a North - South County Road and in line with an old fence line running East. Measurements to corners North and South of this position fit reasonably well with GLO record distances. We accepted the location of the old wood post as the best available evidence of the position of the original corner.

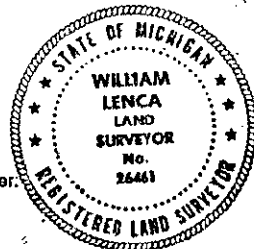

C. Description of monument for corner and accessories established to perpetuate locating the position of the corner:
Set 5/8" x 24" Iron Rod/3-1/4" dia. Alum. cap stamped for corner location in Monument Box:

5/8" x 24" Iron Rod/2" dia. Alum. cap marked "WITNESS MARKER"	East	23.41 feet	
8" dia. Cedar	S48°W	55.47 feet	Scr. NBT
6" dia. White Ash	N45°W	63.85 feet	Scr. NBT
Metal Survey Sign Post	East	24.2 feet	

NOTE: All bearings are magnetic bearings. All distances are measured with steel tape. Distances to trees are to nail in side of tree.

Signed by William Lenca
Surveyor's Michigan License No. 26461

Date Nov. 18, 1996