

LAND CORNER RECORDATION CERTIFICATE
Filing Requirement of Act 74, Mich. P.A. 1970

Approved by Menominee County
Land Survey Reorganization
Peer Group Under Act 345 Of

P.A. Of 1990 On 12/12 19996

For corners in

MENOMINEE
(County)

Located In:

Corner Code #

- | | | |
|------------------------------------|--|------------|
| 1. Public Land Survey | T <u>33N</u> R <u>27W</u> | <u>A08</u> |
| | T <u> </u> R <u> </u> | <u> </u> |
| | T <u> </u> R <u> </u> | <u> </u> |
| | T <u> </u> R <u> </u> | <u> </u> |
| 2. Property Controlling in Section | S <u> </u> T <u> </u> R <u> </u> | <u> </u> |
| | S <u> </u> T <u> </u> R <u> </u> | <u> </u> |
| 3. Miscellaneous Property in Sec. | S <u> </u> T <u> </u> R <u> </u> | <u> </u> |
| | S <u> </u> T <u> </u> R <u> </u> | <u> </u> |

Chairman
 DEC 20 AM 9:35
 # 413, BK 5
 REGISTERED LAND SURVEYOR

Register of Deeds Stamp & File Number

4. Lot No. _____, Recorded Plat _____
 5. Private Claims _____

SAME AS CORNER M-08 T33N-R28W

I, William Lenca, in a field survey on Apr. 24, 1996 do hereby state that under requirements of P.A. 74, Michigan P.A. of 1970, the corner points mentioned in lines 1 and 2 above were in conformance with regulations and rules therefore as required in the current manual of survey instructions of the United States Department of the Interior, Bureau of Land Management or by a decree of a Court of Law and/or that the corner points mentioned in lines 3, 4 and 5 above were in conformance with the rules of the Michigan Board of Land Surveyors or by a Decree of a Court of Law; established, re-established, monumented, recovered, found as expressed below:

NOTE: Not more than 2 corners, all in the same town and range, may be recorded on this certificate.

A	B	C	D	E	F	G	H	I	J	K	L	M
1												
2	6	5	4	3	2	1						
3												
4	7	8	9	10	11	12						
5												
6	16	17	16	15	14	13						
7												
8	19	20	21	22	23	24						
9												
10	30	29	28	27	26	25						
11												
12	31	32	33	34	35	36						
13												

A. Description of original monument and accessories and/or subsequent restoration:

- 1847: Original Survey (Twp Bdy) by James H. Mullett - B.T.'s - Hemlock, 8" - S30°E - 20 lks; Fir, 6" - S33°W - 16 lks.
 All original evidence for this corner has been destroyed by county road improvements.
 1988: L.C.R.C. No. 814, Book 3, recorded by William Lenca, RLS No. 26461, states "Found Concrete Monument set by George B. Wilson, RLS No. 17607." TIES: Scotch Pine, 9" - N50°E - 79.45'; S. Pine, 10" - S29°E - 35.66'; Nail in Fence Post - South - 0.79'.

B. Description of corner evidence found and/or method applied in restoring or reestablishing corner:

We found a 4 inch diameter concrete monument at the base of a large fence post at the North end of a North - South fence. An ancient fence runs East from this location. We also found the 3 corner ties as described in L.C.R.C. No. 814 (sect part "A"). This corner position fits well with measurements to corners 1/2 mile North and 1/2 mile South, fits existing occupation, and is accepted as the best available evidence of the position of the original corner.

C. Description of monument for corner and accessories established to perpetuate locating the position of the corner:
 Accepted existing 4" dia. Concrete Monument/set 3-1/4" dia. Alum. cap stamped for corner:

10" dia. White Pine (Ex. B.T.)	N50°E	79.45 feet	Scr. NBT
12" dia. White Pine (Ex. B.T.)	S29°E	35.66 feet	Scr. NBT
12" dia. White Pine	N76°W	92.30 feet	Scr. NBT
Nail in fence post	South	0.79 feet	
Survey Sign Post	East	1.3 feet	

NOTE: All bearings are magnetic bearings. All distances are measured with steel tape. Distances to trees are to nail in side of tree.

Signed by William Lenca
 Surveyor's Michigan License No. 26461

Date Nov. 18, 1996

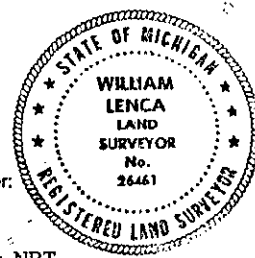

413