

SURVEY & REMONUMENTATION
APR 11 1995
COMMISSION

LAND CORNER RECORDATION CERTIFICATE
Filing Requirement of Act 74, Mich. P.A. 1970

Approved by Menominee County
 Land Survey Remonumentation
 Four Group Under Act 245 of
 P.A. of 1990 On 12/12/94
MEL DAVIS RLS
 ACTING Chairman

For corners in MENOMINEE (County) Located In: _____ Corner Code #/1 _____

1. Public Land Survey	T <u>33N</u> R <u>27W</u>	<u>A-09</u>
	T _____ R _____	_____
	T _____ R _____	_____
	T _____ R _____	_____
2. Property Controlling in Section	S _____ T _____ R _____	_____
	S _____ T _____ R _____	_____
3. Miscellaneous Property in Sec.	S _____ T _____ R _____	_____
	S _____ T _____ R _____	_____
4. Lot No. _____, Recorded Plat _____		
5. Private Claims _____		

RECEIVED FOR RECORD
 9/4 DEC 12 AM 8
 PAGE #/Job BK 4
 BARBARA MORRIS
 REGISTER OF DEEDS
 MENOMINEE, MI 49858
 Register of Deeds Stamp & File Number.

A	B	C	D	E	F	G	H	I	J	K	L
2	6	5	4	3	2	1					
3											
4	7	8	9	10	11	12					
5											
6	18	17	16	15	14	13					
7											
8	19	20	21	22	23	24					
9											
10	30	29	28	27	26	25					
11											
12	31	32	33	34	35	36					
13											

William Lenca May 31 1994
 I, _____, in a field survey on _____, 19____, do hereby certify that under requirements of P.A. 74, Michigan P.A. of 1970, the corner points mentioned in lines 1 and 2 above were in conformance with regulations and rules therefore as required in the current manual of survey instructions of the United States Department of the Interior, Bureau of Land Management or by a decree of a Court of Law and/or that the corner points mentioned in lines 3, 4 and 5 above were in conformance with the rules of the Michigan Board of Land Surveyors or by a Decree of a Court of Law; established, re-established, monumented, re-monumented, recovered, found as expressed below:

NOTE: Not more than 4 corners, all in the same town and range, may be recorded on this certificate.

- A. Description of original monument and accessories and/or subsequent restoration:
- 1847 - Original Survey (Township Exterior) by James H. Mullett - B.T.'s - Birch, 12" - N13°W - 30 lks; Hemlock, 12" - S84°W - 15 lks. All original evidence for this corner has been destroyed by County Road improvements.
 - 1848: Original Survey (Section Subdivisions) by John Mullett - B.T.'s - Hemlock, 10" - N09°E - 16 lks; Hemlock, 12" - S54°E - 45 lks. All original evidence for this corner has been destroyed by county road improvements.
 - 1901: Albert Haas, County Surveyor, made a survey of Section 25, T33N-R28W showing the location of this corner as it relates to other corners in this section. The survey states that a 4" Cedar Post was set from Government B.T. No. new B.T.'s are given.

B. Description of corner evidence found and/or method applied in restoring or reestablishing corner:

At the intersection of centerlines of county roads East-West and North-South we found a W-1-B Aluminum Berntsen Monument (4" dia. cap 30" long) stamped RLS 17607. Measurements to old occupation lines to the West and South indicate that this position fits very closely with the record measurements in the 1901 Albert Haas Survey. We accepted the existing monument as the best available evidence of the position of the original corner.

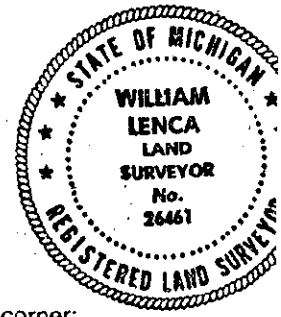

C. Description of monument for corner and accessories established to perpetuate locating the position of the corner:

Set 5/8" x 24" Iron Rod/3-1/4" dia. Alum. cap stamped for corner location in Monument Box:

5" dia. White Ash	N38°E	65.11 feet	Scr. NBT
6" dia. White Spruce	S14°W	114.78 feet	Scr. NBT
5/8" x 24" Iron Rod/2" dia. Alum. cap - WITNESS MARKER	S29°E	51.62 feet	
20" dia. Elm	N73°W	96.15 feet	Scr. NBT
Survey Sign Post	S29°E	51.9 feet	

NOTE: All bearings are magnetic bearings. All distances are measured with steel tape. Distances to trees are to nail in side of tree.

Signed by William Lenca Date Nov. 18, 1994
 Surveyor's Michigan License No. 26461