

LAND CORNER RECORDATION CERTIFICATE
Filing Requirement of Act 74, Mich. P.A. 1970

Chairman
96 DEC 30 PM 9:08
467 BK 5
REGISTERED FOR RECORD

For corners in

MENOMINEE
(County)

Located In:

Corner Code #

- | | | |
|------------------------------------|---------------------------|------------|
| 1. Public Land Survey | T <u>33N</u> R <u>27W</u> | <u>C06</u> |
| | T ___ R ___ | ___ |
| | T ___ R ___ | ___ |
| | T ___ R ___ | ___ |
| 2. Property Controlling in Section | S ___ T ___ R ___ | ___ |
| | S ___ T ___ R ___ | ___ |
| 3. Miscellaneous Property in Sec. | S ___ T ___ R ___ | ___ |
| | S ___ T ___ R ___ | ___ |

Register of Deeds Stamp & File Number

4. Lot No. _____, Recorded Plat _____
5. Private Claims _____

I, William Lenca, in a field survey on Dec 06, 1996, do hereby state that under requirements of P.A. 74, Michigan P.A. of 1970, the corner points mentioned in lines 1 and 2 above were in conformance with regulations and rules therefore as required in the current manual of survey instructions of the United States Department of the Interior, Bureau of Land Management or by a decree of a Court of Law and /or that the corner points mentioned in lines 3, 4 and 5 above were in conformance with the rules of the Michigan Board of Land Surveyors or by a Decree of a Court of Law; established, re-established, monumented, recovered, found as expressed below:

NOTE: Not more than 2 corners, all in the same town and range, may be recorded on this certificate.

A	B	C	D	E	F	G	H	I	J	K	L	M
1												
2	6	5	4	3	2	1						
3												
4	7	8	9	10	11	12						
5												
6	10	17	16	15	14	13						
7												
8	19	20	21	22	23	24						
9												
10	30	29	28	27	26	25						
11												
12	31	32	33	34	35	36						
13												

A. Description of original monument and accessories and/or subsequent restoration:

- 1848: Original Survey by John Mullett - B.T.'s - Birch, 12" - N61°W - 22 lks.; Hemlock, 8" - N58°E - 12 lks. All original evidence for this corner has been destroyed by farming activities.
1981: CERTIFIED SURVEY NO. 233 by George B. Wilson, RLS No. 17607, shows this corner as it relates to other corners in Section 18, T33N-R27W. The corner monument is not described, and no ties are given.

B. Description of corner evidence found and/or method applied in restoring or reestablishing corner:

We found a 3/4 inch diameter aluminum rod with a 3-1/4 inch diameter aluminum cap set at the corner of ancient fences running North, South and West. The position of this monument fits with distances to Section Corners to the North and South, as shown in Certified Survey No. 233. This corner has been used for several years by local surveyors, and is accepted as the best available evidence of the position of the original corner.

C. Description of monument for corner and accessories established to perpetuate locating the position of the corner:
Accepted existing 3/4" x 5' aluminum rod/ 3-1/4" dia. aluminum cap stamped for corner.

14" dia. Maple	S83°E	27.64 feet	Scr. NBT
9" dia. Maple	S23°E	18.22 feet	Scr. NBT
9" dia. White Ash	N82°W	45.31 feet	Scr. NBT
16" dia. Maple	N06°W	9.29 feet	Scr. NBT
Metal Survey Sign Post	S70°E	0.85 feet	

NOTE: All bearings are magnetic bearings. All distances are measured with steel tape. Distances to trees are to nail in side of tree.

Signed by William Lenca
Surveyor's Michigan License No. 26461

Date Dec. 19, 1996

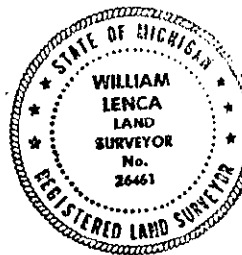

467