

**SURVEY & REMONUMENTATION  
LAND CORNER RECORDATION CERTIFICATE**

Approved by Menominee County  
Land Survey Remonumentation  
Peer Group Under Act 345 Of  
P.A. of 1990 On 12/9, 19994

For corners in  
MENOMINEE  
(County)

APR 11 1995

Filing Requirement of Act 74, Mich. P.A. 1970

*Mae Davis RLS*  
Chairman  
ACTING  
PAGE # 113 BK 4  
94 DEC 12 AM 8:59  
RECEIVED FOR RECORD  
BARBARA MORRISON  
REGISTER OF DEEDS  
MENOMINEE MI 1985B  
Register of Deeds Stamp & File Number

1. Public Land Survey	Located In:	Corner Code #
	T <u>33N</u> R <u>27W</u>	<u>C-11</u>
	T _____ R _____	_____
	T _____ R _____	_____
	T _____ R _____	_____
2. Property Controlling in Section	S _____ T _____ R _____	_____
	S _____ T _____ R _____	_____
3. Miscellaneous Property in Sec.	S _____ T _____ R _____	_____
	S _____ T _____ R _____	_____

4. Lot No. \_\_\_\_\_, Recorded Plat \_\_\_\_\_  
5. Private Claims \_\_\_\_\_

William Lenca Aug 31 1994

I, \_\_\_\_\_, in a field survey on \_\_\_\_\_, 19\_\_\_\_, do hereby certify that under requirements of P.A. 74, Michigan P.A. of 1970, the corner points mentioned in lines 1 and 2 above were in conformance with regulations and rules therefore as required in the current manual of survey instructions of the United States Department of the Interior, Bureau of Land Management or by a decree of a Court of Law and/or that the corner points mentioned in lines 3, 4 and 5 above were in conformance with the rules of the Michigan Board of Land Surveyors or by a Decree of a Court of Law; established, re-established, monumented, re-monumented, recovered, found as expressed below:

**NOTE: Not more than 4 corners, all in the same town and range, may be recorded on this certificate.**

A	B	C	D	E	F	G	H	I	J	K	L
2	6	5	4	3	2	1					
3											
4	7	8	9	10	11	12					
5											
6	16	17	18	15	14	13					
7											
8	19	20	21	22	23	24					
9											
10	30	29	28	27	26	25					
11											
12	31	32	33	34	35	36					
13											

A. Description of original monument and accessories and/or subsequent restoration:

1852: Original Survey by John Mullett - B.T.'s - Tamarack, 14" - S52°W - 11 lks; Black Ash, 8" - S15°E - 11 lks. No original evidence found.

1974: L.C.R.C. No. 76 recorded by George B. Wilson, RLS No. 17607, states that a very old 5" square cedar post was found in good condition below water line at very old 4 way fence. He set a 4" square concrete monument with a 1/2" dia. iron rod in center - B.T.'s - 4" Tam - 338° Azm - 8.7'; 4" Tam - 247° Azm - 9.5'; 3" Tam - 85° Azm - 4.0'.

B. Description of corner evidence found and/or method applied in restoring or reestablishing corner:

We found a 4 inch square concrete monument and remnants of a very old wood post at the corner of a very old 4 way fence. We also recovered the 3 bearing trees noted in part "A". We accepted the concrete monument as the best available evidence for the position of the original corner.

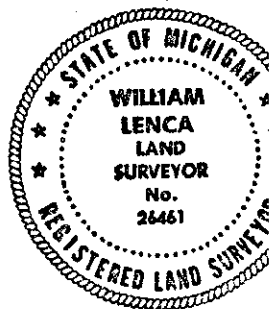

C. Description of monument for corner and accessories established to perpetuate locating the position of the corner:

Accepted existing 4" square concrete monument - set 3-1/4" dia. Alum. cap stamped for corner location:

7" dia. Tamarack	N62°E	28.08 feet	Scr. NBT
9" dia. Tamarack	S15°E	12.45 feet	Scr. NBT
9" dia. Tamarack	S89°W	38.33 feet	Scr. NBT
7" dia. Tamarack	N30°W	9.13 feet	Scr. NBT
Survey Sign Post	S65°W	1.7 feet	

**NOTE: All bearings are magnetic bearings. All distances are measured with steel tape. Distances to trees are to nail in side of tree.**

Signed by William Lenca Date Sep. 26, 1994  
Surveyor's Michigan License No. 26461