

**LAND CORNER RECORDATION CERTIFICATE**  
Filing Requirement of Act 74, Mich. P.A. 1970

Approved by Menominee County  
Land Survey Remonumentation  
Four Group Under Act 345 Of  
P.A. of 1990 On 12/12 1996  
Mc. Davis RLS  
Chairman

For corners in MENOMINEE  
(County)

Located In:	Corner Code #
1. Public Land Survey	T <u>33N</u> R <u>27W</u> _____ D07
	T _____ R _____ _____
	T _____ R _____ _____
	T _____ R _____ _____
2. Property Controlling in Section	S _____ T _____ R _____ _____
	S _____ T _____ R _____ _____
3. Miscellaneous Property in Sec.	S _____ T _____ R _____ _____
	S _____ T _____ R _____ _____

REGISTERED FOR 11 MONTHS  
95 DEC 20 AM 9:35  
BKS  
Register of Deeds Stamp & File Number

4. Lot No. \_\_\_\_\_, Recorded Plat \_\_\_\_\_  
5. Private Claims \_\_\_\_\_

I, William Lenca, in a field survey on Aug 28, 1996, do hereby state that under requirements of P.A. 74, Michigan P.A. of 1970, the corner points mentioned in lines 1 and 2 above were in conformance with regulations and rules therefore as required in the current manual of survey instructions of the United States Department of the Interior, Bureau of Land Management or by a decree of a Court of Law and/or that the corner points mentioned in lines 3, 4 and 5 above were in conformance with the rules of the Michigan Board of Land Surveyors or by a Decree of a Court of Law, established, re-established, monumented, recovered, found as expressed below:

A	B	C	D	E	F	G	H	I	J	K	L	M
1												
2	6	5	4	3	2	1						
3												
4	7	8	9	10	11	12						
5												
6	18	17	16	15	14	13						
7												
8	19	20	21	22	23	24						
9												
10	30	29	28	27	26	25						
11												
12	31	32	33	34	35	36						
13												

NOTE: Not more than 2 corners, all in the same town and range, may be recorded on this certificate.

- A. Description of original monument and accessories and/or subsequent restoration:
- 1848: Original Survey by John Mullett - B.T.'s - Cedar, 3" - N02°W - 06 lks; Cedar, 8" - S16°W - 20 lks. All original evidence for this corner has been destroyed by county road improvements.
  - 1976: Certified Survey No. 65, recorded by George B. Wilson, RLS No. 17607, shows this corner as it relates to other corners in Section 17, T33N-R27W. The corner monument is not described and no B.T.'s are given.
  - 1981: Certified Survey No. 228 recorded by William Lenca, RLS No. 26461, shows this corner as it relates to other corners in Section 20, T33N-R27W, and is described in the legend as "Concrete Monument found in place." No B.T.'s are given.
  - 1990: Certified Survey No. 705 recorded by William Lenca, RLS No. 26461, shows this corner as it relates to other corners in Section 17, T33N-R27W (Sec. Subd.) No corner monument is described and no B.T.'s are given.

B. Description of corner evidence found and/or method applied in restoring or reestablishing corner:

The concrete monument which existed in 1981 had been destroyed by county road improvements. We re-established the position of the concrete monument from recorded ties to corners North - South - East and West as shown in Certified Survey No.'s 228 and 705. This corner has been used as control for Certified Survey No.'s 65, 484, 566, and 596 as well as the 2 mentioned in part "A" and other unrecorded "Plat of Survey's", and is accepted as the best available evidence of the position of the original corner.

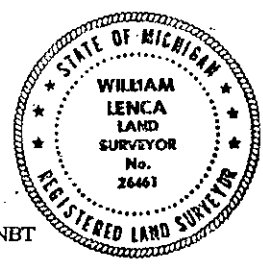

- C. Description of monument for corner and accessories established to perpetuate locating the position of the corner:
- Set 2" dia. Aluminum Pipe/3-1/4" dia. Alum cap stamped for corner location:
- |   |       |            |                       |
|---|-------|------------|-----------------------|
| 16" dia. Blue Spruce  | S30°E | 53.87 feet | Ser. NBT              |
| 5/8" x 24" Iron Rod/2" dia. Alum. cap marked "WITNESS MARKER" | South | 32.92 feet |                       |
| 6" dia. Elm   | N28°W | 38.49 feet | Ser. NBT              |
| 5/8" x 24" Iron Rod/2" dia. Alum. cap marked "WITNESS MARKER" | S67°W | 98.52 feet | 7.3' NE of Power Pole |
| Metal Survey Sign Post  | South | 33.4 feet  |                       |

NOTE: All bearings are magnetic bearings. All distances are measured with steel tape. Distances to trees are to nail in side of tree.

Signed by William Lenca Date Nov. 20, 1996  
Surveyor's Michigan License No. 26461

401