

SURVEY & REMONUMENTATION

APR 11 1995

LAND CORNER RECORDATION CERTIFICATE

COMMISSION

Meeting Requirement of Act 74, Mich. P.A. 1970

Approved by Menominee County
Land Survey Remonumentation
Peer Group Under Act 345 Of
P.A. Of 1990 On 1219 199 94

For corners in
MENOMINEE
(County)

Located In:

Corner Code #

- | | | |
|------------------------------------|---------------------------|------------|
| 1. Public Land Survey | T <u>33N</u> R <u>27W</u> | <u>E-4</u> |
| | T _____ R _____ | _____ |
| | T _____ R _____ | _____ |
| | T _____ R _____ | _____ |
| 2. Property Controlling in Section | S _____ T _____ R _____ | _____ |
| | S _____ T _____ R _____ | _____ |
| 3. Miscellaneous Property in Sec. | S _____ T _____ R _____ | _____ |
| | S _____ T _____ R _____ | _____ |

ACTING Chairman
PAGE # 92 BK 4
94 DEC 12 AM 8:56
RECEIVED FOR RECORD
BARBARA MORRISON
REGISTER OF DEEDS
MENOMINEE IN 1993
Register of Deeds Stamp & File Number

4. Lot No. _____, Recorded Plat _____
5. Private Claims _____

A	B	C	D	E	F	G	H	I	J	K	L	M
2	6	5	4	3	2	1						
3												
4	7	8	9	10	11	12						
5												
6	18	17	16	15	14	13						
7												
8	19	20	21	22	23	24						
9												
10	30	29	28	27	26	25						
11												
12	31	32	33	34	35	36						
13												

I, William Lenca in a field survey on July 06, 1994
do hereby certify that under requirements of P.A. 74, Michigan P.A. of 1970, the corner points mentioned in lines 1 and 2 above were in conformance with regulations and rules therefore as required in the current manual of survey instructions of the United States Department of the Interior, Bureau of Land Management or by a decree of a Court of Law and/or that the corner points mentioned in lines 3, 4 and 5 above were in conformance with the rules of the Michigan Board of Land Surveyors or by a Decree of a Court of Law; established, re-established, monumented, re-monumented, recovered, found as expressed below:

NOTE: Not more than 4 corners, all in the same town and range, may be recorded on this certificate.

- A. Description of original monument and accessories and/or subsequent restoration:
- 1848: Original Survey by John Mullett - B.T.'s - Hemlock, 18", N15°W, 10 lks & Hemlock, 16", S32°W, 14 lks. All original evidence for this corner location has been destroyed by county road improvements.
 - 1980: Certified Survey No. 183 recorded by George B. Wilson, RLS No. 17607 - No description of the corner monument is given.
 - 1981: Certified Survey No. 223 recorded by George B. Wilson, RLS No. 17607 - No description of the corner monument is given.

- B. Description of corner evidence found and/or method applied in restoring or reestablishing corner:
- A 1/2 inch diameter iron pin with an identification cap marked RLS 17607 was found in a location indicated by Certified Survey No. 183 as being on line and midway between corners E-3 and E-5 and falls 32.4 feet East of the centerline of County Road No. 577. This corner location has been used in surveys over the past 14 years, and is accepted as a careful and faithful re-establishment of the position of the original corner.

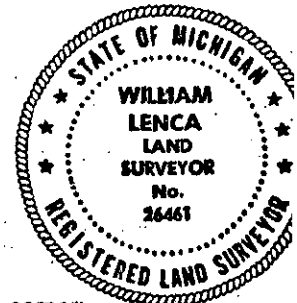

- C. Description of monument for corner and accessories established to perpetuate locating the position of the corner:
- Set Berntsen AINBF30 (Notched Base) Aluminum Monument stamped for corner location:
- | | | | |
|--------------------|-------|------------|----------|
| 9" dia. Twin Cedar | N09°E | 15.63 feet | Scr. NBT |
| 6" dia. Cedar | N57°E | 28.74 feet | Scr. NBT |
| 6" dia. Cedar | S57°E | 10.28 feet | Scr. NBT |
| 8" dia. Cedar | S09°W | 21.62 feet | Scr. NBT |
| Survey Sign Post | S80°W | 2.0 feet | |

NOTE: All bearings are magnetic bearings. All distances are measured with steel tape. Distances to trees are to nail in side of tree.

Signed by William Lenca Date July 09, 1994
Surveyor's Michigan License No. 26461

92