

LAND CORNER RECORDATION CERTIFICATE
Filing Requirement of Act 74, Mich. P.A. 1970

Approved by Menominee County
Land Survey Remonumentation
Peer Group Under Act 345 Of
P.A. Of 1990 On 12/12, 1996

For corners in

<u>MENOMINEE</u> (County)	Located in:	Corner Code #
1. Public Land Survey	T <u>33N</u> R <u>R27W</u>	<u>E08</u>
	T _____ R _____	_____
	T _____ R _____	_____
	T _____ R _____	_____
2. Property Controlling in Section	S _____ T _____ R _____	_____
	S _____ T _____ R _____	_____
3. Miscellaneous Property in Sec.	S _____ T _____ R _____	_____
	S _____ T _____ R _____	_____

Chairman
Mr. Dravin RLS
DEC 20 PM 9:55
403, E08

Register of Deeds Stamp & File Number

4. Lot No. _____, Recorded Plat _____
5. Private Claims _____

I, William Lenca, in a field survey on Scp. 10, 1996 do hereby state that under requirements of P.A. 74, Michigan P.A. of 1970, the corner points mentioned in lines 1 and 2 above were in conformance with regulations and rules therefore as required in the current manual of survey instructions of the United States Department of the Interior, Bureau of Land Management or by a decree of a Court of Law and for that the corner points mentioned in lines 3, 4 and 5 above were in conformance with the rules of the Michigan Board of Land Surveyors or by a Decree of a Court of Law; established, re-established, monumented, recovered, found as expressed below:

A	B	C	D	E	F	G	H	I	J	K	L	M
1												
2	6	5	4	3	2	1						
3												
4	7	8	9	10	11	12						
5												
6	18	17	16	15	14	13						
7												
8	19	20	21	22	23	24						
9												
10	30	29	28	27	26	25						
11												
12	31	32	33	34	35	36						
13												

NOTE: Not more than 2 corners, all in the same town and range, may be recorded on this certificate.

A. Description of original monument and accessories and/or subsequent restoration:

- 1848: Original Survey by John Mullett - B.T.'s - Hemlock, 10" - S12°W - 10 lks; Hemlock, 11" - S72°E - 17 lks. No original evidence for this corner was recovered.
- 1983: Certified Survey No. 228, recorded by William Lenca, RLS No. 26461, shows this corner as it relates to other corners in Section 20, T33N-R27W (Partial Sec. Subd.). The corner monument is not described and no B.T.'s are given.

B. Description of corner evidence found and/or method applied in restoring or reestablishing corner:

We recovered a 3/4 inch diameter iron pipe at an ancient fence corner - fences run North - South - East and West from this location. Field notes in my office indicate that we set a 3/4 inch diameter iron pipe at the intersection of fences North - South and East - West and fits reasonably well with GLO calls to swamp edges 4 chains North and 6.5 chains South. This corner location was subsequently used in many surveys since 1981, and is accepted as the best available evidence of the position of the original corner.

C. Description of monument for corner and accessories established to perpetuate locating the position of the corner:
Set 2" dia. Aluminum Pipe/3-1/4" dia. Alum cap stamped for corner location:

7" dia. Maple	N53°E	13.57 feet	Scr. NBT
7" dia. Maple	S31°E	68.53 feet	Scr. NBT
8" dia. Maple	S42°W	18.75 feet	Scr. NBT
8" dia. Maple	N23°W	58.89 feet	Scr. NBT
Metal Survey Sign Post	S05°E	1.2 feet	

NOTE: All bearings are magnetic bearings. All distances are measured with steel tape. Distances to trees are to nail in side of tree.

Signed by William Lenca
Surveyor's Michigan License No. 26461

Date Nov. 20, 1996

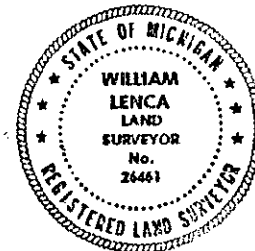

403