

SURVEY & REMONUMENTATION

LAND CORNER RECORDATION CERTIFICATE

Filing Requirement of Act 74, Mich. P.A. 1970

Approved by Menominee County
Land Survey Remonumentation
Peer Group Under Act 345 Of

P.A. Of 1990 On 12/19 19994

Mc Davis BLS
Chairman

RECEIVED FOR RECORD
94 DEC 12 AM 9:00
PAGE # 119 BK 4
BARBARA MORRISON
REGISTER OF DEEDS
MENOMINEE MI 490658

Register of Deeds Stamp & File Number

For corners in
MENOMINEE
(County)

APR 1 1 1995

COMMISSION

Located In:

Corner Code #

- | | | |
|------------------------------------|---------------------------|-------------|
| 1. Public Land Survey | T <u>33N</u> R <u>27W</u> | <u>E-11</u> |
| | T _____ R _____ | _____ |
| | T _____ R _____ | _____ |
| | T _____ R _____ | _____ |
| 2. Property Controlling in Section | S _____ T _____ R _____ | _____ |
| | S _____ T _____ R _____ | _____ |
| 3. Miscellaneous Property in Sec. | S _____ T _____ R _____ | _____ |
| | S _____ T _____ R _____ | _____ |

4. Lot No. _____, Recorded Plat _____
5. Private Claims _____

William Lenca

May 26

94

I, _____, in a field survey on _____, 19____, do hereby certify that under requirements of P.A. 74, Michigan P.A. of 1970, the corner points mentioned in lines 1 and 2 above were in conformance with regulations and rules therefore as required in the current manual of survey instructions of the United States Department of the Interior, Bureau of Land Management or by a decree of a Court of Law and/or that the corner points mentioned in lines 3, 4 and 5 above were in conformance with the rules of the Michigan Board of Land Surveyors or by a Decree of a Court of Law; established, re-established, monumented, re-monumented, recovered, found as expressed below:

NOTE: Not more than 4 corners, all in the same town and range, may be recorded on this certificate.

A	B	C	D	E	F	G	H	I	J	K	L
2	6	5	4	3	2	1					
3											
4	7	8	9	10	11	12					
5											
6	18	17	16	15	14	13					
7											
8	19	20	21	22	23	24					
9											
10	30	29	28	27	26	25					
11											
12	31	32	33	34	35	36					
13											

A. Description of original monument and accessories and/or subsequent restoration:

1852: Original Survey by John Mullett - B.T.'s - Black Ash, 12" - S27°E - 10 lks; Black Ash, 12" - S45°W - 24 lks

1893: A.L. Hillis, a Surveyor from Marinette, Wisconsin, set a 1-1/2" square iron bar 40" long from an original B.T. His field book is on record in the City of Marinette Engineers Office.

1975: L.C.R.C. No. 109 by George B. Wilson, RLS No. 17607, states that he found a 1-1/4" square iron bar as described above - B.T.'s - 12" Twin Cedar - 18° Azm - 45.5'; 6" W. Ash - 132° Azm - 21.8'; 3" W. Ash - 192° Azm - 26.4'; 5" Ash - 242° Azm - 29.5'.

B. Description of corner evidence found and/or method applied in restoring or reestablishing corner:

We recovered the 1-1/2" square iron bar 40" long as described above, 1' below the surface of the centerline of an East-West County Road. We also recovered the stumps of 2 of the B.T.'s mentioned in L.C.R.C. No. 109 (12" Twin Cedar - 18° Azm - 45.5'; 6" W. Ash - 132° Azm - 21.8). Since A.L. Hillis set the 1-1/2" square iron bar from original evidence, we accepted his monument as a careful and faithful perpetuation of the position of the original corner.

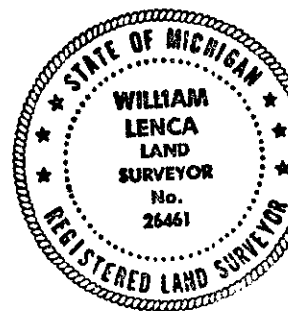

C. Description of monument for corner and accessories established to perpetuate locating the position of the corner:

Set 2-1/2" dia. Alum. Pipe 30" long/3-1/4" dia. Alum. cap stamped for corner location: (Berntsen Mon. - Notched Base)

12" dia. Twin Cedar	N18°E	45.70 feet	Scr. NBT
8" dia. White Ash	S51°E	21.50 feet	Scr. NBT
9" dia. White Ash	S35°W	18.25 feet	Scr. NBT
9" dia. White Ash	N49°W	61.57 feet	Scr. NBT
5/8" x 24" Iron Rod at Survey Sign Post	North	33.10 feet	

NOTE: All bearings are magnetic bearings. All distances are measured with steel tape. Distances to trees are to nail in side of tree.

Signed by William Lenca

Date Sep. 26, 1994

Surveyor's Michigan License No. 26461