

1993

COMMISSION

LAND CORNER RECORDATION CERTIFICATE  
Filing Requirement of Act 74, Mich. P.A. 1970

Approved by Menominee County  
Land Survey Remonumentation  
Peer Group Under Act 345 Of  
P.A. Of 1990 On 12/28 199 93

Chairman  
RECEIVED FOR RECORD  
93 DEC 29 PM 3:52  
PAGE # 14  
BARBARA MORRISON  
REGISTER OF DEEDS  
MENOMINEE, MI 49858

Register of Deeds Stamp & File Number

For corners in

MENOMINEE  
(County)

Located In:

Corner Code -#

- 1. Public Land Survey T 32N R 27W F-1 (F-13-33/27)
- T \_\_\_\_\_ R \_\_\_\_\_
- T \_\_\_\_\_ R \_\_\_\_\_
- T \_\_\_\_\_ R \_\_\_\_\_
- 2. Property Controlling S \_\_\_\_\_ T \_\_\_\_\_ R \_\_\_\_\_
- in Section S \_\_\_\_\_ T \_\_\_\_\_ R \_\_\_\_\_
- 3. Miscellaneous S \_\_\_\_\_ T \_\_\_\_\_ R \_\_\_\_\_
- Property in Sec. S \_\_\_\_\_ T \_\_\_\_\_ R \_\_\_\_\_
- 4. Lot No. \_\_\_\_\_, Recorded Plat \_\_\_\_\_
- 5. Private Claims \_\_\_\_\_

A	B	C	D	E	F	G	H	I	J	K	L	M
2	6	5	4	3	2							
3												
4	7	8	9	10	11	12						
5												
6	18	17	16	15	14	13						
7												
8	19	20	21	22	23	24						
9												
10	30	29	28	27	26	25						
11												
12	31	32	33	34	35	36						
13												

I, William Lenca, in a field survey on September, 1993, do hereby certify that under requirements of P.A. 74, Michigan P.A. of 1970, the corner points mentioned in lines 1 and 2 above were in conformance with regulations and rules theretore as required in the current manual of survey instructions of the United States Department of the Interior, Bureau of Land Management or by a decree of a Court of Law and/or that the corner points mentioned in lines 3, 4 and 5 above were in conformance with the rules of the Michigan Board of Land Surveyors or by a Decree of a Court of Law; established, re-established, monumented, re-monumented, recovered, found as expressed below:

NOTE: Not more than 4 corners, all in the same town and range, may be recorded on this certificate.

A. Description of original monument and accessories and/or subsequent restoration:

ORIGINAL B.T.'s:

- Cedar, 12", N23°E, 21 lks
- Tamarack, 14", N60°W, 6 lks

Original Survey by James H. Mullett in 1848. All original evidence for this corner has been destroyed by county road improvements.

PERPETUATION: William Lenca in 1987, recorded in LCRC Book 3, page 751

B. Description of corner evidence found and/or method applied in restoring or reestablishing corner:

Found 5/8" x 24" Iron Pin/Ident. cap set on line and midway between the Northeast Corner and the Northwest Corner of Section 4, and is accepted as the best available evidence of the position of the original corner.

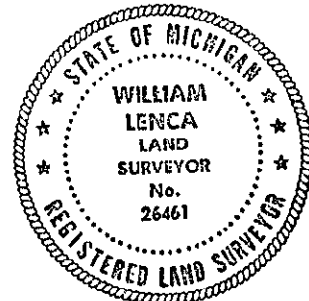

C. Description of monument for corner and accessories established to perpetuate locating the position of the corner:

Set 5/8" x 24" Iron Rod/3/4" dia. Alum. cap stamped for corner in Monument Box:

- 7" dia. White Ash N18°E 31.28 feet
- 5" dia. Ironwood S41°W 65.30 feet
- 5" dia. White Ash N72°W 51.31 feet
- 5/8" x 24" Iron Rod/2" dia. Alum. cap (WITNESS MARKER) S06°W 29.82 feet
- Survey Sign Post S06°W 30.0 feet

NOTE: All bearings are magnetic bearings; distances are measured with steel tape. distances to trees are measured to nail in side of tree.

Signed by William Lenca Date December 2, 1993  
Surveyor's Michigan License No. 26461