

Mc Swain RLS
Chairman

LAND CORNER RECORDATION CERTIFICATE
Filing Requirement of Act 74, Mich. P.A. 1970

For corners in

<u>MENOMINEE</u> (County)	Located In:	Corner Code #
1. Public Land Survey	T <u>33N</u> R <u>27W</u>	<u>G02</u>
	T <u> </u> R <u> </u>	<u> </u>
	T <u> </u> R <u> </u>	<u> </u>
	T <u> </u> R <u> </u>	<u> </u>
2. Property Controlling in Section	S <u> </u> T <u> </u> R <u> </u>	<u> </u>
	S <u> </u> T <u> </u> R <u> </u>	<u> </u>
3. Miscellaneous Property in Sec.	S <u> </u> T <u> </u> R <u> </u>	<u> </u>
	S <u> </u> T <u> </u> R <u> </u>	<u> </u>

96 DEC 30 AM 9:09
BARBARA MORTON
REGISTERED PROFESSIONAL
SURVEYOR
No. 26461

Register of Deeds Stamp & File Number

4. Lot No. _____, Recorded Plat _____
5. Private Claims _____

A	B	C	D	E	F	G	H	I	J	K	L	M
1												
2	6	5	4	3	2	1						
3												
4	7	8	9	10	11	12						
5												
6	18	17	16	15	14	13						
7												
8	19	20	21	22	23	24						
9												
10	30	29	28	27	26	25						
11												
12	31	32	33	34	35	36						
13												

I, William Lenca, in a field survey on Dec. 04, 1996, do hereby state that under requirements of P.A. 74, Michigan P.A. of 1970, the corner points mentioned in lines 1 and 2 above were in conformance with regulations and rules therefore as required in the current manual of survey instructions of the United States Department of the Interior, Bureau of Land Management or by a decree of a Court of Law and/or that the corner points mentioned in lines 3, 4 and 5 above were in conformance with the rules of the Michigan Board of Land Surveyors or by a Decree of a Court of Law, established, re-established, monumented, recovered, found as expressed below.

NOTE: Not more than 2 corners, all in the same town and range, may be recorded on this certificate.

A. Description of original monument and accessories and/or subsequent restoration:

- 1848: Original Survey by John Mullett - B.T.'s - Black Ash, 10" - S21°E - 06 lks.; Cedar, 9" - S81°W - 08 lks. No original evidence for this corner was recovered.
1981: L.C.R.C. No. 297 by George B. Wilson, RLS No. 17607, states "No evidence of original corner - Re-set using single proportion." Set 4" square conc. Monument - B.T.'s: 2" Cedar - 45° Azm - 8.8'; 2" Cedar - 240° Azm - 10.8'. Also shows a section breakdown for Section 4 on back of certificate.

B. Description of corner evidence found and/or method applied in restoring or reestablishing corner:

We recovered a 4 inch square concrete monument in location matching closely with a single proportional location between the Northeast Corner (G-1) and the Southeast Corner (G-3) of Section 4, as shown in L.C.R.C. No. 297. This corner has been accepted and used by local surveyors for over 15 years, and is accepted as a careful and faithful perpetuation of the position of the original corner.

C. Description of monument for corner and accessories established to perpetuate locating the position of the corner:
Set 3 1/4" Alum. cap on existing 4" square concrete monument:

5" dia. Cedar	S55°E	8.59 feet	Scr. NBT
8" dia. Elm	S18°E	38.04 feet	Scr. NBT
12" dia. Tamarack	S55°W	15.64 feet	Scr. NBT
7" dia. Tamarack	N19°W	34.14 feet	Scr. NBT
Metal Survey Sign Post	N45°W	1.20 feet	

NOTE: All bearings are magnetic bearings. All distances are measured with steel tape. Distances to trees are to nail in side of tree.

Signed by William Lenca
Surveyor's Michigan License No. 26461

Date Dec. 19, 1996

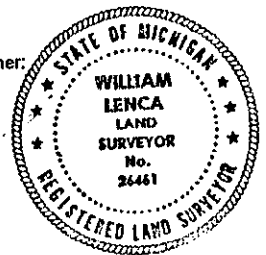

472