

LAND CORNER RECORDATION CERTIFICATE
Filing Requirement of Act 74, Mich. P.A. 1970

Approved by Menominee County
 Land Survey Remonumentation
 Peer Group Under Act 345 Of
 P.A. of 1990 On 12/12 1996

For corners in

<u>MENOMINEE</u> (County)	Located In:	Corner Code #
1. Public Land Survey	T <u>33N</u> R <u>27W</u>	<u>G07</u>
	T ___ R ___	_____
	T ___ R ___	_____
	T ___ R ___	_____
2. Property Controlling in Section	S ___ T ___ R ___	_____
	S ___ T ___ R ___	_____
3. Miscellaneous Property in Sec.	S ___ T ___ R ___	_____
	S ___ T ___ R ___	_____

Chairman
 DEC 20, AM 9:35
 397, BK 4
 REGISTER OF DEEDS
 MENOMINEE COUNTY

Register of Deeds Stamp & File Number

4. Lot No. _____, Recorded Plat _____
 5. Private Claims _____

I, William Lenca, in a field survey on Nov 12, 1996 do hereby state that under requirements of P.A. 74, Michigan P.A. of 1970, the corner points mentioned in lines 1 and 2 above were in conformance with regulations and rules therefore as required in the current manual of survey instructions of the United States Department of the Interior, Bureau of Land Management or by a decree of a Court of Law and/or that the corner points mentioned in lines 3, 4 and 5 above were in conformance with the rules of the Michigan Board of Land Surveyors or by a Decree of a Court of Law; established, re-established, monumented, recovered, found as expressed below:

NOTE: Not more than 2 corners, all in the same town and range, may be recorded on this certificate.

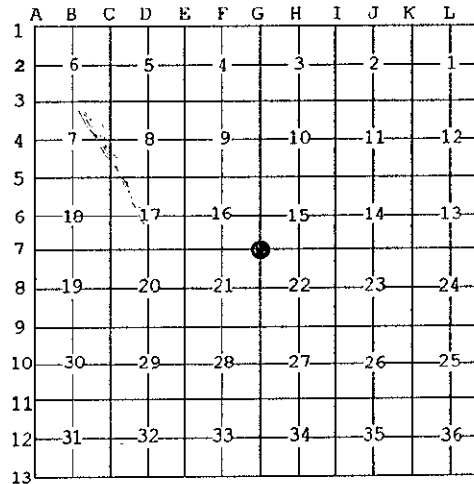

A. Description of original monument and accessories and/or subsequent restoration:

- 1848: Original Survey by John Mullett - B.T.'s - Tamarack, 14" - S67°E - 15 lks; Tamarack, 17" - S39°W - 18 lks. No original evidence for this corner was recovered.
- 1983: L.C.R.C. No. 554 by George B. Wilson, RLS No. 17607, states "Testimony from Emil Danielson, resident of 76 years, saw a square cedar post 35 years ago 8 feet North of the Blueberry Marsh, into the swamp. This location is relatively easy to determine for a N - S location. Set on line with W1/4 Cor. & NW Cor of Section 15, 33/27." Set HDR Alum. Berntsen Mon. - TIES: Deep-1 Magnets - SW 6.50feet & SE 5.00 feet.
- 1983: Certified Survey No. 373 by George B. Wilson, RLS No. 17607, shows this corner as it relates to other corners in Sections 15 & 22 (Sec. Subd.'s).

B. Description of corner evidence found and/or method applied in restoring or reestablishing corner:

We found a 3/4 inch diameter aluminum rod with a 3-1/4 inch diameter aluminum cap in proper location as indicated by measurements recorded in Certified Survey No. 373. This corner has been used by local surveyors for control in several surveys in this area, and is accepted as the best available evidence of the position of the original corner.

C. Description of monument for corner and accessories established to perpetuate locating the position of the corner:
 Accepted existing 3/4" dia. Aluminum Rod/3-1/4" dia. Alum cap stamped for corner location:

6" dia. Tamarack	N80°E	17.33 feet	Scr. NBT
7" dia. Tamarack	S20°E	13.45 feet	Scr. NBT
6" dia. Tamarack	S51°W	18.50 feet	Scr. NBT
6" dia. Tamarack	N28°W	17.14 feet	Scr. NBT
Metal Survey Sign Post	South	1.1 feet	

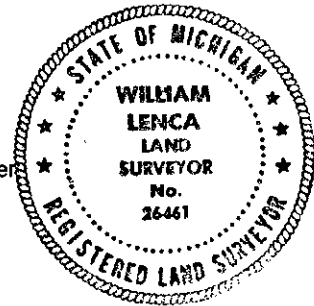

NOTE: All bearings are magnetic bearings. All distances are measured with steel tape. Distances to trees are to nail in side of tree.

Signed by William Lenca
 Surveyor's Michigan License No. 26461

Date Nov. 21, 1996