

LAND CORNER RECORDATION CERTIFICATE
Filing Requirement of Act 74, Mich. P.A. 1970

Approved by Menominee County
Land Survey Remuneration
Peer Group Under Act 345 Of
P.A. of 1990 On 12/11/96 1996

For corners in

<u>MENOMINEE</u> (County)	Located in:	Corner Code #
1. Public Land Survey	T <u>33N</u> R <u>27W</u>	<u>H-3</u>
	T <u> </u> R <u> </u>	<u> </u>
	T <u> </u> R <u> </u>	<u> </u>
	T <u> </u> R <u> </u>	<u> </u>
2. Property Controlling in Section	S <u> </u> T <u> </u> R <u> </u>	<u> </u>
	S <u> </u> T <u> </u> R <u> </u>	<u> </u>
3. Miscellaneous Property in Sec.	S <u> </u> T <u> </u> R <u> </u>	<u> </u>
	S <u> </u> T <u> </u> R <u> </u>	<u> </u>

Chairman
95 DEC 20 AM 9:3
BASE # 421, BK 5
REGISTER OF DEEDS
Register of Deeds Stamp & File Number

4. Lot No. _____, Recorded Plat _____
5. Private Claims _____

I, William Lenca, in a field survey on Jun 05, 1996 do hereby state that under requirements of P.A. 74, Michigan P.A. of 1970, the corner points mentioned in lines 1 and 2 above were in conformance with regulations and rules therefore as required in the current manual of survey instructions of the United States Department of the Interior, Bureau of Land Management or by a decree of a Court of Law and /or that the corner points mentioned in lines 3, 4 and 5 above were in conformance with the rules of the Michigan Board of Land Surveyors or by a Decree of a Court of Law; established, re-established, monumented, recovered, found as expressed below:

NOTE: Not more than 2 corners, all in the same town and range, may be recorded on this certificate.

A	B	C	D	E	F	G	H	I	J	K	L	M
1												
2	6	5	4				3		2		1	
3							●					
4	7	8	9				10		11		12	
5												
6	10	17	16	15	14	13						
7												
8	19	20	21	22	23	24						
9												
10	30	29	28	27	26	25						
11												
12	31	32	33	34	35	36						
13												

A. Description of original monument and accessories and/or subsequent restoration:

- 1847: Original Survey by John Mullett - B.T.'s - Spruce, 6" - N56°E - 16 lks; Spruce, 6" - S65°W - 06 lks. All original evidence for this corner has been destroyed by logging activities.
- 1984: Certified Survey No. 381, recorded by George B. Wilson, RLS No. 17607, shows this corner as it relates to other corners in Section 3, T33N-R27W. The corner monument is not described and no B.T.'s are given.

B. Description of corner evidence found and/or method applied in restoring or reestablishing corner:

In a retracement of the South Line of Section 3, T33N-R27W, we found a "Deep-1 Magnet" set on line and midway between the Southeast Corner (G-3) and the Southwest Corner (I-3) of said Section 3. This location matches that recorded in Certified Survey No. 381, and is typical of the type of corner monument set by George B. Wilson, RLS No. 17607. This corner location has been used for control in several surveys in this area, and is accepted as a careful and faithful reestablishment of the position of the original corner.

C. Description of monument for corner and accessories established to perpetuate locating the position of the corner:

- Set 2" dia. Aluminum Pipe/3-1/4" dia. Alum cap stamped for corner location:
- | | | | |
|------------------------|-------|------------|----------|
| 5" dia. Cedar | N00°E | 42.35 feet | Scr. NBT |
| 14" Tamarack | N73°E | 93.98 feet | Scr. NBT |
| 8" dia. Tamarack | S46°E | 69.38 feet | Scr. NBT |
| 8" dia. Cedar | S30°W | 50.75 feet | Scr. NBT |
| Metal Survey Sign Post | North | 22.4 feet | |
| County Road centerline | South | 10.6 feet | |

NOTE: All bearings are magnetic bearings. All distances are measured with steel tape. Distances to trees are to nail in side of tree.

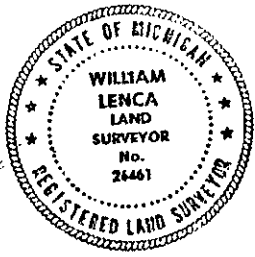

Signed by William Lenca Date Nov. 22, 1996
Surveyor's Michigan License No. 26461

421