

Approved by Menominee County
 Land Survey Remonumentation
 Peer Group Under Act 345 Of
 P.A. Of 1990 On 10/26 199 95
Mc Dawk RLS
 Chairman

LAND CORNER RECORDATION CERTIFICATE
 Filing Requirement of Act 74, Mich. P.A. 1970

For corners in
MENOMINEE
 (County)

Located In: Corner Code: J-1
 33N 27W
 1. Public Land Survey T ___ R ___
 T ___ R ___
 T ___ R ___
 T ___ R ___
 2. Property Controlling S ___ T ___ R ___
 in Section S ___ T ___ R ___
 3. Miscellaneous S ___ T ___ R ___
 Property in Sec. S ___ T ___ R ___

RECEIVED FOR RECORD
 95 NOV - 8 AM 11: 29
 PAGE # 214 BK 4
 BARBARA M. HARRISON
 REGISTER OF DEEDS
 MENOMINEE, MICH. 49853

Register of Deeds Stamp & File Number

4. Lot No. _____, Recorded Plat _____
 5. Private Claims _____
 (SAME AS J-13 T34N-R27W)

| | | | | | | | | | | | | | |
|----|----|----|----|----|----|----|---|---|---|---|---|---|---|
| | A | B | C | D | E | F | G | H | I | J | K | L | M |
| 2 | 6 | 5 | 4 | 3 | 2 | 1 | | | | | | | |
| 3 | | | | | | | | | | | | | |
| 4 | 7 | 8 | 9 | 10 | 11 | 12 | | | | | | | |
| 5 | | | | | | | | | | | | | |
| 6 | 16 | 17 | 16 | 15 | 14 | 13 | | | | | | | |
| 7 | | | | | | | | | | | | | |
| 8 | 19 | 20 | 21 | 22 | 23 | 24 | | | | | | | |
| 9 | | | | | | | | | | | | | |
| 10 | 30 | 29 | 28 | 27 | 26 | 25 | | | | | | | |
| 11 | | | | | | | | | | | | | |
| 12 | 31 | 32 | 33 | 34 | 35 | 36 | | | | | | | |
| 13 | | | | | | | | | | | | | |

William Lenca in a field survey on Oct. 24 1995
 do hereby certify that under requirements of P.A. 74, Michigan P.A. of 1970, the corner points mentioned in lines 1 and 2 above were in conformance with regulations and rules therefore as required in the current manual of survey instructions of the United States Department of the Interior, Bureau of Land Management or by a decree of a Court of Law and/or that the corner points mentioned in lines 3, 4 and 5 above were in conformance with the rules of the Michigan Board of Land Surveyors or by a Decree of a Court of Law; established, re-established, monumented, re-monumented, recovered, found as expressed below:

NOTE: Not more than 4 corners, all in the same town and range, may be recorded on this certificate.

A. Description of original monument and accessories and/or subsequent restoration:

- 1848: Original Survey by James H. Mullett - B.T.'s - Fir, 6" - N40°E - 14 lks; Cedar, 6" - N08°W - 25 lks. All original evidence for this corner has been destroyed by county road improvements.
- 1981: Certified Survey No. 215 by William Lenca, RLS No. 26461, shows this corner in relation to other corners in Section 35, T34N-R27W. No corner monument is shown or described and no corner ties are shown.
- 1982: Certified Survey No. 303 by G. B. Wilson, RLS No. 17607, shows this corner in relation to other corners in Section 35, T34N-R27W. No corner monument is shown or described and no corner ties are shown.

B. Description of corner evidence found and/or method applied in restoring or reestablishing corner:

In a 1983 survey in Section 35, T34N-R27W, we set a 5/8" x 24" iron rod with plastic identification cap on line and midway between the SE Corner and SW Corner of said Section 35, in accordance with information shown on Certified Survey No.s 215 and 303. In April of 1995, we recovered this corner and accepted the position as a careful and faithful reestablishment of the position of the original corner.

C. Description of monument for corner and accessories established to perpetuate locating the position of the corner:

Set 2-1/2" dia. Alum. Pipe 30" long/3-1/4" dia. Alum. cap stamped for corner location:

| | | | |
|------------------|-------|------------|----------|
| 6" dia. Cedar | S64°E | 28.25 feet | Scr. NBT |
| 16" dia. Cedar | S59°W | 25.92 feet | Scr. NBT |
| 14" dia. Cedar | N03°W | 48.64 feet | Scr. NBT |
| 4" dia. Cedar | S08°E | 24.50 feet | Scr. NBT |
| Survey Sign Post | South | 10.8 feet | |

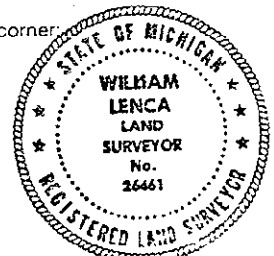

NOTE: All bearings are magnetic bearings. All distances are measured with steel tape. Distances to trees are to nail in side of tree.

Signed by William Lenca Date Oct. 24, 1995
 Surveyor's Michigan License No. 26461