

LAND CORNER RECORDATION CERTIFICATE  
 Filing Requirement of Act 74, Mich. P.A. 1970

For corners in

MENOMINEE  
 (County)

Located In:

Corner Code J-3

- |                                    |                           |       |
|------------------------------------|---------------------------|-------|
| 1. Public Land Survey              | T <u>33N</u> R <u>27W</u> | _____ |
|                                    | T _____ R _____           | _____ |
|                                    | T _____ R _____           | _____ |
|                                    | T _____ R _____           | _____ |
| 2. Property Controlling in Section | S _____ T _____ R _____   | _____ |
|                                    | S _____ T _____ R _____   | _____ |
| 3. Miscellaneous Property in Sec.  | S _____ T _____ R _____   | _____ |
|                                    | S _____ T _____ R _____   | _____ |

RECEIVED FOR RECORD  
 95 NOV - 8 AM 11: 29  
 PAGE 215 BR 4  
 BARBARA WILKINSON  
 REGISTERED LAND SURVEYOR  
 MENOMINEE, MICHIGAN

Register of Deeds Stamp & File Number

4. Lot No. \_\_\_\_\_, Recorded Plat \_\_\_\_\_  
 5. Private Claims \_\_\_\_\_

William Lenca, in a field survey on Scp. 01, 1995, do hereby certify that under requirements of P.A. 74, Michigan P.A. of 1970, the corner points mentioned in lines 1 and 2 above were in conformance with regulations and rules therefore as required in the current manual of survey instructions of the United States Department of the Interior, Bureau of Land Management or by a decree of a Court of Law and/or that the corner points mentioned in lines 3, 4 and 5 above were in conformance with the rules of the Michigan Board of Land Surveyors or by a Decree of a Court of Law; established, re-established, monumented, re-monumented, recovered, found as expressed below:

A	B	C	D	E	F	G	H	I	J	K	L	M
2	6	5	4	3	2	1						
3									●			
4	7	8	9	10	11	12						
5												
6	18	17	16	15	14	13						
7												
8	19	20	21	22	23	24						
9												
10	30	29	28	27	26	25						
11												
12	31	32	33	34	35	36						
13												

NOTE: Not more than 4 corners, all in the same town and range, may be recorded on this certificate.

A. Description of original monument and accessories and/or subsequent restoration:

- 1848: Original Survey by John H. Mullett - B.T.'s - Hemlock, 12" - N67°W - 17 lks; Hemlock, 6" - N67°E - 08 lks. All original evidence for this corner has been destroyed by county road improvements.
- 1985: L.C.R.C. No. 713 recorded by William Lenca, RLS No. 26461, states a large spike was found in the center of Co. Rds running E - W and N - S. A 1/2" x 18" iron rod was set at this location. Tics: Power Pole - S34°E - 42.82'; Anchor Pole - N48°W - 41.48'; NE Cor. of House - S60°W - 104.60'.

3. Description of corner evidence found and/or method applied in restoring or reestablishing corner:

In 1992, this corner and the two power pole ties were destroyed by county road re-construction. Prior to the re-construction activity, we took new ties to the corner as follows: Cherry Stump - NE - 77.16 feet; New Power Pole - SE - 47.60 feet; NE Corner of House - S60°W - 104.60 feet. In September of 1995, we recovered these new ties and found a P.K. nail in the centerline of County Road Intersection which matches these ties. This corner location was accepted as the best available evidence of the position of the original corner.

2. Description of monument for corner and accessories established to perpetuate locating the position of the corner:

Set 5/8" x 24" Iron Rod/3-1/4" dia. Alum. cap stamped for corner location in Monument Box:

5/8" x 24" Iron Rod/2" cap marked WITNESS MARKER	N57°E	49.78 feet
5/8" x 24" Iron Rod/2" cap marked WITNESS MARKER	S44°E	45.92 feet
5/8" x 24" Iron Rod/2" cap marked WITNESS MARKER	N46°W	47.33 feet
Metal Survey Sign Post	S44°E	46.1 feet

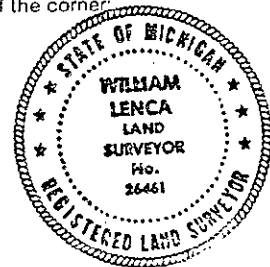

NOTE: All bearings are magnetic bearings. All distances are measured with steel tape.

Signed by William Lenca Date Oct. 20, 1995  
 Surveyor's Michigan License No. 26461

SURVEY & SEALS  
 DEC 1 1995