

SURVEY & REMONUMENTATION

APR 1 1 1995

LAND CORNER RECORDATION CERTIFICATE
Filing Requirement of Act 74, Mich. P.A. 1970

Approved by Menominee County
Land Survey Remonumentation
Peer Group Under Act 345 Of
P.A. Of 1990 On 12/19 199 94
McLANKI RLS
ACTING Chairman

For corners in COMMISSION
MENOMINEE
(County)

	Located In:	Corner Code #
1. Public Land Survey	T <u>33N</u> R <u>27W</u>	<u>K-12</u>
	T _____ R _____	_____
	T _____ R _____	_____
	T _____ R _____	_____
2. Property Controlling in Section	S _____ T _____ R _____	_____
	S _____ T _____ R _____	_____
3. Miscellaneous Property in Sec.	S _____ T _____ R _____	_____
	S _____ T _____ R _____	_____
4. Lot No. _____, Recorded Plat _____		
5. Private Claims _____		

RECEIVED FOR RECORD
94 DEC 12 AM 9:00
PAGE # 138-84-1
BARBARA MORRISON
REGISTER OF DEEDS
MENOMINEE MI 14868
Register of Deeds Stamp & File Number

	A	B	C	D	E	F	G	H	I	J	K	L
2	6	5	4	3	2	1						
3												
4	7	8	9	10	11	12						
5												
6	18	17	16	15	14	13						
7												
8	19	20	21	22	23	24						
9												
10	30	29	28	27	26	25						
11												
12	31	32	33	34	35	36						
13												

William Lenca Oct. 04 19 94

I, _____, in a field survey on _____, 19 _____ do hereby certify that under requirements of P.A. 74, Michigan P.A. of 1970, the corner points mentioned in lines 1 and 2 above were in conformance with regulations and rules therefore as required in the current manual of survey instructions of the United States Department of the Interior, Bureau of Land Management or by a decree of a Court of Law and/or that the corner points mentioned in lines 3, 4 and 5 above were in conformance with the rules of the Michigan Board of Land Surveyors or by a Decree of a Court of Law; established, re-established, monumented, re-monumented, recovered, found as expressed below:

NOTE: Not more than 4 corners, all in the same town and range, may be recorded on this certificate.

A. Description of original monument and accessories and/or subsequent restoration:

- 1848: Original Survey by John Mullett - B.T.'s - Birch, 10" - N90°E - 73 lks; Birch, 4" - N19°W - 07 lks. All original evidence for this corner has been destroyed by county road improvements.
- 1887: F.J. Merrian, Deputy Surveyor, re-established this corner in a survey of section 36. No description of the corner monument is given, and no new B.T.'s are given.
- 1973: L.C.R.C. No. 64 by George B. Wilson, RLS No. 17607 - states that he set a 2" galvanized iron pipe 30" long - SEE BACK.

B. Description of corner evidence found and/or method applied in restoring or reestablishing corner:

We recovered the 2" dia. x 30" galvanized iron pipe and crosses in 2 large rocks as described in L.C.R.C. No. 64 (see part "A" above). The corner falls 25' South of an East-West county road and 14 feet Southeast of the centerline of a county road running Northeasterly. This corner position has been accepted and used for many years, and is accepted as the best available evidence of the position of the original corner.

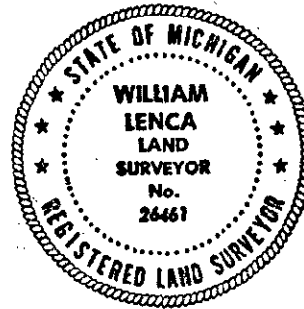

C. Description of monument for corner and accessories established to perpetuate locating the position of the corner:

Accepted 2" dia. galvanized iron pipe 30" long/2" Brass cap stamped for corner location:

4" chiseled on large rock (Existing)	S82°E	36.82 feet	
4" chiseled on large rock (Existing)	S30°E	16.52 feet	
16" dia. Norway Pine	S15°W	36.28 feet	Scr. NBT
5/8" x 24" Iron Rod/Ident. cap	N90°W	63.85 feet	
Survey Sign Post	S45°E	15.7 feet	

NOTE: All bearings are magnetic bearings. All distances are measured with steel tape. Distances to trees are to nail in side of tree.

Signed by William Lenca Date Nov. 29, 1994
Surveyor's Michigan License No. 26461