

Approved by Menominee County  
 Land Survey Remonumentation  
 Peer Group Under Act 345 Of  
 P.A. Of 1990 On 10/26 19995  
Wm. Lenca RLS  
 Chairman

LAND CORNER RECORDATION CERTIFICATE  
 Filing Requirement of Act 74, Mich. P.A. 1970

For corners in  
MENOMINEE  
 (County)  
 Located in: 33N 27W Corner Code #4 L-1  
 1. Public Land Survey T \_\_\_ R \_\_\_  
 T \_\_\_ R \_\_\_  
 T \_\_\_ R \_\_\_  
 T \_\_\_ R \_\_\_  
 2. Property Controlling in Section S \_\_\_ T \_\_\_ R \_\_\_  
 S \_\_\_ T \_\_\_ R \_\_\_  
 3. Miscellaneous Property in Sec. S \_\_\_ T \_\_\_ R \_\_\_  
 S \_\_\_ T \_\_\_ R \_\_\_

RECEIVED FOR RECORD  
 95 NOV - 8 AM 11:30  
 PAGE # 222 BK 4  
 BARGAINING COMMISSION  
 REGISTERED OFFICES  
 HERBERT H. FERGUSON

Register of Deeds Stamp & File Number

4. Lot No. \_\_\_\_\_, Recorded Plat \_\_\_\_\_  
 5. Private Claims \_\_\_\_\_  
 (SAME AS L-13 T34N-R27W)

A	B	C	D	E	F	G	H	I	J	K	L	M
2	6	5	4	3	2	1						
3												
4	7	8	9	10	11	12						
5												
6	18	17	16	15	14	13						
7												
8	19	20	21	22	23	24						
9												
10	30	29	28	27	26	25						
11												
12	31	32	33	34	35	36						
13												

William Lenca, in a field survey on Oct. 24 1995, do hereby certify that under requirements of P.A. 74, Michigan P.A. of 1970, the corner points mentioned in lines 1 and 2 above were in conformance with regulations and rules therefore as required in the current manual of survey instructions of the United States Department of the Interior, Bureau of Land Management or by a decree of a Court of Law and/or that the corner points mentioned in lines 3, 4 and 5 above were in conformance with the rules of the Michigan Board of Land Surveyors or by a Decree of a Court of Law; established, re-established, monumented, re-monumented, recovered, found as expressed below:

NOTE: Not more than 4 corners, all in the same town and range, may be recorded on this certificate.

A. Description of original monument and accessories and/or subsequent restoration.

- 1848: Original Survey by James H. Mullett - B.T.'s - Aspen, 12", N65°E, 18 lks. Fir, 12", N28°W, 15 lks. All original evidence has been destroyed by logging activities.
- 1981: L.C.R.C. No. 293 by William Lenca, RLS No. 26461, states that the corner was " Set by extending line between the SW Corner and the W 1/16 Corner on the South Line of Section 1 and doubling this distance. Found rotted remains of squared wood post at a fence corner at above mentioned W 1/16 Corner. Set 4" x 4" Concrete Monument - TIES: 6" W. Birch - S16°W - 27.60 feet; 8" W. Birch - N53°W - 21.30 feet; 11" W. Birch - N55°E - 28.23 feet.

B. Description of corner evidence found and/or method applied in restoring or reestablishing corner:

We found a 4" x 4" concrete monument and 3 White Birch B.T.'s as described in part "A" above. The White Birch B.T.'s are in poor condition, since White Birch Trees in this area are diseased and dying. This corner position fits well with the section corners 1/2 mile East and 1/2 mile West of this position, and is accepted as the best available evidence of the position of the original corner.

C. Description of monument for corner and accessories established to perpetuate locating the position of the corner.

Accepted 4" x 4" x 36" Concrete Monument - set 3-1/4" Alum. cap stamped for corner:

8" dia. Balsam	N16°E	35.98 feet	Scr. NBT
9" dia. Balsam	N66°E	26.55 feet	Scr. NBT
10" dia. Maple	S14°E	47.08 feet	Scr. NBT
8" dia. Maple	S71°W	33.07 feet	Scr. NBT
Metal Survey Sign Post	North	1.2 feet	

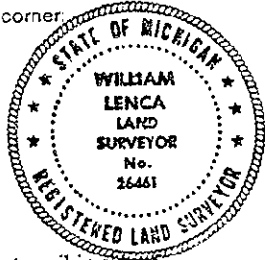

NOTE: All bearings are magnetic bearings. All distances are measured with a steel tape. Distances to trees are to nail in side of tree.

Signed by William Lenca Date Oct. 24, 1995  
 Surveyor's Michigan License No. 26461