

LAND CORNER RECORDATION CERTIFICATE
Filing Requirement of Act 74, Mich. P.A. 1970

For corners in

<u>MENOMINEE</u> (County)	Located in:	Corner Code #
1. Public Land Survey	T <u>33</u> N R <u>27</u> W	<u>L-7</u>
	T <u> </u> R <u> </u>	<u> </u>
	T <u> </u> R <u> </u>	<u> </u>
	T <u> </u> R <u> </u>	<u> </u>
2. Property Controlling in Section	S <u> </u> T <u> </u> R <u> </u>	<u> </u>
	S <u> </u> T <u> </u> R <u> </u>	<u> </u>
3. Miscellaneous Property in Sec.	S <u> </u> T <u> </u> R <u> </u>	<u> </u>
	S <u> </u> T <u> </u> R <u> </u>	<u> </u>

RECEIVED FOR RECORD
95 DEC 27 PM 3:29
PAGE # 269 BK 4
BANGS & BANGS
REGISTERED LAND SURVEYORS
MEMPHIS, TN 38103

Register of Deeds Stamp & File Number

4. Lot No. _____, Recorded Plat _____
5. Private Claims _____

I, William Lenca, in a field survey on Oct 30, 1995 do hereby state that under requirements of P.A. 74, Michigan P.A. of 1970, the corner points mentioned in lines 1 and 2 above were in conformance with regulations and rules therefore as required in the current manual of survey instructions of the United States Department of the Interior, Bureau of Land Management or by a decree of a Court of Law and/or that the corner points mentioned in lines 3, 4 and 5 above were in conformance with the rules of the Michigan Board of Land Surveyors or by a Decree of a Court of Law, established, re-established, monumented, recovered, found as expressed below.

NOTE: Not more than 2 corners, all in the same town and range, may be recorded on this certificate.

A	B	C	D	E	F	G	H	I	J	K	L	M
1												
2	6	5	4	3	2	1						
3												
4	7	8	9	10	11	12						
5												
6	18	17	16	15	14	13						
7												
8	19	20	21	22	23	24						
9												
10	30	29	28	27	26	25						
11												
12	31	32	33	34	35	36						
13												

A. Description of original monument and accessories and/or subsequent restoration:

- 1848: Original Survey by John H. Mullett - B.T.'s - Hemlock, 8" - S41°E - 5 lks; Hemlock, 6" - N12°W - 11 lks. All original evidence has been destroyed by farming and clearing activities.
- 1979: Certified Survey No. 158 by George B. Wilson, RLS No. 17607, shows this corner as it relates to other corners in Section 24, T33N-R27W. The corner is described as a concrete monument. No corner ties are given.
- 1983: Certified Survey No. 371 by George B. Wilson, RLS No. 17607, shows this corner as it relates to other corners in Sections 13 and 24, T33N-R27W. The corner monument is not described and no ties are given.

B. Description of corner evidence found and/or method applied in restoring or reestablishing corner:

In our 1995 remonumentation survey in T33N-R27W, we located and tied in the NW Corner and NE Corner of Section 24, T33N-R27W. We located the position for corner L-7 (N1/4 Corner of Section 24) and found that the concrete monument had been bulldozed out. We then set the corner at a proportional distance between corners, and at a distance South of a straight line as shown in Wilson's Certified Survey No. 371. This position fits with ancient fence lines running East and North from this location. This corner position has been accepted and used by local surveyors for 16 years, and is accepted as the best available evidence of the position of the original corner.

C. Description of monument for corner and accessories established to perpetuate locating the position of the corner:
Set 2" dia. Aluminum Pipe/3-1/4" dia. Alum cap stamped for corner location:

12" dia. White Ash	N06°W	36.83 feet	Scr. NBT
10" dia. Maple	S40°E	51.66 feet	Scr. NBT
6" dia. Maple	S56°W	55.59 feet	Scr. NBT
14" dia. Maple	West	29.71 feet	Scr. NBT
Metal Survey Sign Post	N45°W	5.4 feet	

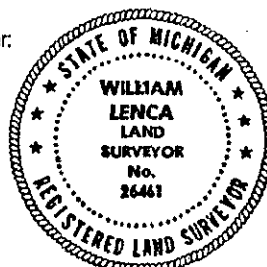

NOTE: All bearings are magnetic bearings. All distances are measured with a steel tape. Distances to trees are to nail in side of tree.

Signed by William Lenca
Surveyor's Michigan License No. 26461

Date Dec. 11, 1995