

P.A. of 1990 On 12/20 1999
William Lenca
Chairman

LAND CORNER RECORDATION CERTIFICATE
Filing Requirement of Act 74, Mich. P.A. 1970

For corners in

<u>MENOMINEE</u> (County)	Located In:	Corner Code #
1. Public Land Survey	T <u>33N</u> R <u>27W</u>	<u>M-2</u>
	T <u> </u> R <u> </u>	<u> </u>
	T <u> </u> R <u> </u>	<u> </u>
	T <u> </u> R <u> </u>	<u> </u>
2. Property Controlling in Section	S <u> </u> T <u> </u> R <u> </u>	<u> </u>
	S <u> </u> T <u> </u> R <u> </u>	<u> </u>
3. Miscellaneous Property in Sec.	S <u> </u> T <u> </u> R <u> </u>	<u> </u>
	S <u> </u> T <u> </u> R <u> </u>	<u> </u>

RECEIVED FOR RECORD
95 DEC 27 PM 3:29
PAGE 270
BARBARA JOHNSON
REGISTERED DEEDS
MENOMINEE COUNTY

Register of Deeds Stamp & File Number

4. Lot No. _____, Recorded Plat _____
5. Private Claims _____
(SAME A02 T33N-R26W)

1	A	B	C	D	E	F	G	H	I	J	K	L
2		6		5		4		3		2		1
3												
4		7		8		9		10		11		12
5												
6		10		17		16		15		14		13
7												
8		19		20		21		22		23		24
9												
10		30		29		28		27		26		25
11												
12		31		32		33		34		35		36
13												

I, William Lenca, in a field survey on Sep. 27, 1995 do hereby state that under requirements of P.A. 74, Michigan P.A. of 1970, the corner points mentioned in lines 1 and 2 above were in conformance with regulations and rules therefore as required in the current manual of survey instructions of the United States Department of the Interior, Bureau of Land Management or by a decree of a Court of Law and /or that the corner points mentioned in lines 3, 4 and 5 above were in conformance with the rules of the Michigan Board of Land Surveyors or by a Decree of a Court of Law; established, re-established, monumented, recovered, found as expressed below.

NOTE: Not more than 2 corners, all in the same town and range, may be recorded on this certificate.

A. Description of original monument and accessories and/or subsequent restoration:

1848: Original Survey by John H. Mullett - B.T.'s - W. Pine, 12", N35° W, 35 lks. Lynn, 14", S30° W, 43 lks. All original evidence has been destroyed by county road improvements.

1981: L.C.R.C. No. 302 by William Lenca, RLS No. 26461, states that a 5/8" dia. Iron Rod was found from information contained in a 1953 survey by Keith Roberts, Surveyor, on record with the Menominee County Road Commission. TIES: 30" dia. White Pine - N50°E - 67.22'; 24" W. Pine - S48°E - 51.21'; Power Pole - N20°W - 74.94'.

B. Description of corner evidence found and/or method applied in restoring or reestablishing corner:

In our 1995 remonumentation survey, we recovered a 5/8" diameter iron rod and ties as described in L.C.R.C. No. 302. (See part "A"). The corner position falls 2 feet East of the centerline of a North - South County Road and in line with an ancient fence line to the West and the centerline of an old lane to the East. The tacks in the large White Pine trees from 1981 had been overgrown. We set 8d nails in the sides of the trees and took new distances as shown in part "C" below. This corner has been used by local surveyors for several years, and is accepted as the best available evidence of the position of the original corner.

C. Description of monument for corner and accessories established to perpetuate locating the position of the corner:
Set 5/8" x 24" Iron Rod/3-1/4" dia. Alum. cap stamped for corner location in Monument Box:

30" dia. White Pine	N50°E	67.62 feet
24" dia. White Pine	S48°E	51.32 feet
5/8" x 24" Iron Rod/2" dia. Alum. cap marked "WITNESS MARKER"	N80°W	25.91 feet
Metal Survey Sign Post	N80°W	26.4 feet

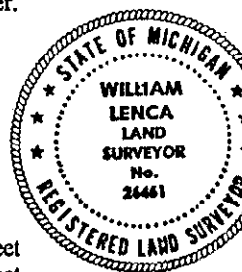

NOTE: All bearings are magnetic bearings. All distances are measured with a steel tape. Distances to trees are to nail in side of tree.

Signed by William Lenca
Surveyor's Michigan License No. 26461

Date Nov. 24, 1995