

LAND CORNER RECORDATION CERTIFICATE  
Filing Requirement of Act 74, Mich. P.A. 1970

McDermott RLS  
Chairman

For corners in  
MENOMINEE  
(County)

1. Public Land Survey	T <u>33</u> N R <u>28</u> W	<u>L-09</u>
	T ___ R ___	_____
	T ___ R ___	_____
	T ___ R ___	_____
2. Property Controlling in Section	S ___ T ___ R ___	_____
	S ___ T ___ R ___	_____
3. Miscellaneous Property in Sec.	S ___ T ___ R ___	_____
	S ___ T ___ R ___	_____

4. Lot No. \_\_\_\_\_, Recorded Plat \_\_\_\_\_  
5. Private Claims \_\_\_\_\_

RECEIVED FOR RECORD  
97 JUL 23 PM 3:34  
PAGE # 487, RLS  
BARBARA MORRISON  
REGISTER OF DEEDS  
MENOMINEE, MI 49858  
Register of Deeds Stamp & File Number

I, William Lenca, in a field survey on July 09, 1997 do hereby state that under requirements of P.A. 74, Michigan P.A. of 1970, the corner points mentioned in lines 1 and 2 above were in conformance with regulations and rules therefore as required in the current manual of survey instructions of the United States Department of the Interior, Bureau of Land Management or by a decree of a Court of Law and for that the corner points mentioned in lines 3, 4 and 5 above were in conformance with the rules of the Michigan Board of Land Surveyors or by a Decree of a Court of Law; established, re-established, monumented, recovered, found as expressed below:

NOTE: Not more than 2 corners, all in the same town and range, may be recorded on this certificate.

A	B	C	D	E	F	G	H	I	J	K	L	M
1												
2	5		5		4		3		2		1	
3												
4	7		8		9		10		11		12	
5												
6	10		11		12		13		14		15	
7												
8	19		20		21		22		23		24	
9												
10	30		29		28		27		26		25	
11												
12	31		32		33		34		35		36	
13												

A. Description of original monument and accessories and/or subsequent restoration:

- 1848: Original Survey by John Mullett - B.T.'s - Birch, 4" - S38°W - 18 lks.; Fir, 4" - N72°W - 16 lks. All original evidence for this corner has been destroyed by county road improvements.
- 1901: Survey by Albert Hass, Menominee County Surveyor, states "set 4" Cedar post from Government B.T." (Destroyed by County Road Improvements.)
- 1995: CERTIFIED SURVEY No. 855 recorded by William Lenca, RLS No. 26461, describes this corner as a Railroad Spike with the following witnesses: 14" W. Ash - N28°W - 41.31'; 5/8" x 24" Iron Rod/2" dia. Alum cap - S46°E - 37.43'; 5/8" x 24" Iron Rod/2" dia. Alum cap 1.5' NE of Power Pole - S26°W - 43.23'; 5/8" x 24" Iron Rod/2" dia. Alum cap 1' SE of Anchor Pole - N40°W - 41.87'.

B. Description of corner evidence found and/or method applied in restoring or reestablishing corner:

We found a Railroad Spike and witnesses as described in Certified Survey No. 855 (See part A). The Railroad Spike was found in the centerline of a County Road running East - West and in line with an old lane running North. An old fence line 1/4 mile West falls half way between this corner and the Section Corner to Sections 23, 24, 25 and 26 (K-9). The position of the Railroad Spike was accepted as the best available evidence of the position of the original corner.

C. Description of monument for corner and accessories established to perpetuate locating the position of the corner:

Sct 5/8" x 24" Iron Rod/3-1/4" dia. Alum. cap stamped for corner location in Monument Box:			
14" dia. White Ash	N28°E	41.31 feet	Ser. NBT
5/8" x 24" Iron Rod/2" dia. Alum. cap marked "WITNESS MARKER"	S46°E	37.43 feet	
5/8" x 24" Iron Rod/2" dia. Alum. cap marked "WITNESS MARKER"	S26°W	43.23 feet	1.5' NE of Power Pole
7" dia. White Ash	N27°W	41.38 feet	Ser. NBT
Metal Survey Sign Post	S45°E	48.5 feet	

NOTE: All bearings are magnetic bearings. All distances are measured with steel tape. Distances to trees are to nail in side of tree.

Signed by William Lenca Date July 14, 1997  
Surveyor's Michigan License No. 26461

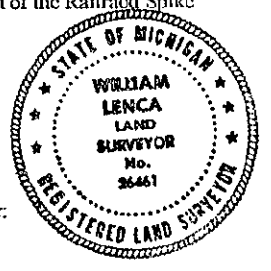

REMONUMENTATION

DEC 22 1997  
COMMISSION

487