

SURVEY & REMONUMENTATION

FEB 11 1998

Approved by Menominee County
Land Survey Remonumentation
Peer Group Under Act 345 Of
P.A. Of 1990 On 12/18, 1997
McAnis RLS
Chairman

SECTION

LAND CORNER RECORDATION CERTIFICATE
Filing Requirement of Act 74, Mich. P.A. 1970

For corners in
MENOMINEE
(County)

Located In: Corner Code #

1. Public Land Survey

T 34N R 27W M-07
T ___ R ___
T 34R 26 A-07 ✓
T ___ R ___

2. Property Controlling in Section

S ___ T ___ R ___

3. Miscellaneous Property in Sec.

S ___ T ___ R ___
S ___ T ___ R ___

97 DEC 22 11:29
PAGE # 608, BKS
BARBARA MOORESON
REGISTERED SURVEYOR

Register of Deeds Stamp & File Number

4. Lot No. _____, Recorded Plat _____
5. Private Claims _____
(SAME AS CORNER A-07, T34N - R26W)

I, William Lenca, in a field survey on July 02, 1997 do hereby state that under requirements of P.A. 74, Michigan P.A. of 1970, the corner points mentioned in lines 1 and 2 above were in conformance with regulations and rules therefore as required in the current manual of survey instructions of the United States Department of the Interior, Bureau of Land Management or by a decree of a Court of Law and/or that the corner points mentioned in lines 3, 4 and 5 above were in conformance with the rules of the Michigan Board of Land Surveyors or by a Decree of a Court of Law; established, re-established, monumented, recovered, found as expressed below:

NOTE: Not more than 2 corners, all in the same town and range, may be recorded on this certificate.

A	B	C	D	E	F	G	H	I	J	K	L	M
1												
2	6	5	4	3	2	1						
3												
4	7	8	9	10	11	12						
5												
6	18	17	16	15	14	13						
7	19	20	21	22	23	24						
8												
9												
10	30	29	28	27	26	25						
11												
12	31	32	33	34	35	36						
13												

A. Description of original monument and accessories and/or subsequent restoration:

- 1847: Original Survey - Township Boundary - by H. Floyd - B.T.'s - Beech, 12" - N73°W - 29 lks.; Sugar, 12" - S37°W - 70 lks. All original evidence for this corner has been destroyed by county road improvements.
- 1848: Original Survey - Sectional Subdivision - by James H. Mullett - B.T.'s - Beech, 18" - N02°E - 27 lks.; Beech, 12" - S83°E - 28 lks. All original evidence for this corner has been destroyed by county road improvements.
- 1981: L.C.R.C. No. 322 by William Lenca states, "Set corner in line with county road centerlines north, south, and west, and in line with an ancient fence line to the east." Set 1/2" x 18" Iron/Ident. cap marked R.L.S. 26461. TIES: Anchor Pole (tack in side) - S57°W - 83.64'; Power Pole (tack in side) - N74°W - 107.32'; Southwest Corner of House - N38°E - 73.48'.
- 1989: C.S. No. 625 by William Lenca shows this corner in relation to other corners in Section 13, T34N - R27W.

B. Description of corner evidence found and/or method applied in restoring or reestablishing corner:

We recovered a 1/2 inch diameter iron rod in the centerline of County Roads North, South, West, and in line with a fence line to the East as indicated in Land Corner Recordation Certificate number 322. This position has been used by local surveyors for many years, matches existing lines of occupation, and is accepted as the best available evidence of the position of the original corner.

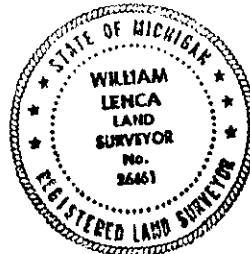

C. Description of monument for corner and accessories established to perpetuate locating the position of the corner:

Set 5/8" x 24" Iron Rod/3-1/4" dia. Alum. cap stamped for corner location in Monument Box:

Southwest Corner of House	N39°E	73.49 feet	
7" dia. White Ash	S20°E	56.42 feet	Scr. NBT
8" dia. White Ash	S29°W	85.79 feet	Scr. NBT
5/8" x 24" Iron Rod/2" dia. Alum. cap marked "WITNESS MARKER"	N42°W	63.41 feet	1.1' E. of Road Sign
Metal Survey Sign Post	N88°E	16.7 feet	

NOTE: All bearings are magnetic bearings. All distances are measured with steel tape. Distances to trees are to nail in side of tree.

Signed by William Lenca
Surveyor's Michigan License No. 26461

Date Dec. 12, 1997

608