

**SURVEY & REMONUMENTATION**

**JAN 09 2001**

**SECTION**

**LAND CORNER RECORDATION CERTIFICATE**  
Filing Requirement of Act 74, Mich. P.A. 1970

Approved by Menominee County  
Land Survey Remonumentation  
Peer Group Under Act 345 of  
P.A. of 1990 On 12/22, 2000  
W. Lenca  
Chairman

*Bk. 6 Pg. 236*

RECEIVED FOR RECORD  
28 DEC 2000 2:31:31 PM  
BARBARA MORRISON  
REGISTER OF DEEDS  
MENOMINEE, MI 49858

Register of Deeds Stamp & File Number

|  |                             |               |
|--|-----------------------------|---------------|
| For corners in<br><u>MENOMINEE</u><br>(County) | Located In:                 | Corner Code # |
| 1. Public Land Survey                          | T <u>35</u> N R <u>26</u> W | <u>H-13</u>   |
|  | T ___ R ___                 | _____         |
|  | T ___ R ___                 | _____         |
|  | T ___ R ___                 | _____         |
| 2. Property Controlling<br>in Section          | S ___ T ___ R ___           | _____         |
|  | S ___ T ___ R ___           | _____         |
| 3. Miscellaneous<br>Property in Sec.           | S ___ T ___ R ___           | _____         |
|  | S ___ T ___ R ___           | _____         |

4. Lot No. \_\_\_\_\_, Recorded Plat \_\_\_\_\_  
5. Private Claims \_\_\_\_\_

SAME AS CORNER H-1, T34N-R26W ✓

I, William Lenca, in a field survey on Dec., 1900 do hereby state that under requirements of P.A. 74, Michigan P.A. of 1970, the corner points mentioned in lines 1 and 2 above were in conformance with regulations and rules therefore as required in the current manual of survey instructions of the United States Department of the Interior, Bureau of Land Management or by a decree of a Court of Law and /or that the corner points mentioned in lines 3, 4 and 5 above were in conformance with the rules of the Michigan Board of Land Surveyors or by a Decree of a Court of Law; established, re-established, monumented, recovered, found as expressed below:

NOTE: Not more than 2 corners, all in the same town and range, may be recorded on this certificate.

A. Description of original monument and accessories and/or subsequent restoration:

1848: Original Survey by James H. Mullett - B.T.'s - Cedar, 6" - N65°W - 39 lks.; Spruce, 5" - N48°E - 60 lks. According to the Original Field Notes, this line was run on a 10 chain offset to the North and this corner was set on the offset line. This was most likely done due the extreme marsh and bog conditions in this area. No search was made for this corner.

B. Description of corner evidence found and/or method applied in restoring or reestablishing corner:

The original field notes indicate that this line was run on a 10 chain offset North of true line and the 1/4 corner was set at 40 chains, with the mile measuring 80 chains. We therefore set this corner at MPOL between the SW corner of Section 34 and the SE corner of Section 34. The corner falls on the South side of a creek, and is accepted as a careful and faithful reestablishment of the position of the original corner.

C. Description of monument for corner and accessories established to perpetuate locating the position of the corner:

Set 3/4" dia. x 4' long aluminum rod/3-1/4" dia. Alum. cap stamped for corner.

|                                       |       |             |          |
|---------------------------------------|-------|-------------|----------|
| 6" dia. Elm                           | North | 119.65 feet | Scr. NBT |
| 6" dia. Elm                           | N40°W | 149.51 feet | Scr. NBT |
| Metal Survey Sign Post                | South | 75.10 feet  |          |
| Nothing else nearby - all marsh & bog |       |             |          |

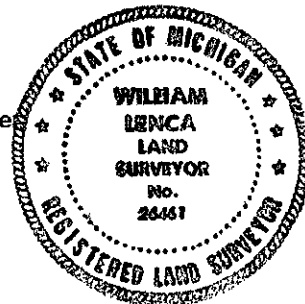

NOTE: All bearings are magnetic bearings. All distances are measured with steel tape. Distances to trees are to nail in side of tree.

Signed by William Lenca  
Surveyor's Michigan License No. 26461

Date Dec. 21, 2000