

APR 06 1999

SECTION

LAND CORNER RECORDATION CERTIFICATE
Filing Requirement of Act 74, Mich. P.A. 1970

Approved by Menominee County
Land Survey Remonumentation
Peer Group Under Act 345 Of
P.A. Of 1990 On 10/30, 1998
Mr. Davis RLS
Chairman

For corners in

MENOMINEE
(County)

Located In: Corner Code #

- 1. Public Land Survey T34N R 25W A-07
 T ___ R ___
 T ___ R ___
 T ___ R ___
- 2. Property Controlling S ___ T ___ R ___
 in Section S ___ T ___ R ___
- 3. Miscellaneous S ___ T ___ R ___
 Property in Sec. S ___ T ___ R ___

RECEIVED FOR RECORD
99 JAN -6 AM 8:57
PAGE # 744 BKS
BARBARA MORRISON
REGISTER OF DEEDS
MENOMINEE, MI 49858

Register of Deeds Stamp & File Number

4. Lot No. _____, Recorded Plat _____
5. Private Claims _____

(SAME AS CORNER M-07, T34N - R26W)

I, William Lenca, in a field survey on Dec. 15, 1998 do hereby state that under requirements of P.A. 74, Michigan P.A. of 1970, the corner points mentioned in lines 1 and 2 above were in conformance with regulations and rules therefore as required in the current manual of survey instructions of the United States Department of the Interior, Bureau of Land Management or by a decree of a Court of Law and/or that the corner points mentioned in lines 3, 4 and 5 above were in conformance with the rules of the Michigan Board of Land Surveyors or by a Decree of a Court of Law; established, re-established, monumented, recovered, found as expressed below:

NOTE: Not more than 2 corners, all in the same town and range, may be recorded on this certificate.

1	A	B	C	D	E	F	G	H	I	J	K	L	M
2		6		5		4		3		2		1	
3													
4		7		8		9		10		11		12	
5													
6		18		17		16		15		14		13	
7													
8		19		20		21		22		23		24	
9													
10		30		29		28		27		26		25	
11													
12		31		32		33		34		35		36	
13													

A. Description of original monument and accessories and/or subsequent restoration:

- 1847: Original Survey by John Mullett - B.T.'s - Cedar, 12" - N28°E - 15 lks.; Cedar, 6" - S50°E - 22 lks. All original evidence for this corner has been destroyed by logging activities.
- 1959: L.C.R.C. No. 8, Volume 2 by Billy D. Buckler states: "Replaced cor. at old Cedar post set by unknown party. This position has been used by residents of area for many years. Found no evidence of bearing trees." Set 1" Pipe with 4" Brass Cap. TIES: Cedar, 7" - N69°E - 16 lks.; Cedar, 7" - N21°W - 25 lks.; Cedar, 10" - S88°W - 16 lks.; Cedar, 7" - S17°E - 30 lks.

B. Description of corner evidence found and/or method applied in restoring or reestablishing corner:

We found a standard DNR Monument (1" dia. Iron pipe with 4" dia. cap) and 2 B.T.'s - Cedar 7" - N69°E - 16 lks and Cedar, 7" - S17°E - 30 lks - as described in L.C.R.C. No. 8, Volume 2. The monument was standing loosely in about 6 inches of muck and out of position. We replaced the corner in the correct position from the 2 existing B.T.'s. The other two B.T.'s are visible but fallen down. The measurement from this location East to the SE Corner of Section 18, T34N-R25W matches closely with the GLO distance. This location has been accepted by local residents and surveyors for many years and is accepted as the best available evidence of the position of the original corner.

C. Description of monument for corner and accessories established to perpetuate locating the position of the corner:

Accepted existing 1" x 36" Iron Pipe/4" dia. cap stamped for corner location:

- 10" dia. Cedar N69°E 10.65 feet Ex. B.T.
- 10" dia. Cedar S17°E 20.17 feet Ex. B.T.
- 14" dia. Cedar S68°W 24.10 feet "X" cut in upper & lower blazes
- 14" dia. Cedar N30°W 45.44 feet "X" cut in upper & lower blazes
- Metal Survey Sign Post West 1.0 feet

NOTE: All bearings are magnetic bearings. All distances are measured with steel tape. Distances to trees are to nail in side of tree.

Signed by William Lenca
Surveyor's Michigan License No. 26461

Date Dec. 22, 1998

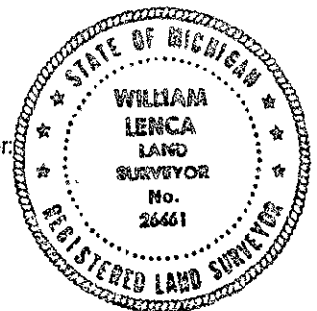

744