

APR 06 1999

Approved by Menominee County  
Land Survey Remonumentation  
Peer Group Under Act 345 Of

P.A. Of 1990 On 12/20, 1998

Mr. Davis RLS  
Chairman

RECEIVED FOR RECORD  
99 JAN -6 AM 8:54  
PAGE # 703 BK 5  
BARBARA MORRISON  
REGISTER OF DEEDS  
MENOMINEE, MI 49858

SECTION

LAND CORNER RECORDATION CERTIFICATE  
Filing Requirement of Act 74, Mich. P.A. 1970

For corners in

MENOMINEE

(County)

Located In:

Corner Code #

1. Public Land Survey	T <u>35</u> N R <u>28</u> W	H-13
	T <u>   </u> R <u>   </u>	<u>   </u>
	T <u>   </u> R <u>   </u>	<u>   </u>
	T <u>   </u> R <u>   </u>	<u>   </u>
2. Property Controlling in Section	S <u>   </u> T <u>   </u> R <u>   </u>	<u>   </u>
	S <u>   </u> T <u>   </u> R <u>   </u>	<u>   </u>
3. Miscellaneous Property in Sec.	S <u>   </u> T <u>   </u> R <u>   </u>	<u>   </u>
	S <u>   </u> T <u>   </u> R <u>   </u>	<u>   </u>

Register of Deeds Stamp & File Number

4. Lot No.    , Recorded Plat    

5. Private Claims    

(SAME AS CORNER H-01, T34N - R28W.)

I, William Lenca, in a field survey on Nov. 20, 19 98 do hereby state that under requirements of P.A. 74, Michigan P.A. of 1970, the corner points mentioned in lines 1 and 2 above were in conformance with regulations and rules therefore as required in the current manual of survey instructions of the United States Department of the Interior, Bureau of Land Management or by a decree of a Court of Law and /or that the corner points mentioned in lines 3, 4 and 5 above were in conformance with the rules of the Michigan Board of Land Surveyors or by a Decree of a Court of Law, established, re-established, monumented, recovered, found as expressed below:

NOTE: Not more than 2 corners, all in the same town and range, may be recorded on this certificate.

	A	B	C	D	E	F	G	H	I	J	K	L	M
1													
2		6		5		4		3		2		1	
3													
4		7		8		9		10		11		12	
5													
6		18		17		16		15		14		13	
7													
8		19		20		21		22		23		24	
9													
10		30		29		28		27		26		25	
11													
12		31		32		33		34		35		36	
13													

A. Description of original monument and accessories and/or subsequent restoration:

1848: Original Survey by H. Brevoort, Jr. - B.T.'s - Beech, 16" - N66°E - 25 lks.; Beech, 4" - N71°W - 49 lks. All original evidence for this corner has been destroyed by county road improvements.

B. Description of corner evidence found and/or method applied in restoring or reestablishing corner:

We set this corner in the centerline of an East - West county road and at the single proportionate distance between the Southeast corner of Section 34 and the Southwest corner of Section 33, T35N - R28W. This location is accepted as a careful and faithful re-establishment of the position of the original corner.

C. Description of monument for corner and accessories established to perpetuate locating the position of the corner:

Set 2" dia. Aluminum Pipe 30" long/3-1/4" dia. Alum. cap stamped for corner location:

9" dia. White Ash	N36°E	62.08 feet	"X" cut in upper & lower blazes
8" dia. White Spruce	S58°E	85.01 feet	"X" cut in upper & lower blazes
8" dia. Maple	South	29.64 feet	"X" cut in upper & lower blazes
9" dia. Maple	N22°W	61.51 feet	"X" cut in upper & lower blazes
Metal Survey Sign Post	North	32.0 feet	

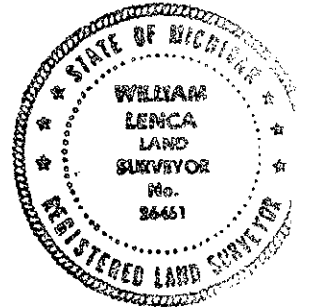

NOTE: All bearings are magnetic bearings. All distances are measured with steel tape. Distances to trees are to nail in side of tree.

Signed by William Lenca  
Surveyor's Michigan License No. 26461

Date Dec. 22, 1998