

LAND CORNER RECORDATION CERTIFICATE
Filing Requirement of Act 74, Mich. P.A. 1970

Approved by Menominee County
Land Survey Remuneration
Peer Group Under Act 345 Of
P.A. Of 1990 On 12/12 19996

For corners in

MENOMINEE Located In: Corner Code #
(County)

1. Public Land Survey T33N R27W B01
T34 R27 B-13
T R
2. Property Controlling S T R
in Section S T R
3. Miscellaneous S T R
Property in Sec. S T R

Mr. Davis RLS
Chairman
ARBAIRA MORTENSON
REGISTERED LAND SURVEYOR
No. 26461

RECEIVED FOR RECORDING
DEC 20 AM 9 36
414, BIC 4

Register of Deeds Stamp & File Number

4. Lot No. _____, Recorded Plat _____
5. Private Claims _____

SAME AS CORNER B-13 T34N-R27W

I, William Lenca, in a field survey on Jun 05, 1996 do hereby state that under requirements of P.A. 74, Michigan P.A. of 1970, the corner points mentioned in lines 1 and 2 above were in conformance with regulations and rules therefore as required in the current manual of survey instructions of the United States Department of the Interior, Bureau of Land Management or by a decree of a Court of Law and /or that the corner points mentioned in lines 3, 4 and 5 above were in conformance with the rules of the Michigan Board of Land Surveyors or by a Decree of a Court of Law; established, re-established, monumented, recovered, found as expressed below:

NOTE: Not more than 2 corners, all in the same town and range, may be recorded on this certificate.

A	B	C	D	E	F	G	H	I	J	K	L
1											
2	6		5		4		3		2		1
3											
4	7		8		9		10		11		12
5											
6	18		17		16		15		14		13
7											
8	19		20		21		22		23		24
9											
10	30		29		28		27		26		25
11											
12	31		32		33		34		35		36
13											

A. Description of original monument and accessories and/or subsequent restoration:

- 1847: Original Survey (Twp Bdy) by James H. Mullett - B.T.'s - Hemlock, 10" - N35°E - 20 lks; W. Pine, 18" - S56°W - 23 lks. All original evidence for this corner has been destroyed by clearing & gravel excavation.
- 1975: Certified Survey No. 23, recorded by George B. Wilson, RLS No. 17607, shows the North Line of Section 6, T33N-R27W from the NE Corner of said Section 6 to its intersection with River Road. The position of the N1/4 Corner is not shown.

B. Description of corner evidence found and/or method applied in restoring or reestablishing corner:

We used the information in Certified Survey No. 23 to establish the direction of the North Line of Section 6. We found a 5/8" diameter iron rod at the NE Corner of said Section and a railroad spike in the centerline of River Road. We found that this line paralleled the South Line of Section 6, and the distance between these two points matched with the distance shown in C.S. No. 23. Since Section 6 is a fractional Section with no NW Section Corner, we set the N1/4 Corner on the line as established in C.S. 23 and at a distance of 2640 feet West of the NE Corner of Section 6. We accepted this corner location as the best available evidence of the position of the original corner.

C. Description of monument for corner and accessories established to perpetuate locating the position of the corner:
Set 2" dia. Aluminum Pipe/3-1/4" dia. Alum cap stamped for corner location:

9" dia. Norway Pine	N60°E	46.56 feet	Scr. NBT
7" dia. White Ash	N50°W	91.09 feet	Scr. NBT
Carsonite Marker	North	1.0 feet	
Nothing else nearby			

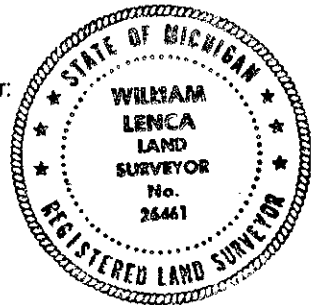

NOTE: All bearings are magnetic bearings. All distances are measured with steel tape. Distances to trees are to nail in side of tree.

Signed by William Lenca
Surveyor's Michigan License No. 26461

Date Nov. 18, 1996