

LAND CORNER RECORDATION CERTIFICATE
Filing Requirement of Act 74, Mich. P.A. 1970

Approved by Menominee County
Land Survey Remonumentation
Peer Group Under Act 345 Of
P.A. Of 1990 On 12/12 19996

For corners in

<u>MENOMINEE</u> (County)	Located In:	Corner Code #
1. Public Land Survey	T <u>33N</u> R <u>27W</u>	<u>CO1</u>
	T <u>34</u> R <u>27</u>	<u>C-13</u>
2. Property Controlling in Section	S <u> </u> T <u> </u>	<u> </u>
3. Miscellaneous Property in Sec.	S <u> </u> T <u> </u>	<u> </u>

Chairman
417, BR 4
DEC 20 AM 9:36
REGISTERED LAND SURVEYOR

Register of Deeds Stamp & File Number

4. Lot No. , Recorded Plat
5. Private Claims

SAME AS CORNER C-13 T34N-R27W

I, William Lenca, in a field survey on Jun 05, 1996 do hereby state that under requirements of P.A. 74, Michigan P.A. of 1970, the corner points mentioned in lines 1 and 2 above were in conformance with regulations and rules therefore as required in the current manual of survey instructions of the United States Department of the Interior, Bureau of Land Management or by a decree of a Court of Law and for that the corner points mentioned in lines 3, 4 and 5 above were in conformance with the rules of the Michigan Board of Land Surveyors or by a Decree of a Court of Law; established, re-established, monumented, recovered, found as expressed below:

NOTE: Not more than 2 corners, all in the same town and range, may be recorded on this certificate.

A	B	C	D	E	F	G	H	I	J	K	L
1		1									
2	6	5	4	3	2						
3											
4	7	8	9	10	11	1					
5											
6	10	17	16	15	14	1					
7											
8	19	20	21	22	23	2					
9											
10	30	29	28	27	26	2					
11											
12	31	32	33	34	35	3					
13											

A. Description of original monument and accessories and/or subsequent restoration:

- 1847: Original Survey (Twp Bdy) by James H. Mullett - B.T.'s - W. Pine, 18" - N69°E - 15 lks; W. Pine, 10" - N58°W - 10 lks. All original evidence for this corner has been destroyed by county road improvements.
- 1848: Original Survey (Sec. Subd.) by John Mullett - B.T.'s - W. Pine, 24" - S18°E - 22 lks; Sugar, 8" - S37°W - 24 lks. All original evidence for this corner has been destroyed by county road improvements.
- 1975: Certified Survey No. 23, recorded by George B. Wilson, RLS No. 17607, shows a tie to this corner. The corner monument is described in the legend as a 1/2" dia. iron re-bar.
- 1983: Certified Survey No. 362, recorded by George B. Wilson, RLS No. 17607, shows this corner as it relates to other corners in Section 32, T34N-R27W. The corner monument is not described and no B.T.'s are given.

B. Description of corner evidence found and/or method applied in restoring or reestablishing corner:

We recovered a 1/2 inch diameter iron rod in the centerline P.L. of a North - South County Road and in line with an ancient fence running East. The corner position fits with measurements to other corners as shown in Certified Survey No. 23 and Certified Survey No. 362, and is accepted as the best available evidence of the position of the original corner.

C. Description of monument for corner and accessories established to perpetuate locating the position of the corner:
Set 5/8" x 24" Iron Rod/3-1/4" dia. Alum. cap stamped for corner location:

12" dia. Maple	N28°E	91.41 feet	Scr. NBT
8" dia. Maple	N80°E	61.76 feet	Scr. NBT
8" dia. Maple	S70°W	48.42 feet	Scr. NBT
5" dia. Oak	N28°W	62.77 feet	Scr. NBT
Mctal Survey Sign Post	West	26.7 feet	

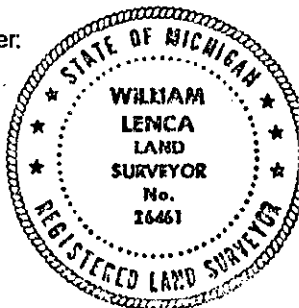

NOTE: All bearings are magnetic bearings. All distances are measured with steel tape. Distances to trees are to nail in side of tree.

Signed by William Lenca
Surveyor's Michigan License No. 26461

Date Nov. 18, 1996