

LAND CORNER RECORDATION CERTIFICATE
Filing Requirement of Act 74, Mich. P.A. 1970

Approved by Menominee County
Land Survey Remonumentation
Peer Group Under Act 345 Of
P.A. Of 1990 On 12/12 1996

For corners in

MENOMINEE
(County)

Located In:

Corner Code #

1. Public Land Survey

T33N R27W D01

T R

T34N R27W D-13

T R

2. Property Controlling
in Section

S T R

S T R

3. Miscellaneous
Property in Sec.

S T R

S T R

Chairman
96 DEC 20 AM 9:35
RECEIVED FOR RECORD
PAGE 405 BK 4
BARBARA NOTERSON
REGISTER OF DEEDS
MENOMINEE, MICHIGAN

Register of Deeds Stamp & File Number

4. Lot No. _____, Recorded Plat _____

5. Private Claims _____

SAME AS CORNER D-13 T34N-R27W

I, William Lenca, in a field survey on Nov. 13, 1996 do hereby state that under requirements of P.A. 74, Michigan P.A. of 1970, the corner points mentioned in lines 1 and 2 above were in conformance with regulations and rules therefore as required in the current manual of survey instructions of the United States Department of the Interior, Bureau of Land Management or by a decree of a Court of Law and /or that the corner points mentioned in lines 3, 4 and 5 above were in conformance with the rules of the Michigan Board of Land Surveyors or by a Decree of a Court of Law; established, re-established, monumented, recovered, found as expressed below:

NOTE: Not more than 2 corners, all in the same town and range, may be recorded on this certificate.

A	B	C	D	E	F	G	H	I	J	K	L
1											
2	6		5		4		3		2		1
3											
4	7		8		9		10		11		12
5											
6	18		17		16		15		14		13
7											
8	19		20		21		22		23		24
9											
10	30		29		28		27		26		25
11											
12	31		32		33		34		35		36
13											

A. Description of original monument and accessories and/or subsequent restoration:

1847: Original Survey (Twp Bdy) by James H. Mullett - B.T.'s - Hemlock, 15" - N46°E - 26 lks; Hemlock, 15" - N36°W - 34 lks. All original evidence for this corner has been destroyed by county road improvements.

1983: Certified Survey No. 362, recorded by George B. Wilson, RLS No. 17607, shows this corner as it relates to other corners in Section 32, T34N-R27W at a Midpoint on line position. The corner monument is not described and no B.T.'s are given.

B. Description of corner evidence found and/or method applied in restoring or reestablishing corner:

We established the single proportional position for this corner and found that it fell on an old East - West Fence Line. We searched this area and found no other evidence of the corner. We therefore set the corner at the single proportional location, as shown in Certified Survey No. 362, and accepted this location as a careful and faithful reestablishment of the position of the original corner.

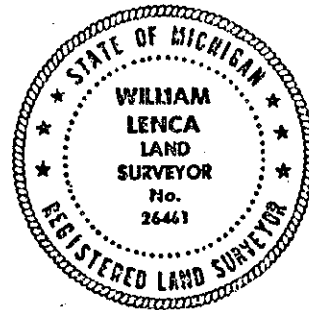

C. Description of monument for corner and accessories established to perpetuate locating the position of the corner:
Set 3/4" dia. Alum. Rod 5' long/3-1/4" dia. Alum. cap stamped for corner location:

9" dia. White Pine	N26°E	8.01 feet	"X" cut in upper & lower blaze
6" dia. Basswood	S66°E	13.37 feet	"X" cut in upper & lower blaze
6" dia. Ironwood	S20°W	11.87 feet	"X" cut in upper & lower blaze
5" dia. Ironwood	N68°W	16.13 feet	"X" cut in upper & lower blaze
Metal Survey Sign Post	South	0.8 feet	

NOTE: All bearings are magnetic bearings. All distances are measured with steel tape. Distances to trees are to nail in side of tree.

Signed by William Lenca
Surveyor's Michigan License No. 26461

Date Nov. 20, 1996