

LAND CORNER RECORDATION CERTIFICATE
 Filing Requirement of Act 74, Mich. P.A. 1970

For corners in
MENOMINEE
 (County)

Located In: Corner Code -##

1. Public Land Survey	T <u>35N</u> R <u>27W</u>	E-13
	T _____ R _____	
	T <u>34N</u> R <u>27W</u>	<u>E-1</u>
	T _____ R _____	
2. Property Controlling in Section	S _____ T _____ R _____	
	S _____ T _____ R _____	
3. Miscellaneous Property in Sec.	S _____ T _____ R _____	
	S _____ T _____ R _____	

RECEIVED FOR RECORD
 95 DEC 27 PM 3:30
 PAGE 280 BK 4
 BARBARA JOHNSON
 REGISTER OF DEEDS
 MENOMINEE, MICHIGAN

Register of Deeds Stamp & File Number

4. Lot No. _____, Recorded Plat _____
 5. Private Claims
 (SAME AS E-1 T34N-R27W)

A	B	C	D	E	F	G	H	I	J	K	L	M
2	6	5	4	3	2	1						
3												
4	7	8	9	10	11	12						
5												
6	18	17	16	15	14	13						
7												
8	19	20	21	22	23	24						
9												
10	30	29	28	27	26	25						
11												
12	31	32	33	34	35	36						
13												

William Lenca
 May 5 1995
 I, _____, in a field survey on _____, 19____, do hereby certify that under requirements of P.A. 74, Michigan P.A. of 1970, the corner points mentioned in lines 1 and 2 above were in conformance with regulations and rules therefore as required in the current manual of survey instructions of the United States Department of the Interior, Bureau of Land Management or by a decree of a Court of Law and/or that the corner points mentioned in lines 3, 4 and 5, above were in conformance with the rules of the Michigan Board of Land Surveyors or by a Decree of a Court of Law; established, re-established, monumented, re-monumented, recovered, found as expressed below:

NOTE: Not more than 4 corners, all in the same town and range, may be recorded on this certificate.

- A. Description of original monument and accessories and/or subsequent restoration:
- 1847: Original Survey by Henry Floyd (Township Exterior) - B.T.'s - Spruce, 9" - N10°E - 44 lks (not evident); Fir, 10" - N80°W - 21 lks (not evident).
 - 1848: Original Survey by James H. Mullett (Section Subdivisions) - B.T.'s - Fir, 8" - S60°W - 8 lks (not evident); W. Ash, 6" - S41°W - 27 lks (not evident)

B. Description of corner evidence found and/or method applied in restoring or reestablishing corner:

In a field survey in May of 1995 we found a 1 inch diameter iron rod in line with ancient fences North and East. We also found 2 old bearing trees of unknown origin: 20" dia. Hemlock - N50°E - 38.5 feet; 24" dia. Cedar - N82°E - 26.0 feet. By the overgrowth of the blazes, these B.T.'s appear to be at least 30 years old. The corner position, as monumented by the iron rod, fits well with existing lines of occupation, has been accepted and used by local surveyors for many years, and is accepted as the best available evidence of the position of the original corner.

- C. Description of monument for corner and accessories established to perpetuate locating the position of the corner:
- Sct 2" dia. Aluminum Pipe/3-1/4" dia. Alum cap stamped for corner location in place of 1" dia. iron rod:
- | | | | |
|--------------------|-------|------------|----------|
| 5" dia. Cedar | N50°E | 15.58 feet | Scr. NBT |
| 12" dia. White Ash | S36°E | 16.60 feet | Scr. NBT |
| 9" dia. White Ash | N88°W | 24.50 feet | Scr. NBT |
| 7" dia. Maple | N18°W | 5.63 feet | Scr. NBT |
| Survey Sign Post | S25°W | 1.1 feet | |

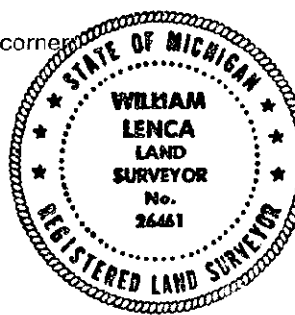

NOTE: All bearings are magnetic bearings. All distances are measured with a steel tape. Distances to trees are to nail in side of tree.

Signed by William Lenca Date Nov. 17, 1995
 Surveyor's Michigan License No. 26461

280