

SURVEY & REMONUMENTATION

FEB 11 1998

Approved by Menominee County
 Land Survey Remonumentation
 Peer Group Under Act 345 Of
 P.A. Of 1990 On 10/31 1997
Mc Davis RLS
 Chairman

SECTION

LAND CORNER RECORDATION CERTIFICATE

Filing Requirement of Act 74, Mich. P.A. 1970

For corners in

MENOMINEE (County)	Located In:	Corner Code #
1. Public Land Survey	T <u>4</u> N R <u>27</u> W	<u>F-03</u>
	T <u> </u> R <u> </u>	<u> </u>
	T <u> </u> R <u> </u>	<u> </u>
	T <u> </u> R <u> </u>	<u> </u>
2. Property Controlling in Section	S <u> </u> T <u> </u> R <u> </u>	<u> </u>
	S <u> </u> T <u> </u> R <u> </u>	<u> </u>
3. Miscellaneous Property in Sec.	S <u> </u> T <u> </u> R <u> </u>	<u> </u>
	S <u> </u> T <u> </u> R <u> </u>	<u> </u>

REGISTERED
 97 NOV 21 PM 3:29
 554 1315

Register of Deeds Stamp & File Number

4. Lot No. _____, Recorded Plat _____
 5. Private Claims _____

I, William Lenca, in a field survey on June 11, 1997 do hereby state that under requirements of P.A. 74, Michigan P.A. of 1970, the corner points mentioned in lines 1 and 2 above were in conformance with regulations and rules therefore as required in the current manual of survey instructions of the United States Department of the Interior, Bureau of Land Management or by a decree of a Court of Law and for that the corner points mentioned in lines 3, 4 and 5 above were in conformance with the rules of the Michigan Board of Land Surveyors or by a Decree of a Court of Law; established, re-established, monumented, recovered, found as expressed below:

NOTE: Not more than 2 corners, all in the same town and range, may be recorded on this certificate.

	A	B	C	D	E	F	G	H	I	J	K	L	M
1													
2	6		5					3		2		1	
3						4							
4	7		8			9		10		11		12	
5													
6	18		17			16		15		14		13	
7													
8	19		20			21		22		23		24	
9													
10	30		29			28		27		26		25	
11													
12	31		32			33		34		35		36	
13													

A. Description of original monument and accessories and/or subsequent restoration:

- 1848: Original Survey by James H. Mullett - B.T.'s - W. Pine, 12" - S63°E - 08lks.; W. Pine, 18" - S65°W - 30 lks. All original evidence for this corner has been destroyed by county road improvements.
- 1901: Plat of Survey in Section 9 T34N-R27W by Albert Hass, County Surveyor, states "set 4" cedar post from Government B.T."
- 1977: L.C.R.C. No. 158 by George B. Wilson states "dug hole 12' square with county backhoe. Found old wood post partially decayed in subsoil, 4" square. Set 4" x 36" concrete monument with 1/2" pin. TIES: Oak, 3" - S10°E - 27.4'; Oak, 3" - S30°W - 40.1'; W. Pine, 40" - N18°W - 41.3'.

B. Description of corner evidence found and/or method applied in restoring or reestablishing corner:

We recovered the remains of a broken concrete monument in position matching 3 B.T.'s described in L.C.R.C. No. 158 (see part A). The corner position falls in the centerline of county roads running north and east and in line with ancient fence line running south. Since George Wilson set his concrete monument in the same location as Albert Hass' cedar post, which was set from Original evidence, we accepted the corner as a careful and faithful perpetuation of the position of the original corner.

C. Description of monument for corner and accessories established to perpetuate locating the position of the corner:

Set 2" dia. Aluminum Pipe/3-1/4" dia. Alum cap stamped for corner location:

14" dia. Norway	N45°E	65.87 feet	Scr. NBT
6" dia. White Pine	S67°E	65.73 feet	Scr. NBT
6" dia. Oak	S30°W	40.29 feet	Scr. NBT
9" dia. White Pine	N30°W	54.31 feet	Scr. NBT
Metal Survey Sign Post	South	35.3 feet	

NOTE: All bearings are magnetic bearings. All distances are measured with steel tape. Distances to trees are to nail in side of tree.

Signed by William Lenca Date Oct. 07, 1997
 Surveyor's Michigan License No. 26461

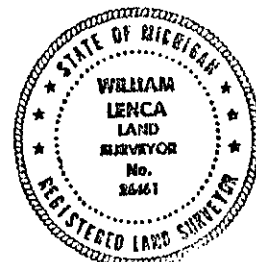

554