

# SURVEY & REMONUMENTATION

FEB 11 1998

Approved by Menominee County  
Land Survey Remonumentation  
Peer Group Under Act 345 Of  
P.A. Of 1990 On 10/31 199 7  
Mc Davis RLS  
Chairman

## LAND CORNER RECORDATION CERTIFICATE Filing Requirement of Act 74, Mich. P.A. 1970

### SECTION

MENOMINEE (County)	Located In:	Corner Code #
1. Public Land Survey	T34N R 27W	E-07
	T R	
	T R	
	T R	
2. Property Controlling in Section	S T R	
	S T R	
3. Miscellaneous Property in Sec.	S T R	
	S T R	

REGISTERED FOR RECORD  
97 NOV 21 PM 3:20  
556, BK 5

Register of Deeds Stamp & File Number

4. Lot No. \_\_\_\_\_, Recorded Plat \_\_\_\_\_  
5. Private Claims \_\_\_\_\_

I, William Lenca, in a field survey on June 11, 19 97 do hereby state that under requirements of P.A. 74, Michigan P.A. of 1970, the corner points mentioned in lines 1 and 2 above were in conformance with regulations and rules therefore as required in the current manual of survey instructions of the United States Department of the Interior, Bureau of Land Management or by a decree of a Court of Law and/or that the corner points mentioned in lines 3, 4 and 5 above were in conformance with the rules of the Michigan Board of Land Surveyors or by a Decree of a Court of Law; established, re-established, monumented, recovered, found as expressed below:

NOTE: Not more than 2 corners, all in the same town and range, may be recorded on this certificate.

	A	B	C	D	E	F	G	H	I	J	K	L	M
1													
2	6		5		4		3		2		1		
3													
4	7		8		9		10		11		12		
5													
6	18		17		16		15		14		13		
7													
8	19		20		21		22		23		24		
9													
10	30		29		28		27		26		25		
11													
12	31		32		33		34		35		36		
13													

A. Description of original monument and accessories and/or subsequent restoration:

- 1848: Original Survey by James H. Mullett - B.T.'s - Y. Pine, 20" - S37°E - 37lks.; Y. Pine, 18" - N73°W - 23 lks. All original evidence for this corner has been destroyed by county road improvements.
- 1928: Plat of SCHUETTE SUMMER RESORT recorded by A.L. Hillis states in the Surveyor's Certificate that a 1" dia. iron rod encased in a concrete cylinder at least 4" in dia. was set in this location.
- 1971: Certified Survey No. 6 by George B. Wilson, RLS 17607, shows a 6" square concrete monument existing at the time of his survey. TIES: Corner concrete block house foundation - 128.35'; Center of well casing S.W. - 123.43'; Telephone Box - South - 36.00'; Telephone Box, nail in post - 70.75'.

B. Description of corner evidence found and/or method applied in restoring or reestablishing corner:

In a 1987 survey in Section 21, T34N-R27W, I recovered a broken concrete monument and ties as described in Certified Survey No. 6. I replaced the broken monument with a 4" diameter x 30" long Bernsten Monument known as a W-1-B. In June of 1997 we found the W-1-B Monument with the top broken off in location matching that used in Certified Survey No. 6 and Schuette Summer Resort. We accepted the location of the existing monument as the best available evidence of the position of the original corner.

C. Description of monument for corner and accessories established to perpetuate locating the position of the corner:

Set 5/8" x 24" Iron Rod/3-1/4" dia. Alum. cap stamped for corner location in Monument Box:

16" dia. White Pine	S37°W	39.13 feet	
18" dia. White Pine	S66°E	99.09 feet	Scr. NBT
16" dia. Norway	N47°E	100.75 feet	
10" dia. White Pine	N17°W	74.06 feet	Scr. NBT
Metal Survey Sign Post	East	64.9 feet	

NOTE: All bearings are magnetic bearings. All distances are measured with steel tape. Distances to trees are to nail in side of tree.

Signed by William Lenca Date Oct. 13, 1997  
Surveyor's Michigan License No. 26461

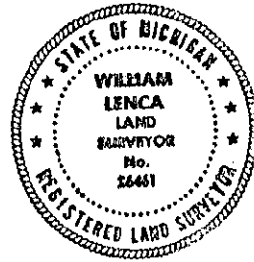

556