

SURVEY & REMONUMENTATION

JUN 23 1994

COMMISSION

LAND CORNER RECORDATION CERTIFICATE Filing Requirement of Act 74, Mich. P.A. 1970

Approved by Menominee County
Land Survey Remonumentation
Peer Group Under Act 345 Of
P.A. Of 1990 On 5/18, 1994
Mr. Davis
Chairman

For corners in
MENOMINEE

(County)

Located in:

Corner Code #

1. Public Land Survey	T <u>34N</u> R <u>27W</u>	F-11	
	T _____ R _____		
	T _____ R _____		
	T _____ R _____		
2. Property Controlling in Section	S _____ T _____ R _____		
	S _____ T _____ R _____		
3. Miscellaneous Property in Sec.	S _____ T _____ R _____		
	S _____ T _____ R _____		

RECEIVED FOR RECORD
94 MAY 20 PM 3:31
PAGE # 68 BK. 4
BARBARA MORRISON
REGISTER OF DEEDS
MENOMINEE, MI 49858
Register of Deeds Stamp & File Number

4. Lot No. _____, Recorded Plat _____
5. Private Claims _____

I, William Lenca, in a field survey on March 23, 1994, do hereby certify that under requirements of P.A. 74, Michigan P.A. of 1970, the corner points mentioned in lines 1 and 2 above were in conformance with regulations and rules therofore as required in the current manual of survey instructions of the United States Department of the Interior, Bureau of Land Management or by a decree of a Court of Law and/or that the corner points mentioned in lines 3, 4 and 5 above were in conformance with the rules of the Michigan Board of Land Surveyors or by a Decree of a Court of Law; established, re-established, monumented, re-monumented, recovered, found as expressed below:

A	B	C	D	E	F	G	H	I	J	K	L	M
2	6	5	4	3	2	1						
3												
4	7	8	9	10	11	12						
5												
6	18	17	16	15	14	13						
7												
8	19	20	21	22	23	24						
9												
10	30	29	28	27	26	25						
11												
12	31	32	33	34	35	36						
13												

NOTE: Not more than 4 corners, all in the same town and range, may be recorded on this certificate.

A. Description of original monument and accessories and/or subsequent restoration:

ORIGINAL B.T.'s: Maple, 6", N01°W, 06 lks
Maple, 10", S11°W, 25 lks

Original Survey by James H. Mullett in 1848. All original evidence for this corner has been destroyed by County Road improvements.

PERPETUATION: 1980 - LCRC No. 244 recorded by George B. Wilson indicates he found an iron fence post set by Robert Olson, RLS 10700 - Witnesses: 3" Cedar, S70°E, 25.60'; 4" Hemlock, S60°E, 25.90'; 7.20 feet North of Fenceline East; 12.80 feet East of Road centerline.

B. Description of corner evidence found and/or method applied in restoring or reestablishing corner:

Found an Iron Fence Post in position indicated by LCRC No. 244. The corner was identified by reference to the fence line East and the centerline of the county road. Both of Wilson's B.T.'s are gone. The corner position falls in line with the extension south of the county road centerline to the north. This corner location has been used for control by local surveyors for at least 20 years, and is accepted as the best available evidence for the position of the original corner.

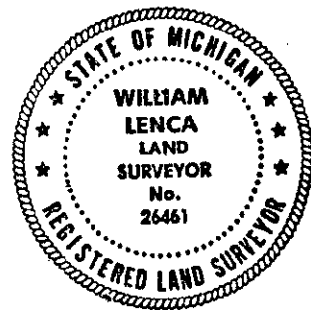

C. Description of monument for corner and accessories established to perpetuate locating the position of the corner:
Set 5/8" x 24" Iron Rod/3-1/4" dia. Alum. cap stamped for Corner location:

12" dia. Maple	Scr. NBT	N24°E	59.42 feet
8" dia. Cedar	" "	S47°E	57.68 feet
10" dia. Maple	" "	S43°W	69.33 feet
16" dia. Cedar	" "	N72°W	46.04 feet
Survey Sign Post		East	14.0 feet

NOTE: All bearings are magnetic bearings. All distances are measured with steel tape. Distances to trees are to nail in side of tree.

Signed by William Lenca Date April 22, 1994
Surveyor's Michigan License No. 26461