

Approved by Menominee County
 Land Survey Remonumentation
 Peer Group Under Act 345 Of
 P.A. of 1990 On 12/21, 1996
Wm. Lenca RLS
 Chairman

LAND CORNER RECORDATION CERTIFICATE
 Filing Requirement of Act 74, Mich. P.A. 1970

For corners in
MENOMINEE
 (County)

Located In: Corner Code #

1. Public Land Survey T34N R 27W G09
 T R
 T R
 T R

2. Property Controlling
 in Section S T R
 S T R

3. Miscellaneous
 Property in Sec. S T R
 S T R

REGISTERED FOR RECORD
 96 DEC 30 11 50 AM
 466 8K 5
 Register of Deeds Stamp & File Number

4. Lot No. _____, Recorded Plat _____
 5. Private Claims _____

I, William Lenca, in a field survey on May 23, 1996 do hereby state that under requirements of P.A. 74, Michigan P.A. of 1970, the corner points mentioned in lines 1 and 2 above were in conformance with regulations and rules therefore as required in the current manual of survey instructions of the United States Department of the Interior, Bureau of Land Management or by a decree of a Court of Law and /or that the corner points mentioned in lines 3, 4 and 5 above were in conformance with the rules of the Michigan Board of Land Surveyors or by a Decree of a Court of Law; established, re-established, monumented, recovered, found as expressed below.

NOTE: Not more than 2 corners, all in the same town and range, may be recorded on this certificate.

	A	B	C	D	E	F	G	H	I	J	K	L	M
1													
2		6		5		4		3		2		1	
3													
4		7		8		9		10		11		12	
5													
6		10		17		16		15		14		13	
7													
8		19		20		21		22		23		24	
9													
10		30		29		28		27		26		25	
11													
12		31		32		33		34		35		36	
13													

- A. Description of original monument and accessories and/or subsequent restoration:
- 1848: Original Survey by James H. Mullett - B.T.'s -Y. Pinc, 14" - N79°W - 14 lks.; Y. Pinc, 10" - N33°E - 12 lks. Original corner evidence was destroyed by farming activities.
 - 1977: L.C.R.C. No. 174 by George B. Wilson, RLS No. 17607, states: "Nothing left of original B.T.'s. Re-set at intersection of old fence corner." Set 4" square concrete monument 30" long/1/2" dia. iron pin in center. No new B.T.'s are given. Sketch on back side of form shows this corner as it relates to other corners in Section 22, T34N-R27W.
 - 1980: L.C.R.C. No. 245 by George B. Wilson, RLS No. 17607, has a sketch on the back of the form showing this corner as it relates to other corners in Section 28, T34N-R27W. The corner is described as "Found conc. monument".

B. Description of corner evidence found and/or method applied in restoring or reestablishing corner:

We recovered a 4" diameter concrete monument with 1/2 inch diameter iron rod at an ancient fence corner - fences run North - East and West from this location. This corner fits with measurements to corners North and East as shown on the back of form L.C.R.C. No. 174, and also fits well with measurements to corners South and West as shown on the back of L.C.R.C. No. 245, and is accepted as the best available evidence of the position of the original corner.

C. Description of monument for corner and accessories established to perpetuate locating the position of the corner.
 Accepted existing 4" dia. concrete monument/1/2" iron pin in center/set 3-1/4" dia. Alum. cap stamped for corner

8" dia. Jack Pine	N42°E	9.30 feet	Scr. NBT
14" dia. Norway Pine	S44°E	63.40 feet	Scr. NBT
12" dia. Norway Pine	S40°W	33.99 feet	Scr. NBT
Metal Survey Sign Post	West	1.3 feet	
Nothing else nearby			

NOTE: All bearings are magnetic bearings. All distances are measured with EDM. Distances to trees are to nail in side of tree.

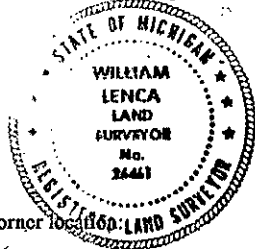

Signed by William Lenca Date Dec. 23, 1996
 Surveyor's Michigan License No. 26461

466