

SURVEY & REMONUMENTATION

FEB 11 1998

Approved by Menominee County
Land Survey Remonumentation
Peer Group Under Act 345 Of
P.A. Of 1990 On 12/18 1997
Mc Davis RLS
Chairman

SECTION

LAND CORNER RECORDATION CERTIFICATE Filing Requirement of Act 74, Mich. P.A. 1970

For corners in
MENOMINEE

(County)	Located In:	Corner Code #
1. Public Land Survey	T <u>34N</u> R <u>27W</u>	H-07
	T _____ R _____	_____
	T _____ R _____	_____
	T _____ R _____	_____
2. Property Controlling in Section	S _____ T _____ R _____	_____
	S _____ T _____ R _____	_____
3. Miscellaneous Property in Sec.	S _____ T _____ R _____	_____
	S _____ T _____ R _____	_____

97 DEC 22 11 11:27
REGISTER OF DEEDS
MENOMINEE COUNTY
MICHIGAN

Register of Deeds Stamp & File Number

4. Lot No. _____, Recorded Plat _____
5. Private Claims _____

I, William Lenca, in a field survey on Dec. 02, 1997 do hereby state that under requirements of P.A. 74, Michigan P.A. of 1970, the corner points mentioned in lines 1 and 2 above were in conformance with regulations and rules therefore as required in the current manual of survey instructions of the United States Department of the Interior, Bureau of Land Management or by a decree of a Court of Law and /or that the corner points mentioned in lines 3, 4 and 5 above were in conformance with the rules of the Michigan Board of Land Surveyors or by a Decree of a Court of Law; established, re-established, monumented, recovered, found as expressed below:

	A	B	C	D	E	F	G	H	I	J	K	L	M
1													
2	6	5	4	3	2	1							
3													
4	7	8	9	10	11	12							
5													
6	8	17	16	15	14	13							
7													
8	19	20	21	22	23	24							
9													
10	30	29	28	27	26	25							
11													
12	31	32	33	34	35	36							
13													

NOTE: Not more than 2 corners, all in the same town and range, may be recorded on this certificate.

A. Description of original monument and accessories and/or subsequent restoration:

- 1848: Original Survey by James H. Mullett - B.T.'s - W. Pine, 4" - S06.5°W - 11 lks.; Birch, 8" - S45°E - 17 lks. All original evidence for this corner has been destroyed by logging activities.
- 1900: Albert Hass's survey of Section 22 shows he set a 4" cedar post from Government B.T. No evidence of this corner was recovered due to logging activities.
- 1975: Plat of Survey by George B. Wilson, RLS No. 17607, shows this corner in relation to other corners in the N1/2 of Section 22 - Wilson's distances match with those shown in Albert Hass Survey from 1900.
- 1976: Certified Survey Number 56 by George B. Wilson, RLS No. 17607, shows this corner in relation to other corners in Section 15, T34N-R27W.

B. Description of corner evidence found and/or method applied in restoring or reestablishing corner:

After computing the location of this corner based on George Wilson's surveys in Section 15 and 22, we traversed in to it and searched the area but found no evidence of the original corner accessories, or evidence of subsequent restoration. This location matches well with a G.L.O. Terrain Call to the east. There is remnants of an old fence nailed to trees which is approximately 5 feet North of the corner position. This position fits very closely with Albert Hass' Survey, has been used by local surveyors for more than 20 years, and is accepted as the best available evidence of the position of the original corner.

C. Description of monument for corner and accessories established to perpetuate locating the position of the corner:

Sct 2" dia. Aluminum Pipe/3-1/4" dia. Alum cap stamped for corner location:

9" dia. Norway Pine	N03°W	63.14 feet	Scr. NBT
12" dia. Oak	N80°E	43.77 feet	Scr. NBT
14" dia. Norway Pine	S14°E	35.77 feet	Scr. NBT
14" dia. Maple	S71°W	19.02 feet	Scr. NBT
Metal Survey Sign Post	South	1.0 feet	

NOTE: All bearings are magnetic bearings. All distances are measured with steel tape. Distances to trees are to nail in side of tree.

Signed by William Lenca
Surveyor's Michigan License No. 26461

Date Dec. 09, 1997

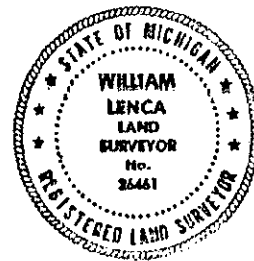

582