

Mike Davis RLS
Chairman

LAND CORNER RECORDATION CERTIFICATE
Filing Requirement of Act 74, Mich. P.A. 1970

For corners in

<u>MENOMINEE</u> (County)	Located In:	Corner Code #
1. Public Land Survey	T <u>34</u> N R <u>27</u> W	<u>103</u>
	T _____ R _____	_____
	T _____ R _____	_____
	T _____ R _____	_____
2. Property Controlling in Section	S _____ T _____ R _____	_____
	S _____ T _____ R _____	_____
3. Miscellaneous Property in Sec.	S _____ T _____ R _____	_____
	S _____ T _____ R _____	_____

RECEIVED FOR RECORD
96 OCT -7 PM 3:25
PAGE # 348 BK 4
BARBARA JOHNSON
REGISTER OF DEEDS
11/15/95

Register of Deeds Stamp & File Number

4. Lot No. _____, Recorded Plat _____
5. Private Claims _____

I, William Lenca, in a field survey on Mar. 14, 19 96 do hereby state that under requirements of P.A. 74, Michigan P.A. of 1970, the corner points mentioned in lines 1 and 2 above were in conformance with regulations and rules therefore as required in the current manual of survey instructions of the United States Department of the Interior, Bureau of Land Management or by a decree of a Court of Law and/or that the corner points mentioned in lines 3, 4 and 5 above were in conformance with the rules of the Michigan Board of Land Surveyors or by a Decree of a Court of Law; established, re-established, monumented, recovered, found as expressed below:

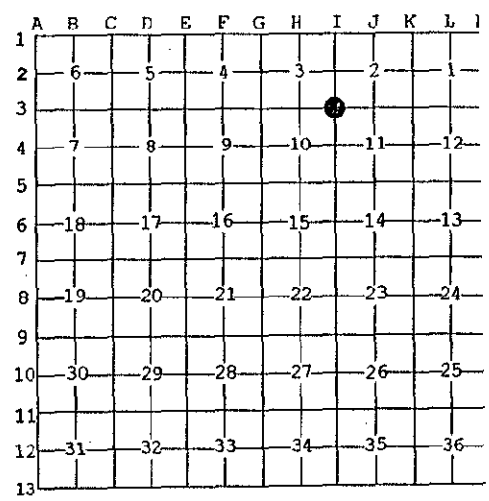

NOTE: Not more than 2 corners, all in the same town and range, may be recorded on this certificate.

- A. Description of original monument and accessories and/or subsequent restoration:
- 1848: Original Survey by James H. Mullett - B.T.'s - Beech, 12" - N54°E - 36 lks.; Beech, 12" - S18°W - 30 lks. All original evidence for this corner has been destroyed by Highway construction.
 - 1964: MDOT Highway Plans note this corner as being a 3/4" dia. Iron Pipe at Station 633+00, 24.5 feet W. of centerline - TIES: 18" dia. Poplar - N35°W - 61.48' (gone); T. Pole - N15°W - 56.15' (gone); T. Pole - S05°W - 65.90' (gone).
 - 1981: CERTIFIED SURVEY NO. 224 by George B. Wilson, RLS No. 17607, shows this corner as it relates to other corners in Section 3, T34N-R27W.
 - 1991: L.C.R.C No. 918 by Brian R. Taavola, RLS No. 21583, states "Found: 4" Alum. Monument, 24.3 feet West of US-41 C/L & 13.5 feet South of Wildwood Rd. East C/L. MDOT Sta. 800+05. TIES: 10" Twin Poplar - S80°W - 18.68 feet; Tel. Pole - N07°W - 58.18'; Tel. Pole - S10°W - 65.88'; Face of R/W Marker @ top of R - S73°E - 76.84'.

B. Description of corner evidence found and/or method applied in restoring or reestablishing corner:

We found a 4" diameter Aluminum Monument and 4 ties as described in L.C.R.C. No. 918 (see part A). The position of this monument matches measurements shown in Certified Survey No. 224, and is typical of the type of monuments set by George B. Wilson. The corner position also matches closely with ties between stationing as shown on the 1964 Highway Plans for U.S. Highway 41. Said plans show the SE Corner of Section 10 at Station 579+56.4 and the NE Corner at Station 633+00, or a distance of 5343.6 feet. We measured the distance between these corners as 5345.50 feet. The 1964 Highway plans state that an existing 3/4" diameter iron pipe was found 24.5 feet West of centerline. The existing monument is 24.3 feet West of centerline. We therefore assumed that the existing aluminum monument was put in place of the 3/4" diameter iron pipe, and was accepted as the best available evidence of the position of the original corner.

- C. Description of monument for corner and accessories established to perpetuate locating the position of the corner:
- Accepted existing 4" diameter Aluminum Monument stamped for corner location:
- | | | | |
|---|-------|------------|-------------------|
| 5/8" x 24" Iron Rod/2" dia. Alum. cap marked "WITNESS MARKER" | N13°W | 56.76 feet | 1' S. of P.P. |
| 5/8" x 24" Iron Rod/2" dia. Alum. cap marked "WITNESS MARKER" | N55°E | 96.37 feet | 1' NW of P.P. |
| 5/8" x 24" Iron Rod/2" dia. Alum. cap marked "WITNESS MARKER" | S76°E | 79.17 feet | 1' SW of P.P. |
| 5/8" x 24" Iron Rod/2" dia. Alum. cap marked "WITNESS MARKER" | S36°E | 47.53 feet | 1' E. of Fc. Post |
| Metal Survey Sign Post | S82°W | 21.8 feet | |

NOTE: All bearings are magnetic bearings. All distances are measured with EDM. Distances to trees are to nail on side of tree.

Signed by William Lenca Date Mar. 26, 1996
Surveyor's Michigan License No. 26461

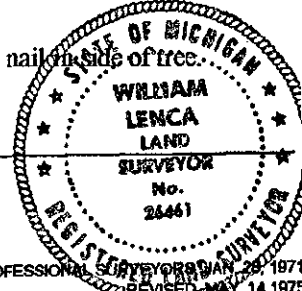

348