

# SURVEY & REMONUMENTATION

FEB 11 1998

Approved by Menominee County  
Land Survey Remonumentation  
Peer Group Under Act 345 Of  
P.A. Of 1996 On 12/18 1997  
*Mike Davis RLS*  
Chairman

## SECTION

## LAND CORNER RECORDATION CERTIFICATE

Filing Requirement of Act 74, Mich. P.A. 1970

For corners in  
MENOMINEE  
(County)

	Located in:	Corner Code #
1. Public Land Survey	T <u>34</u> N R <u>27</u> W	I-07
	T ___ R ___	_____
	T ___ R ___	_____
	T ___ R ___	_____
2. Property Controlling in Section	S ___ T ___ R ___	_____
	S ___ T ___ R ___	_____
3. Miscellaneous Property in Sec.	S ___ T ___ R ___	_____
	S ___ T ___ R ___	_____

REGISTERED FOR RECORD

97 DEC 22 PM 11:27

PAGE 583 BK 5

REGISTERED FOR RECORD

Register of Deeds Stamp & File Number

4. Lot No. \_\_\_\_\_, Recorded Plat \_\_\_\_\_  
5. Private Claims \_\_\_\_\_

I, William Lenca, in a field survey on Dec. 02, 1997 do hereby state that under requirements of P.A. 74, Michigan P.A. of 1970, the corner points mentioned in lines 1 and 2 above were in conformance with regulations and rules therefore as required in the current manual of survey instructions of the United States Department of the Interior, Bureau of Land Management or by a decree of a Court of Law and/or that the corner points mentioned in lines 3, 4 and 5 above were in conformance with the rules of the Michigan Board of Land Surveyors or by a Decree of a Court of Law; established, re-established, monumented, recovered, found as expressed below:

1	A	B	C	D	E	F	G	H	I	J	K	L	M
2		6	5			4		3		2		1	
3													
4		7		8		9		10		11		12	
5													
6		18		17		16		15		14		13	
7									●				
8		19		20		21		22		23		24	
9													
10		30		29		28		27		26		25	
11													
12		31		32		33		34		35		36	
13													

NOTE: Not more than 2 corners, all in the same town and range, may be recorded on this certificate.

**A. Description of original monument and accessories and/or subsequent restoration:**

- 1848: Original Survey by James H. Mullett - B.T.'s - Birch, 10" - N23°W - 34 lks.; Birch, 6" - S56°E - 10 lks. All original evidence for this corner has been destroyed by U.S. 41 road construction.
- 1924: SUPERVISOR'S PLAT OF WALLACE by A.L. Hillis shows this corner as the Point of Beginning of the Plat and describes the corner monument in the Surveyor's Certificate as a 1/2" dia. x 16" iron rod.
- 1991: L.C.R.C. No. 919 by Brian R. Taavola states, "1/2 Inch Copper Clad steel rod with yellow plastic cap embossed "MDOT 21583" set inside of a monument box. 0.6 FT East of C/L Existing US Highway 41." TIES: Power Pole (nail & tag) - S40°E - 58.38'; S.W. Cor. of Garage Fndtn. - N65°E - 116.12'; Face of ROW Marker @ Ground - West - 50.67'; Street Light Pole - S55°W - 58.03'.

**B. Description of corner evidence found and/or method applied in restoring or reestablishing corner:**

We found an existing Monument Box with a 1/2" diameter Iron Rod with identification cap marked "MDOT 21583" in a position as described in Land Corner Recordation Certificate Number 919 by Brian R. Taavola. This position fits well with monumentation found in SUPERVISOR'S PLAT OF WALLACE by A.L. Hillis in 1924 and SUPERVISOR'S PLAT OF WALLACE NO. 1 by A.L. Hillis in 1939, and is accepted as the best available evidence of the position of the original corner.

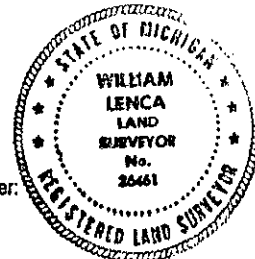

**C. Description of monument for corner and accessories established to perpetuate locating the position of the corner:**

Accepted existing 1/2" dia. Iron Rod inside Monument Box for corner location:

5/8" x 24" Iron Rod/2" dia. Alum. cap marked "WITNESS MARKER" 1.0' N. of Road Sign	N68°E	47.86 feet
5/8" x 24" Iron Rod/2" dia. Alum. cap marked "WITNESS MARKER" 3.0' S. of P.P.	S43°E	62.50 feet
5/8" x 24" Iron Rod/2" dia. Alum. cap marked "WITNESS MARKER" 1.0' N. of P.P.	S58°W	57.27 feet
5/8" x 24" Iron Rod/2" dia. Alum. cap marked "WITNESS MARKER" 1.0' E. of Tel. Box	N54°W	61.92 feet
Metal Survey Sign Post	S43°E	63.0 feet

NOTE: All bearings are magnetic bearings. All distances are measured with EDM. Distances to trees are to nail in side of tree.

Signed by *William Lenca*  
Surveyor's Michigan License No. 26461

Date Dec. 15, 1997

583