

APR 06 1999

P.A. Of 1990 On 10/29 1998
Terence J. Wynn P.S.
Chairman

SECTION

LAND CORNER RECORDATION CERTIFICATE
Filing Requirement of Act 74, Mich. P.A. 1970.

For corners in

MENOMINEE (County)	Located In:	Corner Code #
1. Public Land Survey	T 34N R 27W	1-01
	T R	
	T R	
	T R	
2. Property Controlling in Section	S T R	
	S T R	
3. Miscellaneous Property in Sec.	S T R	
	S T R	

RECEIVED FOR RECORD
98 DEC 14 PM 3:20
PAGE # 662 BK 5
BARBARA MORRISON
REGISTER OF DEEDS
MENOMINEE, MI 49858
Register of Deeds Stamp & File Number

4. Lot No. _____, Recorded Plat _____

5. Private Claims _____

(SAME AS CORNER J-13, T35N-R27W)

I, William Lenca, in a field survey on May 20, 19 98 do hereby state that under requirements of P.A. 74, Michigan P.A. of 1970, the corner points mentioned in lines 1 and 2 above were in conformance with regulations and rules therefore as required in the current manual of survey instructions of the United States Department of the Interior, Bureau of Land Management or by a decree of a Court of Law and /or that the corner points mentioned in lines 3, 4 and 5 above were in conformance with the rules of the Michigan Board of Land Surveyors or by a Decree of a Court of Law; established, re-established, monumented, recovered, found as expressed below:

NOTE: Not more than 2 corners, all in the same town and range, may be recorded on this certificate.

	A	B	C	D	E	F	G	H	I	J	K	L	M
1													
2	6			5		4		3		2		1	
3													
4	7			8		9		10		11		12	
5													
6	18			17		16		15		14		13	
7													
8	19			20		21		22		23		24	
9													
10	30			29		28		27		26		25	
11													
12	31			32		33		34		35		36	
13													

A. Description of original monument and accessories and/or subsequent restoration:

- 1847: Original Survey by H. Floyd - B.T.'s - Hemlock, 24" - N25°E - 37 lks.; Hemlock, 18" - N30°W - 21 lks. All original evidence for this corner has been destroyed by county road improvements.
- 1965: Plat of Survey by Robert Olsen shows a tie to this corner.
- 1989: Certified Survey Number 669 by William Lenca shows this corner in his subdivision of Section 35, T35N-R27W.

B. Description of corner evidence found and/or method applied in restoring or reestablishing corner:

My Field Notes from a 1988 survey of Section 35, T35N-R27W state: Set P.K. in centerline of county road East and West and in line with an old fence to the South. TIES: Elm, 12" - N05°E - 107.10'; Power Pole - S79°E - 141.65'; Power Pole - S28°E - 33.02'. In our 1998 remonumentation survey, we found a P.K. nail in the centerline of an East - West county road and in line with old fences North - South. We also recovered the 3 witnesses described above. This position has been used in other surveys, fits existing lines of occupation, and is accepted as the best available evidence of the position of the original corner.

C. Description of monument for corner and accessories established to perpetuate locating the position of the corner:

- Set 5/8" x 24" Iron Rod/3-1/4" dia. Alum. cap stamped for corner location in Monument Box:
- | | | | |
|---|-------|-------------|-----------------------|
| 5/8" x 24" Iron Rod/2" dia. Alum. cap marked "WITNESS MARKER" | North | 42.17 feet | @ Sign Post |
| 5/8" x 24" Iron Rod/2" dia. Alum. cap marked "WITNESS MARKER" | S76°E | 140.19 feet | 1' W. of Power Pole |
| 5" dia. Cedar | South | 38.08 feet | Scr. NBT |
| 5/8" x 24" Iron Rod/2" dia. Alum. cap marked "WITNESS MARKER" | N52°W | 75.11 feet | 4' E. of 3" W. Spruce |
| Metal Survey Sign Post | North | 42.6 feet | |

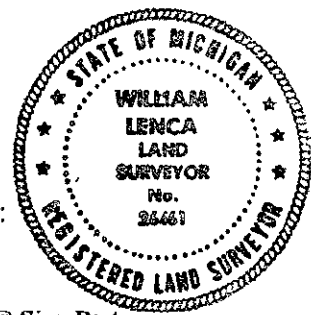

NOTE: All bearings are magnetic bearings. All distances are measured with steel tape. Distances to trees are to nail in side of tree.

Signed by William Lenca
Surveyor's Michigan License No. 26461

Date Oct. 13, 1998