

# SURVEY & REMONUMENTATION

FEB 11 1998

Approved by Menominee County  
 Land Survey Remonumentation  
 Peer Group Under Act 345 Of  
 P.A. Of 1990 On 12/13, 1997  
Mr. Davis RUS  
 Chairman

## LAND CORNER RECORDATION CERTIFICATE Filing Requirement of Act 74, Mich. P.A. 1970

**SECTION**  
 in  
MENOMINEE  
 (County)

Located In:	Corner Code #
T <u>34</u> N R <u>27</u> W	J-05
T ___ R ___	_____
T ___ R ___	_____
T ___ R ___	_____
T ___ R ___	_____
S ___ T ___ R ___	_____
S ___ T ___ R ___	_____
S ___ T ___ R ___	_____
S ___ T ___ R ___	_____

97 DEC 22 AM 11:27  
 RECEIVED FOR RECORD  
 REGISTER OF DEEDS  
 590, 2K5  
 REGISTER OF DEEDS STAMP & FILE NUMBER

4. Lot No. \_\_\_\_\_, Recorded Plat \_\_\_\_\_  
 5. Private Claims \_\_\_\_\_

I, William Lenca, in a field survey on Aug. 06, 1997 do hereby state that under requirements of P.A. 74, Michigan P.A. of 1970, the corner points mentioned in lines 1 and 2 above were in conformance with regulations and rules therefore as required in the current manual of survey instructions of the United States Department of the Interior, Bureau of Land Management or by a decree of a Court of Law and/or that the corner points mentioned in lines 3, 4 and 5 above were in conformance with the rules of the Michigan Board of Land Surveyors or by a Decree of a Court of Law; established, re-established, monumented, recovered, found as expressed below:

NOTE: Not more than 2 corners, all in the same town and range, may be recorded on this certificate.

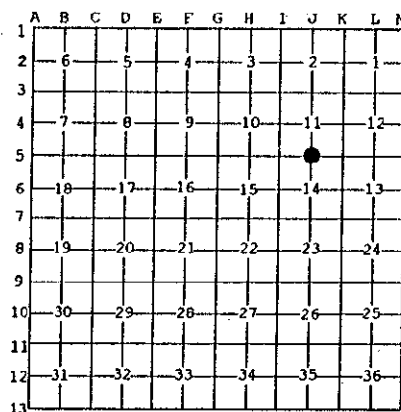

**A. Description of original monument and accessories and/or subsequent restoration:**

- 1848: Original Survey by James H. Mullett - B.T.'s - Beech, 12" - S62°W - 13 lks.; Beech, 4" - N80°W - 09 lks. All original evidence for this corner has been destroyed by county road improvements.
- 1987: L.C.R.C. No. 770, Book 3 recorded by William Lenca, RLS 26461, states "set Railroad Spike at intersection of C.R. c/l's N - S and E - W." B.T.'s - Apple, 16" - S57°E - 64.95'; Power Pole - S47°W - 45.14'; Anchor Pole - N37°W - 43.73'.

**B. Description of corner evidence found and/or method applied in restoring or reestablishing corner:**

We recovered a railroad spike 4" below the road surface in centerline of county roads north, south, east, and west. We also recovered 3 witnesses as described in part "A" above. This position fits well with other corners in the area, has been used by local surveyors for several years, and is accepted as the best available evidence of the position of the original corner.

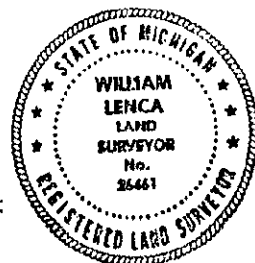

**C. Description of monument for corner and accessories established to perpetuate locating the position of the corner:**

Set 5/8" x 24" Iron Rod/3-1/4" dia. Alum. cap stamped for corner location in Monument Box:

5/8" x 24" Iron Rod/2" dia. Alum. cap marked "WITNESS MARKER"	N47°E	49.62 feet
20" dia. Apple	S57°E	64.63 feet
5/8" x 24" Iron Rod/2" dia. Alum. cap marked "WITNESS MARKER" 0.5' N.E. of P.P.	S47°W	44.08 feet
5/8" x 24" Iron Rod/2" dia. Alum. cap marked "WITNESS MARKER" 1.5' S. of P.P.	N41°W	42.39 feet
Survey Sign Post	N47°E	51.6 feet

NOTE: All bearings are magnetic bearings. All distances are measured with steel tape. Distances to trees are to nail in side of tree.

Signed by William Lenca  
 Surveyor's Michigan License No. 26461

Date Oct. 31, 1997